

HOPSCA

城市综合体

高巍 编 常文心 译

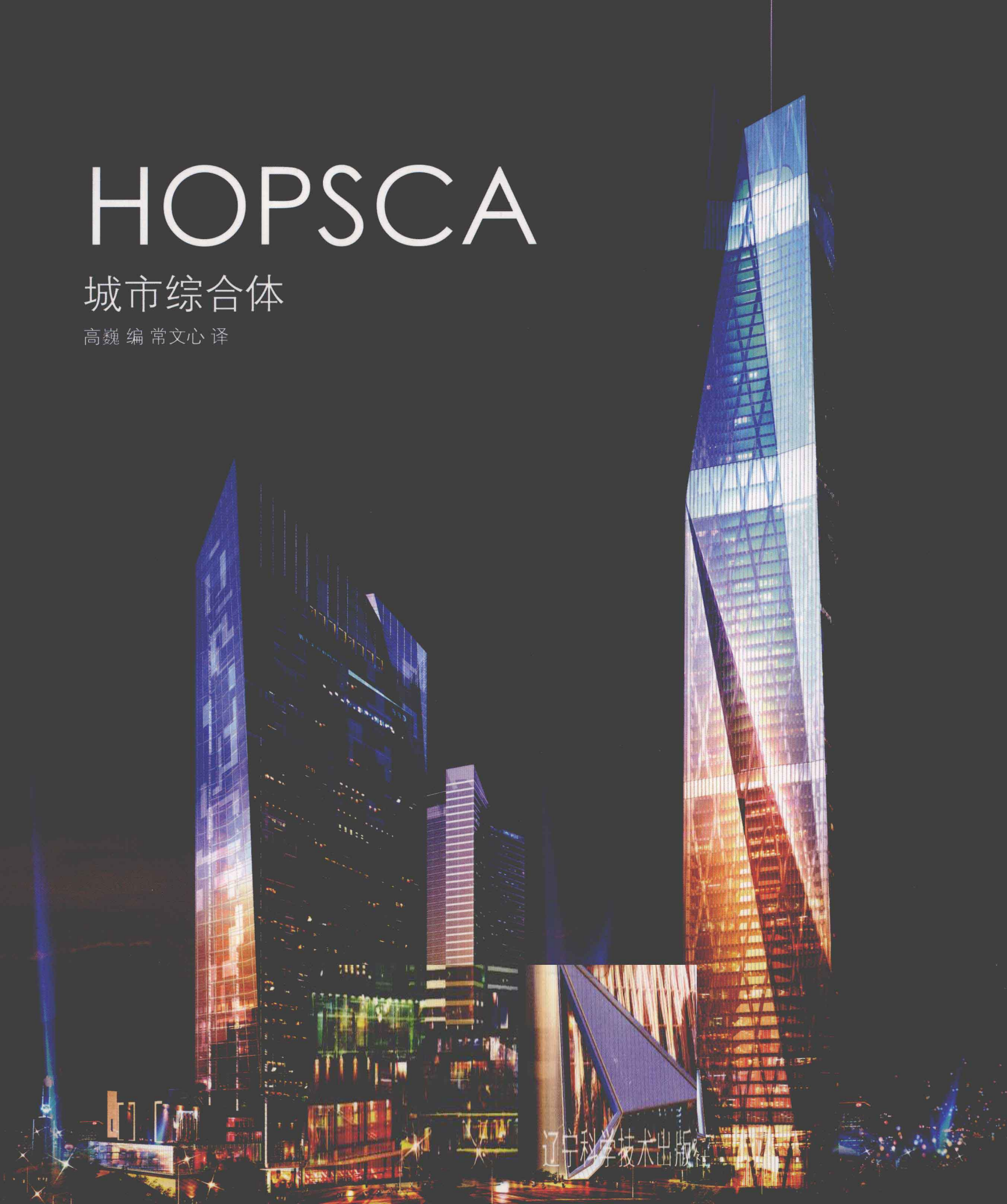

辽宁科学技术出版社

HOPSCA

城市综合体

高巍 编 常文心 译

辽宁科学技术出版社

图书在版编目 (C I P) 数据

城市综合体 / 高巍编 ; 常文心译. --沈阳: 辽宁
科学技术出版社, 2011.3
ISBN 978-7-5381-6582-1

I. ①城… II. ①高… ②常… III. ①城市建筑—建
筑设计—作品集—世界—现代 IV. ①TU984

中国版本图书馆CIP数据核字 (2011) 第004465号

出版发行: 辽宁科学技术出版社

(地址: 沈阳市和平区十一纬路29号 邮编: 110003)

印 刷 者: 利丰雅高印刷 (深圳) 有限公司

经 销 者: 各地新华书店

幅面尺寸: 240mm × 280mm

印 张: 34

插 页: 4

字 数: 50千字

印 数: 1~2000

出版时间: 2011年 3月第 1 版

印刷时间: 2011年 3月第 1 次印刷

责任编辑: 陈慈良

封面设计: 李 宁

版式设计: 李 宁

责任校对: 周 文

书 号: ISBN 978-7-5381-6582-1

定 价: 228.00元

联系电话: 024-23284360

邮购热线: 024-23284502

E-mail: lnkjc@126.com

<http://www.lnkj.com.cn>

本书网址: www.lnkj.cn/uri.sh/6582

HOPSCA

城市综合体

Contents

目 录

- 6 **Shanghai ICC**
上海ICC
- 14 **Asan Baebang Mixed-Use Complex – Second Place**
牙山城市综合体二等奖
- 20 **Wilson Town City Centre**
威尔逊市中心规划
- 26 **Cumulus**
积云大厦
- 36 **International Business Centre Zhi Yuan**
植园国际商务中心
- 42 **Urban Oasis**
城市绿洲
- 48 **XERO Project**
XERO项目
- 54 **Draga-Šibenik**
德加拉-希贝尼克
- 60 **Portal to Gijón**
希洪门户
- 66 **Magma Towers**
岩浆塔
- 72 **Puerta del Sol Towers**
太阳门塔
- 76 **Arnhem Central Transfer Hall**
阿纳姆中央换乘大厅
- 82 **Scala Tower**
斯卡拉塔
- 86 **Sky Village**
天空村
- 94 **Urban Resort Saint Petersburg**
圣彼得堡城市度假村
- 102 **Ozdilek Plaza**
厄兹迪莱克广场

- 108 Life in Town**
城镇生活广场
- 114 Dubai Mixed-Use Towers**
迪拜多功能塔
- 120 Z Towers**
Z字塔
- 126 Chua Boc Mixed-Use Development**
朴寺综合开发工程
- 132 Wind Towers**
风之塔
- 136 Republic Square**
共和广场
- 142 Business Centre Miramare**
米拉马尔商业中心
- 146 Istanbul Seaport**
伊斯坦布尔港口
- 150 Izmir Bayrakli**
伊兹密尔旗
- 154 Al Dana at Al Raha Beach**
阿拉哈海滩阿拉德纳规划
- 160 Headquarters LBBW Immobilien**
LBBW不动产总部
- 164 Bionic Tower**
仿生塔
- 170 The Rebuilding**
重建
- 180 Raffles City Hangzhou**
杭州来福士广场
- 192 The Circle at Zurich Airport**
苏黎世机场圈
- 198 Sustainable Multifunctional Building
with Commerce and Housing**
可持续多功能商住两用楼
- 204 All Seasons Tent Tower**
四季帐篷塔
- 210 Medina Towers**
麦地那大厦
- 216 Y3+1**
Y3+1中心
- 222 Greenside Out**
绿色外围大厦
- 228 Asan Baebang Mixed-Use Complex
– Special Recognition**
牙山城市综合体特别推荐奖
- 236 Changchun 1948**
长春1948
- 242 L.A.R.S.**
L.A.R.S.城
- 246 FENIX**
菲尼克斯城
- 252 Campus Centre**
校园中心
- 262 COR**
COR大厦
- 270 Index**
索引

Shanghai ICC

上海ICC

Functional area 功能区域

Commercial Residential Retail

商业 住宅 零售

Location: Shanghai, China **Designers:** Benoy
Competition date: 2010 **Completion date:** Unknown
Competition name: Pre-certification of LEED Gold **Site area:** 40,000 sqm **Construction area:** 260,000 sqm **Place in the competition:** Excellent prize

项目所在地：中国，上海 设计师：Benoy 参赛时间：2010年 建成时间：未知 竞赛名称：LEED金奖预先认证方案 占地面积：40,000平方米 建筑面积：260,000平方米 竞赛所获名次：优秀奖

Awarded reason:

Benoy has developed a design that layers the modern development with the rich texture of Shanghai's historical design fabric.

获奖原因：

项目设计将现代化工程层次化，并具有浓重的上海历史风貌。



This mixed-use development on Huai Hai Middle Road draws inspiration from the beautiful plain tree lined streets of Shanghai as well as the Shikumen façades from its rich history. The alfresco dining experience as well as the street lined shops, and the public park which makes the city so beautiful is the design inspiration and concept. It is also the vibrancy of the neon-lit buildings and the interaction with the people walking down the street that the designers wanted to bring into the heart of the project. The scheme encompasses two commercial towers that lead down to a seven-storey retail podium and the adjacent residential towers three and four. It features extensive glazing (not the norm for retail design), and has many public design features such as the sunken courtyard, winter garden, landscaped podium roof terrace, countdown square, as well as a green "parkscape" along the southern edge of the site. These lead down to "Fifth Avenue" below ground that links the retail basement levels to the new MTR Station. "Fifth Avenue" is the underground continuation of the fabric of Huai Hai Middle Road, adding another layer to the scheme.

这个位于淮海路的多功能开发工程的设计灵感来自于上海街道两旁的树木和独具历史韵味的石库门建筑。露天小吃、街边林立的店铺、公园等增添城市色彩的元素也为设计提供了理念。设计师还想把灯火辉煌的建筑和街道上的行人引入项目的核心。项目包括两座商业楼、一个7层的商场和三四座住宅楼。项目具有丰富的玻璃平面，远远超过普通的商场。下沉庭院、冬季花园、景观屋顶平台、倒计时广场和绿色停车场构成了项目的公共规划部分。地下的“第五大道”连接了商场和地铁站，是淮海路交通网格的重要组成部分。





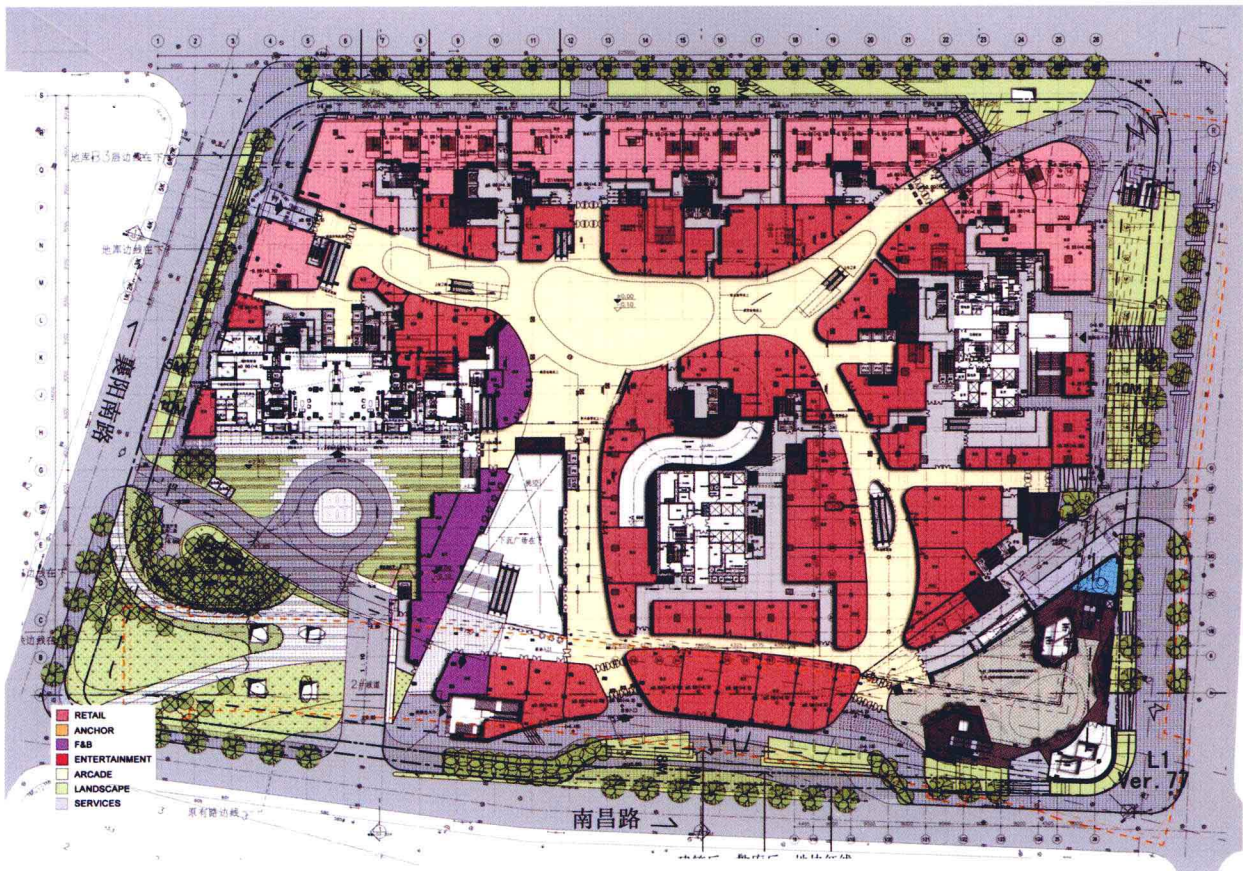



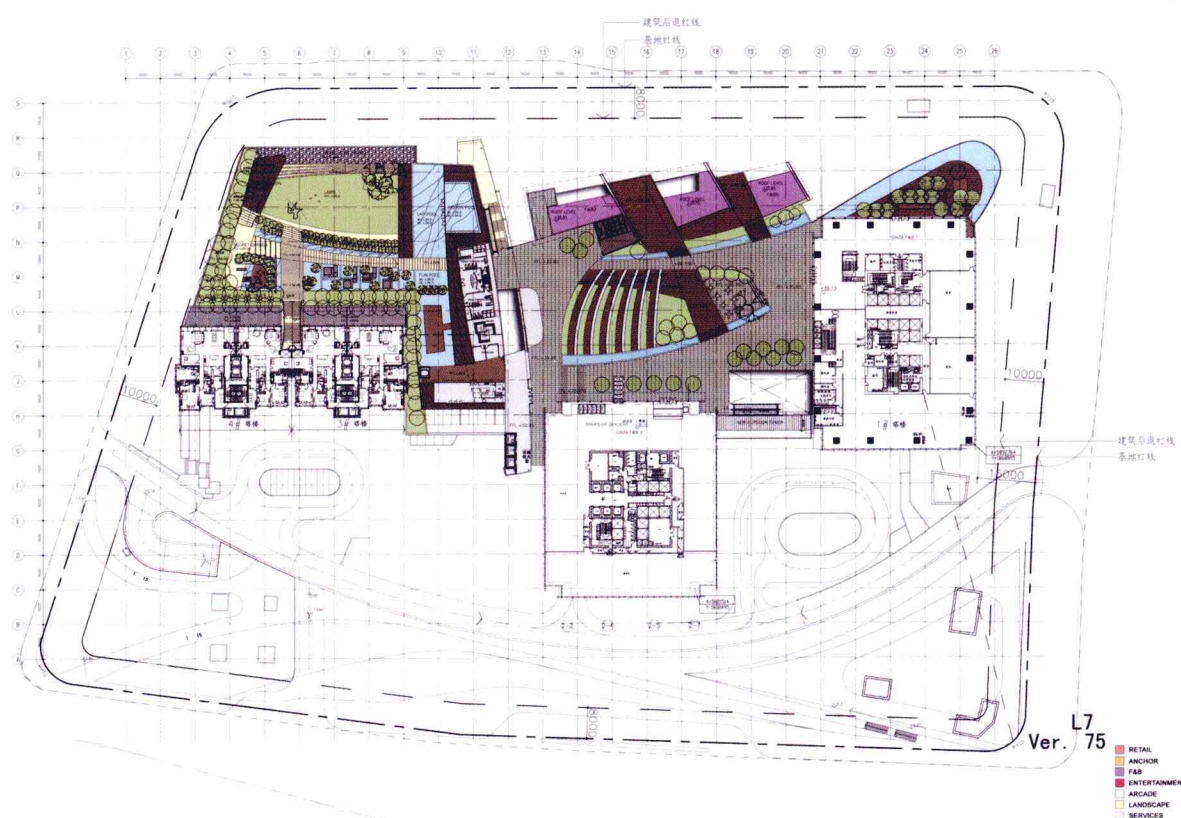







Asan Baebang Mixed-Use Complex – Second Place

牙山城市综合体二等奖

Location: Asan, South Korea **Designers:** DRDS Architecture **Photographers:** DRDS Architecture
Competition date: 2008 **Total area:** 612,000 sqm
Competition scale: International competition
Competition name: Asan Baebang Mixed-Use Project Competition
Organiser: Asan City Government **Place in the competition:** Competition entry second place

项目所在地: 韩国, 牙山 设计师: DRDS建筑事务所 摄影师: DRDS建筑事务所 参赛时间: 2008年 建筑面积: 612,000平方米 竞赛规模: 国际竞赛 主办方: 牙山市政府 竞赛所获名次: 竞赛入围二等奖

The design for Asan Baebang features a new 69-storey landmark high-rise for a redevelopment project located in Asan, South Korea. The mixed-use project consists primarily of officetel and office components housed within 4 high-rise towers. These include 114 residential condominiums. A multi-function podium, including culture, research, healthcare, commercial and public space unites the project at the base. The project size is 612,000 sqm. The site area is 51,379 sqm. The site coverage is 70%. The site is nestled between a hilly woodland to the west and Jangjae Creek to the east. The KTX Chunan Asan Express Railway Station is within a short walking distance. Proximity to the bus line system and pedestrian/bicycle circulation routes also link the project with the rest of Asan in an efficient and sustainable manner. The featured high-rise tower is 69 storeys with a total area of 204,805 sqm consisting of 60,600 sqm of office and 78,400 sqm of officetel including 114 residential units. The average floor plate size is 1,800 sqm. Floor plates are designed with efficient lease depths in mind. The angular façade creates a crystalline effect that dynamically reflects and harmonises with the sky. Towers A and B are 47 storeys in height consisting of officetel with a total area 178,625 sqm. They are focused on family-oriented living. Typical floor plans consist of 9 units facing southeast, south and southwest. This configuration, based on desirable views, inform the tower shape. Tower C is 37 storeys in height consisting of officetel with a total area 158,475 sqm. The tower consists of small sized residential units. The building form reflects ground configuration of a public park and offers bridges that are linked to the north hill. Each unit is oriented to the southeast with a view of the public park.

牙山市城市综合体以创建69层地标性建筑为焦点, 同时打造其他3个高层建筑, 为114户居民提供住宅公寓。该综合体作为一个多功能平台, 集文化、科研、医疗、商业和公共空间于一体, 真正实现了空间功能的多元化利用。项目总面积为612,000平方米, 建筑面积为51,379平方米, 建筑覆盖率为70%。该综合体位于丘陵林地与Jangjae河之间, 与淳安-牙山的高速铁路站相距不远。附近的巴士线路和行人/自行车通道为打造高效、可持续发展的规划项目创造了有利条件。69层高大楼占地204,805平方米, 内设60,600平方米办公区, 78,400平方米酒店写字间, 包括114户住宅。平均每层占地1,800平方米。楼层间的布局以租赁式为出发点。多角度的外观犹如一颗璀璨的水晶, 与湛蓝的天空构成一幅美妙的画卷。A、B两座大厦均为47层, 酒店写字间占地178,625平方米。该空间以家庭生活为主。典型、传统的平面布局中设有9个单元, 分别为东南向、南向和西南向。方位的巧妙设置便于观赏室外景致, 同时造就了大楼独特的形状。C座大厦共37层, 酒店写字间占地面积为158,475平方米。该空间内主要是小型住宅单元。建筑的外观与地面公共停车场的设置遥相呼应, 并与北部山区进行自然衔接。每个住宅空间均设置为东南向, 住户于此可以饱览公共停车场的景致。



Awarded reason:

Asan Baebang Mixed-Use Project is an integral part of the Asan New City Development Plan, a 3,683,200 sqm new city. The development goal is to provide a base area as a self sufficient, multi-functional city, linked to the National Capitol and Administration District, which will shift its function and focus to Asan.

获奖原因:

牙山市城市综合体是牙山新城市发展规划的一部分, 该规划的目标是打造一个自给自足, 多元化新城市, 为国会和国家行政区域的转移创造先决条件。

Award information:

The Asan City Government held the "Asan Baebang Mixed-Use Project Competition" in March, 2008 in Asan, South Korea. It is a privately-financed international competition with many participants invited, including DRDS Architecture. The project presented here received the second place in all the competition entries.

奖项信息:

牙山市政府于2008年3月举办了牙山市城市综合体设计竞赛, 本次大赛为个人赞助国际竞赛, 来自世界各地的设计团队参加了该竞赛。DRDS建筑事务所在本次竞赛中获得了二等奖。

