

益智燕几圖

副本

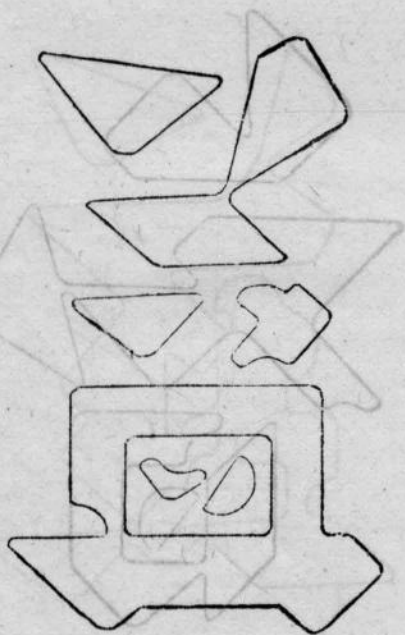

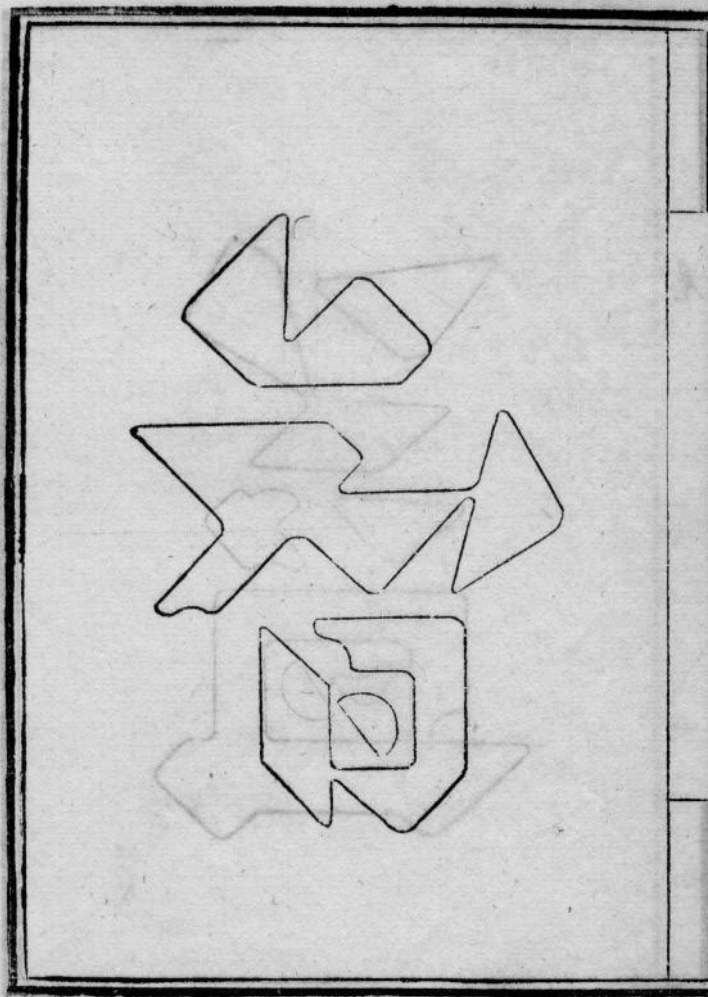



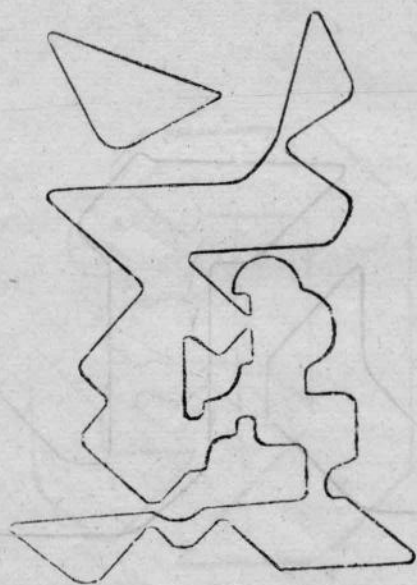

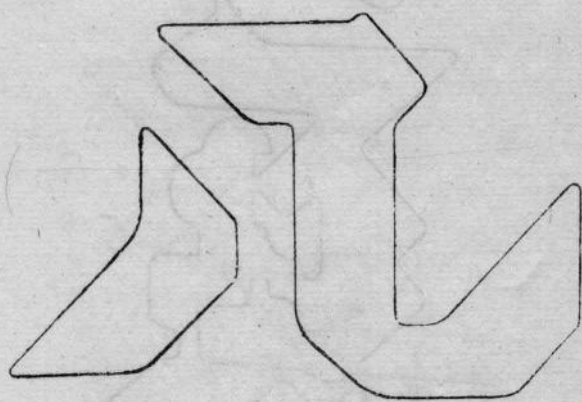



海

眉

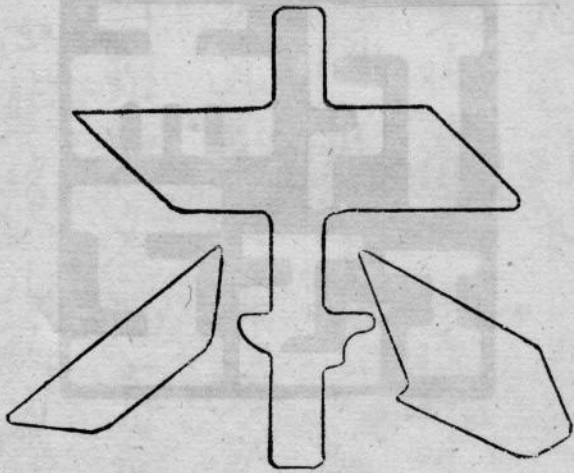

四

下而
巧正

益智燕几圖副本

縱橫變化疊矩重規長短參
差鈎心鬥角渾沌未鑿漫嫌
無竅可通花樣新翻必得有
人索解雖按名而布席任從
大雅之心然移几以成圖須

出小矣之手審曲面勢當
固不立通材補虧就盈若輩
豈盡諳算術倘使咄嗟辨此
未免相對茫然欲其合乎範
圍宜先示之準則伐為斧柄
請視此柯畫到胡靈好依舊

樣因以朱絲作界恍者點出
龍睛從茲粉本常留莫笑添
來蛇足

周規

一之體有六

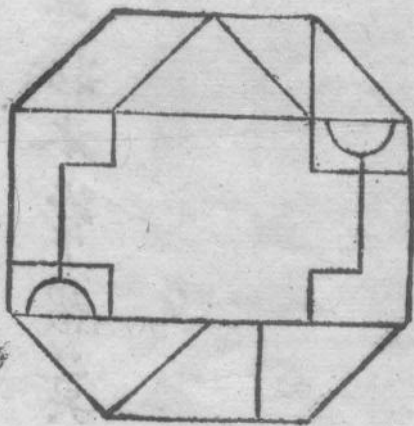

周規一變

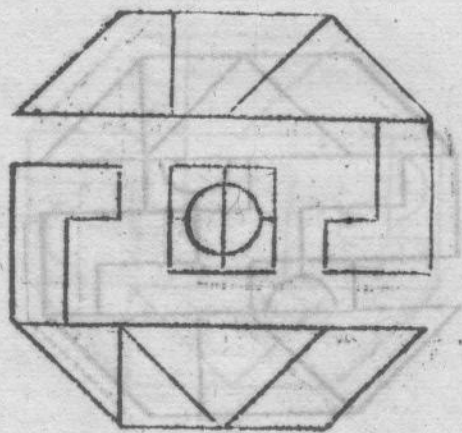

益智燕几圖

三

周規二變

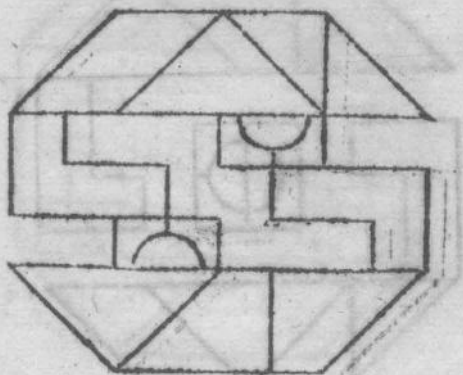

周規三變

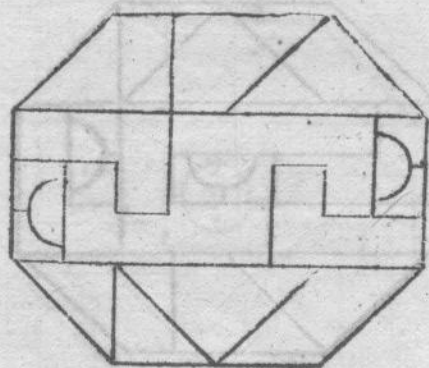

周規四變

