

视觉飨宴

最新特色餐厅设计

Vision Banquet

The latest characteristic
restaurant design

深圳市创扬文化传播有限公司 编

福建科学技术出版社

FUJIAN SCIENCE & TECHNOLOGY PUBLISHING HOUSE

图书在版编目 (CIP) 数据

视觉飨宴：最新特色餐厅设计/深圳市创扬文化传播
有限公司编. —福州：福建科学技术出版社，2008.4

ISBN 978-7-5335-3172-0

I. 视… II. 深… III. 餐厅—室内装修—建筑设计—
图集 IV. TU767-64

中国版本图书馆 CIP 数据核字 (2008) 第 039999 号

书 名 视觉飨宴——最新特色餐厅设计
编 者 深圳市创扬文化传播有限公司
出版发行 福建科学技术出版社 (福州市东水路 76 号, 邮编 350001)
网 址 www.fjstp.com
经 销 各地新华书店
印 刷 恒美印务 (番禺南沙) 有限公司
开 本 635 毫米×965 毫米 1/8
印 张 35
图 文 280 码
版 次 2008 年 4 月第 1 版
印 次 2008 年 4 月第 1 次印刷
印 数 1—2 500
书 号 ISBN 978-7-5335-3172-0
定 价 228.00 元

书中如有印装质量问题, 可直接向本社调换

视觉飨宴

最新特色餐厅设计

Vision Banquet

The latest characteristic
restaurant design

深圳市创扬文化传播有限公司 编

福建科学技术出版社

FUJIAN SCIENCE & TECHNOLOGY PUBLISHING HOUSE

写在前面

Preface

在现今都市里，日理万机的人们不仅对食有要求，对餐饮环境的情调和气氛的期望也越来越高，工作之余亦需要找个舒适写意的地方休息。因此，设计装饰精致的餐厅，渐渐成为一种新时尚。

成功的餐饮空间设计对发展餐饮事业及各地文化交流有莫大帮助。在现今国际化的城市里，应不同的市场需求，饮食业融汇了各地不同的特色，使饮食文化多姿多彩。世界各国的美食能为地方本身的文化增添不少色彩，互相学习和交流也是饮食发展的重要条件，且能带动整体文化的发展。若餐厅的设计能突出当地的特色和地方风格，配合经营主题，再加上不断的创新，就能生意滔滔，客似云来。

设计餐饮空间时，要运用表现技巧去营造情境和创造氛围。例如合适的空间规划、顺畅的人流路线及不同的灯光运用等等，都是展现空间设计的一种手法。在空间设计艺术中，结构可以依据其他因素创造出富有特色的空间形象。这些技巧也就是将设计概念转化成空间形象，将讯息呈现在餐饮空间设计中。设计要切合餐厅的风格和主题，不论是选址、环境、空间及气氛，都是不能忽视的。另外就是家具和摆设装饰，应能凸显餐厅的独特风格。

In the modern and busy cities, people not only have a need of food, but also ask more and more for the sentiment and the atmosphere of diet environment, and there is a good place for resting and eating after the work. Therefore designing and decorating well-connectedly the restaurant and the taproom have become a new style little by little.

It is more important to develop the diet enterprise and promote the cultural communication that the diet room designs successfully and reasonably. With the different demands, the diet enterprises have many different features from other different places, which makes the diet culture various and beautiful. The cate around the world could add some tint to the local culture. Studying and communicating each other are the important conditions of development of diet enterprise, which will develop the whole culture. If the design of the restaurant could give prominence to the local feature and pattern with the theme of management and innovation, it will attain the aim.

When it designs the diet room, it must use skill to make bourn and atmosphere. Such as the appropriate layout of the room, the convenient runway, the different effect of light and so on, that is a way of showing the design of room. The structure could take some other factors to create the characteristic. These skills just transform the concept of design to the appearance of room, and take the message on the diet design. It is unable to neglect the importance of the choosing location, the environment, the room and the atmosphere, and the design should be suit for the pattern and the theme of restaurant. In addition, both the furniture and the furnishings extrude the unique style of restaurant.

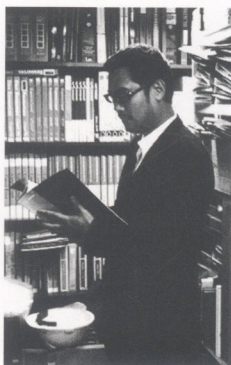

陈德坚
(香港)

目 录

| | |
|-------------------|-----|
| 鼎鼎香新光新天地店 | 4 |
| 鼎鼎香东直门店 | 14 |
| 鼎鼎香东环店 | 22 |
| 精菜馆 | 30 |
| 小南国 | 38 |
| 大牌档 | 46 |
| 美庐东郊红酒坊 | 52 |
| 鸿霖品味坊 | 62 |
| 安·面馆 | 72 |
| 味峰大师菜酒家 | 82 |
| 渔人码头酒家 | 102 |
| 莱根香餐厅 | 120 |
| Conrad Restaurant | 132 |
| Olala Restaurant | 142 |
| 海悦酒店怡和轩中餐厅 | 152 |
| 老上海餐厅 | 160 |
| 锦府盐帮餐厅 | 168 |
| 丹泽名园餐厅 | 174 |
| 龙庭食府 | 182 |
| 老酒川菜坊 | 190 |
| 大渔铁板烧 | 198 |
| 金皇港烧腊茶餐厅 | 202 |
| 乐嘉快餐厅 | 208 |
| 尚上餐厅 | 216 |
| 金本台湾涮涮锅 | 222 |
| 伊太郎日式料理 | 232 |
| 秀罗韩国料理 | 240 |
| 雨花西餐厅虎门店 | 250 |
| 雨花西餐厅西乡店 | 260 |
| Caffe Habitu | 268 |
| Suzuki | 274 |



利旭恒

英国伦敦艺术大学毕业

古鲁奇建筑咨询(北京)有限公司设计总监

2004 年度中国住交会十佳设计师

鼎鼎香新光新天地店

案例地点：北京 / 设计：利旭恒

鼎鼎香新光新天地店宛若是一次怀旧的蜜月旅行。门面用大跨度的黑底圆形光斑大门套，意在营造一种璀璨的星空回忆。水晶挂帘作隔墙，在顶端灯带动照耀下，熠熠生辉，视线可以穿过水晶帘，而水晶在反射七彩光线的时候，却让人看不太清帘子另一边的情景，增加了对大空间的期待感。吧台的裙体也用水晶球作装饰，从下往上打的灯光增加了水晶的垂感，空间显得更加内敛和高贵。而水晶帘作为大厅大餐桌的背景，还有餐桌上方整排的仿古烛灯，更是增添了大厅的恢宏气势。VIP包间的门和墙面一样从顶到地面，整齐大气。大厅方块吊顶错落中带有次序，从细节上加深了空间的微妙变化。立柱用玻璃包围，贴在柱子上则是新古典主义的纹饰，古典高雅的氛围跃然透出。怀旧的餐椅，黑色边框像是燕尾服。

Hotpot Paradise in Xinguang Xintiandi is a nostalgic honey moon trip. The black circular door is aimed to create a shining star memory. The crystal curtain as the partition, people can see through the crystal curtain, the crystal reflects the light and makes the scene unclear, which increases the expectation to the space. The bar is decorated by the crystal balls; the light from inferior adds the vertical feeling, which is nobler. The crystal curtain as the background of the big dinning table in the hall and the period candle light on the table make the hall more magnificent. The door of the VIP room is the same as the wall from top to ground. The diamond drop ceiling is in order in the strewing at random, which enhances the changes of the space in details. The frame surrounded by glass, the new classic decoration pasted on the frame, the classic and elegant atmosphere is shown. The nostalgic chairs looks like swallowtail with the black rims.



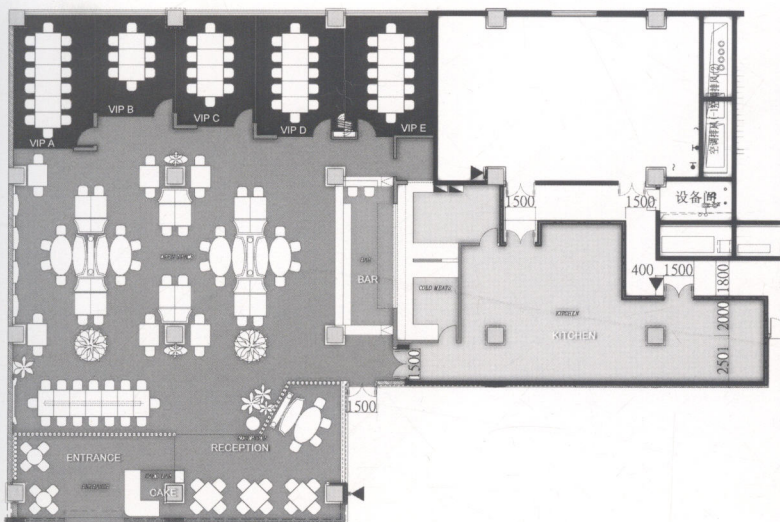

















鼎鼎香东直门店

案例地点：北京 / 设计：利旭恒

鼎鼎香东直门店代表了一种伸展之美。门面的造型完全是为夜色而设的。内外两圈红色的灯带将鼎鼎香的招牌和面门连为一体，并通过地面的反光呈现水天一色的整体感。户外地面灯增加了浪漫气质。一帘之内的大厅和包厢，是掩饰不住的视觉魅惑。椭圆形的吧台是进入大厅的第一个视觉焦点。椭圆形的灯带造型呼应着吧台。弧形玻璃的花台，灯从台内射出，绿色的表面像灯映在浮动的水面上，运用在暖色调的空间中是画龙点睛的一笔。大厅黑色的吊顶，让视觉焦点，停留在吊顶弧形的灯带光线的变化上。墙面镜子上雕刻云纹，让空间充满了雕塑的味道，细腻硬朗中彰显浪漫情怀。圆形的吊顶暗示了一个小型的就餐空间。小圆桌以及与之相呼应的仿古吊灯，则是双重暗示下的“集结号”。

Hotpot Paradise in Dongzhimen indicates the beauty of extension. The sculpture of the door is made for night. The 2 red light belts inner and out connects the signboard and the door, and makes a feeling of connecting the sky and water by the reflection of the floor. The saloon and the balcony inside the curtain are quite attractive. The elliptic flower platform, light comes out from the platform, the green light on the water surface. It is the key point in this space with warm color. The black drop ceiling in the living room makes our eye on the changes that bring by the light from the curved drop ceiling. The carved clouds in the mirror on the wall make the space of the feeling of sculpture, which shows romance in this space. The circular ceiling indicates a small dinning space. The small circular table and the period drop lamp in echo are the result of the double indications.



