

公共
空间

景观设计

(韩)建筑世界(株) C·TOPOS 编著
深圳市金版文化发展有限公司 策划

*Public Space
Landscape PL*

景观设计



著作权合同登记号：图字13-2004-26
本书经韩国建筑世界株式会社授权出版

图书在版编目(CIP)数据

公共空间景观设计/(韩)建筑世界(株), C' TOPOS 编著. —福州:
福建科学技术出版社, 2004.10
I SBN 7-5335-2347-4

I.公... II.①建...②C... III.城市空间—景观—环境设计
IV.TU984.11

中国版本图书馆CIP数据核字(2004)第009632号

书 名	公共空间景观设计
作 者	(韩)建筑世界(株) C' TOPOS
策 划	深圳市金版文化发展有限公司
出版发行	福建科学技术出版社(福州市东水路76号, 邮编350001)
经 销	各地新华书店
印 刷	深圳美雅印刷有限公司
开 本	635毫米×965毫米 1/8
印 张	24.5
插 页	4
图 文	186码
版 次	2004年10月第1版
印 次	2004年10月第1次印刷
书 号	ISBN 7-5335-2347-4/TU·70
定 价	168.00元

书中如有印装质量问题, 可直接向本社调换

TU984.12-64
J330.1/2

公共空间景观设计

(韩)建筑世界(株) C' TOPOS 编著

深圳市金版文化发展有限公司 策划

福建科学技术出版社

目录

C O N T E N T S

4 序言
Foreword

6 前言
Preface

完成作品 Completed Works

12 大邱达西公园
Daegu Duryu Park

28 济州Man-Gyung区Nam Garam文化街
Nam Garam Culture street in Man-Gyung District, Jeju

40 Danwongak 主题公园
Theme Park around Danwongak

52 Ayang 桥的雕塑和灯光设计
Sculpture & Light for Ayang Bridge

68 Cheonan Sangnok 乡村俱乐部的扩建
Enlargement of Cheonan Sangnok Country Club

80 Yongma 自然公园的人造瀑布
Man-made Waterfall at Yongma Nature Park

100 大邱东区办公楼前Yeollin Madang广场
Yeollin Madang Plaza in front of Dong-gu Office, Daegu

114 Pyeonghwa公园
Pyeonghwa Park

126 仁川Munhak体育馆周边环境设计
Neighboring Area Project around Incheon Munhak Stadium

136 时尚文化步行街
Fashion & Culture Street for Pedestrians

竞赛与规划 Competition & Plan

146 海南恐龙自然历史研究园
Haenam Study Field of Dinosaur Natural History

154 济州和平公园
Jeju Peace Park

164 Gangil区公屋村
Public Housing in Gangil Area

170 世界杯体育场第二桥
The 2nd Seongsan Bridge

174 Cheonggyecheon桥
Cheonggyecheon(stream) Bridge

180 Eoul天桥
Overpass Design-Eoul Bridge

184 江原滑雪度假村
Gangwon Land Ski Resort

188 仁川Songhyun周边公园
Inchon Songhyun Neighborhood Park

192 Hangdam小岛休闲设施
Hangdam Island Rest Facilities

序 言

Foreword

找寻自然和艺术的结合点

园林建筑和设计作为专业领域的独立门户已有30载。园林建筑和设计产业的发展归功于国际重要盛会的带动，例如，1988年汉城奥林匹克运动会、2002年韩日足球世界杯以及各种综合性居民住宅小区的不断发展。但是，此领域中竞争实力强大，而可作为行业领头羊的主导设计机构可谓凤毛麟角，C' TOPOS 就是其中为数不多的几家公司之一。

C' TOPOS 在各个不同领域均作出了令世人瞩目的成绩，是一支前途无量的设计团队。在韩国，从济州到江原道，他们的众多出色工程遍布各地，包括总体园林设计——公园、滑雪度假村、高尔夫俱乐部、住宅小区和文化街，还有桥梁建设、雕塑以及安装艺术。他们勇于接受新的挑战，大展拳脚，不会束缚于传统观念中植物、设施设计等的园林设计。他们尤其重视对自然和艺术之间和谐的追求，秉持着“在人造元素中充分体现自然气息，在自然中明确定位人造成分”的理念。因此，其中的艺术价值非常高。园林设计作品引入超前的自然样式和形式，亲近自然的泥土，让生活动感十足。从千禧艺术作品——恐龙观测台，不难看出他们突出的甚至是具有突破性的设计，与环境形成了美妙的和谐。为了创造不断进步的设计环境，设计公司专门组成了一支工程队伍和现有的园林建筑设计团队，在设计作品上通力合作。Choi Shin Hyun，集团的领导人，是韩国园林建筑和设计专业本科部的第一代毕业生。他准确的辨识

和分析能力让他主导并成功完成了所有的工程。C' TOPOS于2003年开始营运，但是Choi先生此前便曾经领导通用工程公司的园林建筑和设计团队——C' TOPOS 的前身Woodai 技术小组，并在此期间全身心投入工程运作并发展了其自身的园林哲学。他不仅关注韩国本土传统文化和历史，也不会忽略国际园林设计主流。他精选了各个国家的一些代表新的潮流趋势的园林设计代表作，亲身观察体验、研究，最终在其设计作品中折射出智慧的光芒。

现在，韩国的园林建筑和设计产业已经经历了引入和稳定阶段，正处于大发展阶段。在这一时期，园林建筑呼唤本土文化融入这个领域，有了新的血液的补充才能持久常新，并适应环境的发展，吸引众人目光。在这一方面，Choi先生和C' TOPOS以此为己任，不满足现状，继续前行。我衷心祝愿他们能充分领会深远的设计理念，创作出符合时代发展要求的优秀作品。

汉城大学城市园林和建筑系Lee, Kyu mok 教授

Seeking artistic encounter of nature and art

It has been 30 years since agency for landscape architecture and design occupied one separate professional area. The development of landscape architecture and design industry owes much to important international events such as 88 Olympics and 2002 World cup and continuous development of residence complex and active self-administration. However, there is few offices which can be counted as competitive and prominent ones. C' TOPOS is one of a few representative companies.

C' TOPOS has been getting a sensational attention in various fields and is a promising design group. They are involved in projects of far-reaching regions from Jeju to Kangwon-do and they completed lots of projects ranging from normal landscape such as parks, ski resort, golf club, residence complex and culture street to bridge, sculpture and Installation art. Not limited to normal landscape architecture including planting trees and grass and design of facility, they are willingly faced with new challenges. They are especially interested in harmonious relation between nature and art. Nature can be spotlighted through its matching artificial elements and the artificial parts can be distinctively positioned against nature. Accordingly, its artistic value can be more appealing. This landscape work introduced aggressive pattern and forms to nature, which give dynamic power and touch to the land. As seen from millennium art pieces, dinosaur observation tower, their aggressive and challenging contrast become harmonious with environment. To initiate advancing design environment, the design group operates a separate project group involved in designing scenic formative pieces along with the existing

landscape architecture and design team. The leader, Choi Shin Hyun of this group, is the 1st generation of landscape architecture and design department at undergraduate course. He directs and manages all project with accurate recognition and analysis power. C' TOPOS started its business in 2003 but Mr. Choi himself led the landscape architecture and design team of General Engineering Company 'Woodai Technology Team', the predecessor of C' TOPOS for a long time and developed his own philosophy on landscape and passionately executed projects. He pays special attention to the tradition and history of Korea and don't miss international mainstream of landscape. He selects representative landscape works of a new trend from various courtiers, visits, does research on them and finally reflect what he found to his design work.

Now, the landscape architecture and design industry of our country is arriving at puberty, going through introduction and settling period. At this point, landscape architects are required to our own culture for this field to be more everlasting and environment-friendly and attractive. In this aspect, Mr. Choi and C' TOPOS are left assignments more than what they have achieved and I wish they prepare ground for profound design philosophy and can meet demand of this era.

Lee, Kyu mok Prof. of City Landscape and Architecture Dept., Univ. of Seoul.

前言

P r e f a c e

如果我曾住在伊甸园……

当我还在学生时代，我便开始订阅一本名为《现代住宅》的杂志，是它为我开启了设计之门。在那个时候，我常常画一些我理想中的住宅草图，这也是我30年设计生涯的开端，荏苒岁月，弹指一挥间。

由于家庭的影响和宗教信仰，在我心中伊甸园是风景如诗似画的仙家境地。有时，我不禁浮想联翩，究竟在圣经中的伊甸园是何许仙境。当我们美丽的地球需要人类去开发，我将成为改造队伍中的一分子，为我们

If I had lived in Eden Garden ...

When I was a high school student, I subscribed architecture magazine named 'modern housing' that made me interested in design. At that time, I used to draw my future house, which seems the beginning of my design career and 30 years has passed away since then.

I'm Christian from my mother's womb, and sometimes I wonder what the Eden garden in Bible is like. That's because I thought Eden garden is the very ideal landscape space. When this beautiful earth land given by God needs human development or put in a dangerous situation to be damaged, I can take part in that



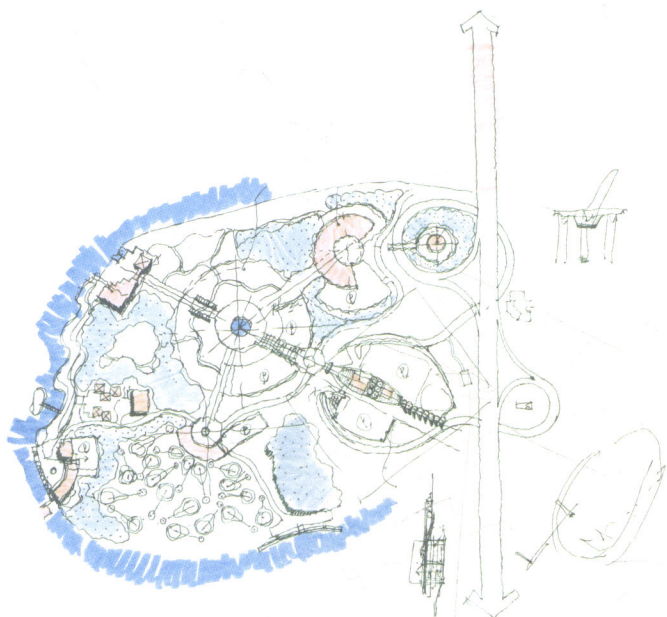
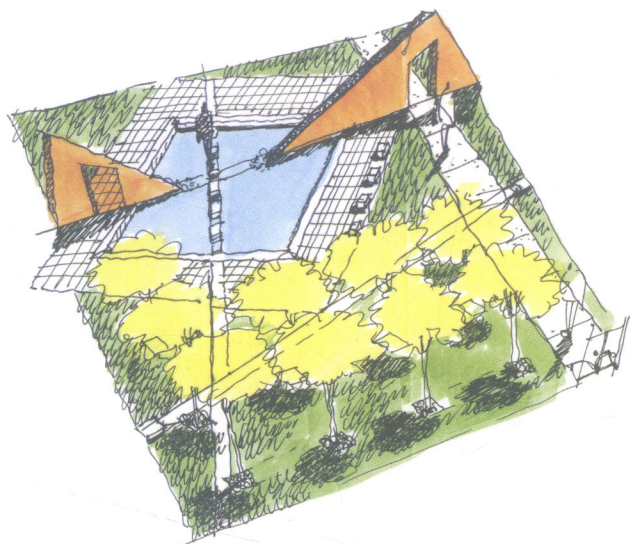

的家园平添一分美丽。因此，我一直为自己的职业而引以自豪。同时，也希望我的名字能作为一个自然主义园林设计师而能被后代提及。

在2003年，我将自己的作品齐集于此书，希望能温故而知新，文思泉涌，新的创作灵感会源源不断。我愿尽此一生为从天真孩童到耄耋老者创造出能使他们尽享其乐的美丽空间。如有可能，我希望能设计出如安东尼奥·高地那样名垂青史的杰作。尽管我的作品尚未达到炉火纯青，但是我将竭尽全力完善我的作品。因此，我的心中也同样洋溢着快乐的感觉。谨希望此书能对钟情园林设计领域的同行有所帮助。

C' TOPOS执行董事Choi, Shin hyun

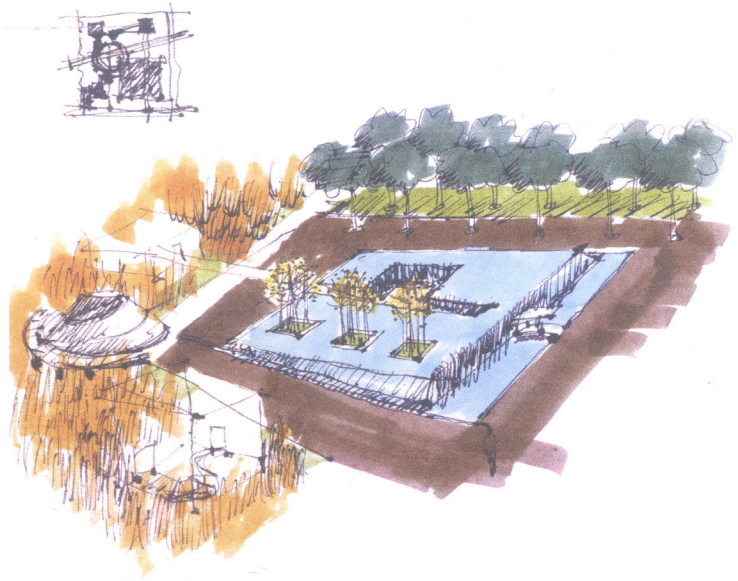

process and change area into more beautiful space. So, I always appreciate that I do this job. Through my job, I hope to give people joy and comfort, furthermore, glorifying god. And finally for me, I hope that I could leave my name to posterity as “naturalist landscape designer, Choi, Shin hyun”.

Now in 2003, I collected my all works to present a workbook from my personal desire to look back on myself and suggest a new vision on design. I would like to spend the rest of my life to create beloved space where everybody from children including my lovely daughter, Jiwon to the old can freely enjoy him or herself. If possible, I also want to create a great masterpiece like that of Antonio Gaudi y Cornet. Even though my workbook is not so great, I carefully made this book with all my effort. So my heart is now fluttering and I sincerely hope that this book could be a small help to all landscape designers interested in this field. I present this book, promising to always devote myself to ‘the new’.

Representative director of C'TOPOS, Choi, Shin hyun



完成作品

Completed
Works

大邱达西公园

济州 Man-Gyung 区 Nam Garam 文化街

Danwongak 主题公园

Ayang 桥的雕塑和灯光设计

Cheonan Sangnok 乡村俱乐部扩建

Daegu Duryu Park

Nam Garam Culture Street in Man-Gyung District, Jeju

Theme Park around Danwongak

Sculpture & Light for Ayang Bridge

Enlargement of Cheonan Sangnok Country Club

Yongma 自然公园人造瀑布

大邱东区办公楼前 Yeollin Madang 广场

Pyeonghwa 公园

仁川 Munhak 体育馆周边环境设计

时尚文化步行街

Man-made Waterfall at Yongma Nature Park

Yeollin Madang - Plaza in front of Dong-gu Office, Daegu

Pyeonghwa Park

Neighboring Area Project around Incheon Munhak Stadium

Fashion & Culture Street for Pedestrians

大邱达西公园

Daegu Duryu Park

设计: C' TOPOS + WOODAE工程咨询公司

占地面积: 70000m² (设施区域面积: 35000m²)

Design: C' TOPOS + WOODAE Engineering Consultants Co., Ltd.

Site Area: 70000m² (Facilities Area: 35000m²)

Duryu公园是一个大型户外表演广场和草地, 与周围各种各样的设施相映成趣, 包括 Woobang Towerland、大邱文化艺术中心、运动场。让原来地面层与众不同的、壮观的壁泉广场为城市街景增添亮色。这个公园与公共场所的完美结合, 是公园密集高效型发展的典范之作。

Duryu Park contributes to form a large-scaled outdoor performance plaza and lawn field, connected with diverse facilities including neighboring Woobang Towerland, Daegu Culture and Arts Center, Sports Complex. A grand wall-fountain plaza preserving the original ground level difference improves the scenic beauty of urban streets, and this park linked with public spaces can be a good model case for intensive and efficient park development.

