

# Task Listening

*Lesley Blundell and Jackie Stokes*

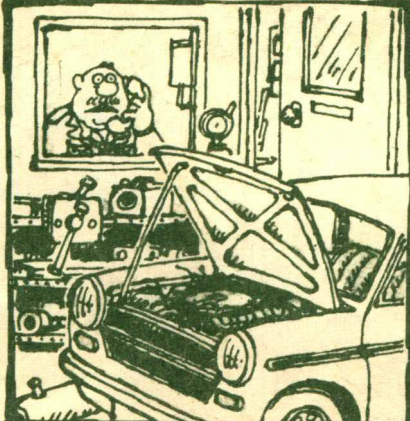

McLACHLAN

# Task Listening

## Student's Book

*Lesley Blundell and Jackie Stokes*

Cambridge University Press

Cambridge

London New York New Rochelle

Melbourne Sydney



Published by the Press Syndicate of the University of Cambridge  
The Pitt Building, Trumpington Street, Cambridge CB2 1RP  
32 East 57th Street, New York, NY 10022, USA  
296 Beaconsfield Parade, Middle Park, Melbourne 3206, Australia

© Cambridge University Press 1981

First published 1981

Third printing 1982

Printed in Great Britain at the  
University Press, Cambridge

ISBN 0 521 23135 3 Student's Book

ISBN 0 521 23136 1 Teacher's Book

ISBN 0 521 23137 X Cassette

### **Copyright**

The law allows a reader to make a single copy of part of a book for purposes of private study. It does not allow the copying of entire books or the making of multiple copies of extracts. Written permission for any such copying must always be obtained from the publisher in advance.

## Acknowledgements

The authors would like to thank Mrs H. A. Swan and the staff of the Swan School, Oxford, for testing this material. They would also like to thank the following for taking part in the recording: Judith Bennett, Jon Blundell, Mrs P. Brown, Marilena di Gennaro, Margaret Flynn, Elizabeth Fox, Stuart Haggart, Michael Martin, Fiona Morison, Ray Murphy, Helen Naylor, Michael Parsley, Felicity Preedy, Peter Ratcliffe, Christopher Richards, Yumiko Seshimo, Rodney Smith, H. A. Swan, Ruth Swan, Thomas Swan and Stephen Woolgar.

Illustrations and extracts are reproduced by kind permission of the following: British Railways Board (pp. 2 and 3); British Airways (p. 5); Associated Book Publishers Ltd: cartoons from *Penelope* (p. 7) and *Angels on Horseback and Elsewhere* by Norman Thelwell (p. 49); Andre Deutsch Ltd: extract from *How to be an Alien* by George Mikes (p. 7); Consumers' Association: cartoon from *Handyman Which?* (p. 7) and extract from *Which? Car Buying Guide 1975* (p. 37); Punch Publications Ltd: cartoon by Raymonde (p. 7); Wales Tourist Board (p. 9); Midland Bank Ltd (pp. 14 and 15); Duckworth and Co. Ltd: illustration from *Inventions* by W. Heath Robinson (p. 19); Automobile Association (p. 21); Drive Publications Ltd: material from *AA Book of the Car* (p. 25); Adkin and Co. (pp. 26 and 27); Royal Shakespeare Company (p. 43); J. Sainsbury Ltd (p. 45); J. Allan Cash Ltd (p. 46a, b, e and f); Private Eye Productions Ltd: cartoon by Ffolkes (p. 49); Syndication International Ltd (p. 50); William Collins Sons and Co. Ltd: quizzes from *The Armada Christmas Fun Book* compiled by Mary Danby (p. 51); Dateline International (p. 53).

Photographs by Maggie Stocking: pp. 23, 46c and d; by Stephen Woolgar: p. 52  
Illustrations by Annie McManus: 4, 10, 16, 30, 31, 44, 48; by Chris Evans: pp. 6, 8, 15, 18, 32, 34

Cover illustration by Edward McLachan

Book design by Peter Ducker

Introduction	1
1 Catching the right train	2
2 Catching a plane	4
3 Forecasting the weather	6
4 Sightseeing	8
5 Finding out the house rules	10
6 Phoning a flat-owner	12
7 Using a bank account	14
8 Leaving a message	16
9 Learning how to use a machine	18
10 Finding the way	20
11 Enquiring about a course	22
12 Hiring a car	24
13 Finding out who's who	26
14 Fixing an appointment	28
15 Making enquiries at a travel agency	30
16 Shopping	32
17 Moving in	34
18 Phoning a garage	36
19 Flat hunting	38
20 Talking about television	40
21 Finding out what's on	42
22 Guessing what people are talking about	44
23 Following instructions	46
24 Parking in London	48
25 Doing puzzles	50
26 Spotting the culprits	52

## Introduction

*Task Listening* helps make listening to English easy!

You may find it difficult to understand English spoken at normal speed because it seems too fast, and the language you have already learnt may seem incomprehensible when used in everyday conversation. These difficulties arise because you are probably trying to catch every word and are missing the overall message as a result. *Task Listening* will help you to listen for the *gist* of what someone is saying and to sift out the information you really need to know.

*Task Listening* consists of twenty-six units. In each unit you will hear a short tape recording and do some kind of practical exercise or task in your book, such as labelling a picture or filling in a grid. The recordings are of people speaking at normal speed in everyday situations. Each unit has as its theme a setting or situation in which listening plays a major part, for example at an airport listening for flight announcements or at a travel agency being told about different means of transport.

When you listen to the recording, remember, you don't need to understand every single word to get the general idea of what is being said and to do the task. For example, in unit 7 'Using a bank account' (page 14) there is a blank cheque. The setting for the recording is at the bank where a cashier is helping a foreign student to fill in a cheque. The task for you is to do just that. You may listen to the tape as many times as you want in order to glean all the relevant details to complete the task.

Besides the listening task, there are also reading and writing tasks related to the theme of the unit. So, for example, after filling in the cheque in unit 7 you have a look at a bank statement and fill in a banker's order.

# 1 Catching the right train

## Listening

Fill in the details of the trains on the grid.

Destination	Platform Number	Time	Other Information
SOUTHAMPTON			
COVENTRY			
PLYMOUTH			
PADDINGTON			
CARDIFF			
YORK			

British Rail  
Inter-City  
Return  
To Southampton  
316

Issued subject to the Regulations and Conditions in the Publications and Notices of the British Railways Board.  
Not transferable

British Rail  
Inter-City  
Return  
To Coventry  
084

Issued subject to the Regulations and Conditions in the Publications and Notices of the British Railways Board.  
Not transferable

British Rail  
Inter-City  
Return  
To Plymouth  
265

Issued subject to the Regulations and Conditions in the Publications and Notices of the British Railways Board.  
Not transferable

Price Class  
265 13.00 1st C  
(2)  
Oxford  
798 12.00 1st  
Ticket No. Date  
Outward

British Rail  
Inter-City  
Return  
To York  
393

Issued subject to the Regulations and Conditions in the Publications and Notices of the British Railways Board.  
Not transferable

Price Class  
393 20.70 1st  
From Oxford  
Ticket No. Date  
Outward

British Rail  
Inter-City  
Return  
To Cardiff Central  
059

Issued subject to the Regulations and Conditions in the Publications and Notices of the British Railways Board.  
Not transferable

Price Class  
059 12.10 1st  
(4)  
Oxford  
Ticket No. Date  
Outward

British Rail  
Inter-City  
Return  
To London Paddington  
257

Issued subject to the Regulations and Conditions in the Publications and Notices of the British Railways Board.  
Not transferable

Price Class  
257 4.03 1st  
From Oxford  
Ticket No. Date  
Outward

## Reading and writing

32 Abercrombie Ave,  
Coventry,  
Sunday evening.

Dear Peter,

Thank you for your postcard from Italy. We were pleased to hear you enjoyed yourself.

Yes we'd love you to come on the 27th for the weekend. Why don't you get a train from Paddington after work on Friday? Write to us and say when you'll arrive at Coventry and we'll meet you at the station.

See you on Friday  
Love from  
Andrew and Jenny

Choose a suitable train for Peter to catch and complete his postcard to Andrew and Jenny.

See you on Friday  
Love from  
Andrew and Jenny

London → Reading → Oxford → Banbury → Birmingham  
Mondays to Saturdays

ARR  
ARR

	Paddington	Reading	Didcot	Oxford	Banbury	Leamington Spa	Stratford-upon-Avon	Donnington	Solihull	Coventry	Birmingham International	Birmingham New Street
departures									arrivals			
15 50	16 20	16 30	16 51	17 18	17 37	18 16	18 32	18 58	17 58	→	→	18 18
16 25	16 41	→	17 15	17 42	18 02	→	→	18 21	18 21	→	→	18 40
16 25	17 04	17 03	17 36	18 17	→	→	→	→	→	18 28	→	18 58
17 30	18 00	18 20	18 36	18 58	19 07	19 27	20 16	19 42	19 48	→	→	20 06
17 42	→	→	19 29	20 31	20 14	20 16	21 02	21 08	21 08	→	→	20 58
18 06	18 57	18 46	20 05	20 50	20 50	21 31	21 55	22 02	22 02	20 28	20 41	21 40
19 00	19 30	19 48	20 20	20 50	22 21	22 41	23 17	22 58	→	→	→	23 21
20 50	21 20	21 38	21 55	→	→	→	→	→	→	→	→	→

Be properly  
addressed

Dear Andrew & Jenny



## 2 Catching a plane

### Listening

Fill in the missing information.





### 3 Forecasting the weather

#### Listening

Choose one of the places on the map and listen for the weather forecast for that area.  
Draw the correct symbol on the map.

with long periods of sunshine

cool becoming warmer

cold

dry

cloudy with showers at times

cloudy with some rain, heavy at times

windy

snow

sleet

fog

INVERNESS

EDINBURGH

BELFAST

DUBLIN

BIRMINGHAM

CARDIFF

LONDON

## Reading and writing

### THE WEATHER

THIS is the most important topic in the land. Do not be misled by memories of your youth when, on the Continent, wanting to describe someone as exceptionally dull, you remarked: 'He is the type who would discuss the weather with you.' In England this is an ever-interesting, even thrilling topic, and you must be good at discussing the weather.

#### EXAMPLES FOR CONVERSATION

##### *For Good Weather*

'Lovely day, isn't it?'

'Isn't it beautiful?'

'The sun ...'

'Isn't it gorgeous?'

'Wonderful, isn't it?'

'It's so nice and hot ...'

'Personally, I think it's so nice when it's hot— isn't it?'

'I adore it — don't you?'

##### *For Bad Weather*

'Nasty day, isn't it?'

'Isn't it dreadful?'

'The rain ... I hate rain ...'

'I don't like it at all. Do you?'

'Fancy such a day in July. Rain in the morning, then a bit of sunshine, and then rain, rain, rain, all day long.'

'I remember exactly the same July day in 1936.'

'Yes, I remember too.'

'Or was it in 1928?'

'Yes, it was.'

'Or in 1939?'

'Yes, that's right.'

What do you think is being said in these cartoons? Write captions for each one.



Empty rounded rectangular box for writing a caption.



Empty rounded rectangular box for writing a caption.



Empty rounded rectangular box for writing a caption.



## 4 Sightseeing

### Listening

Put the correct number in the box beside each description. Then fill in the missing information.

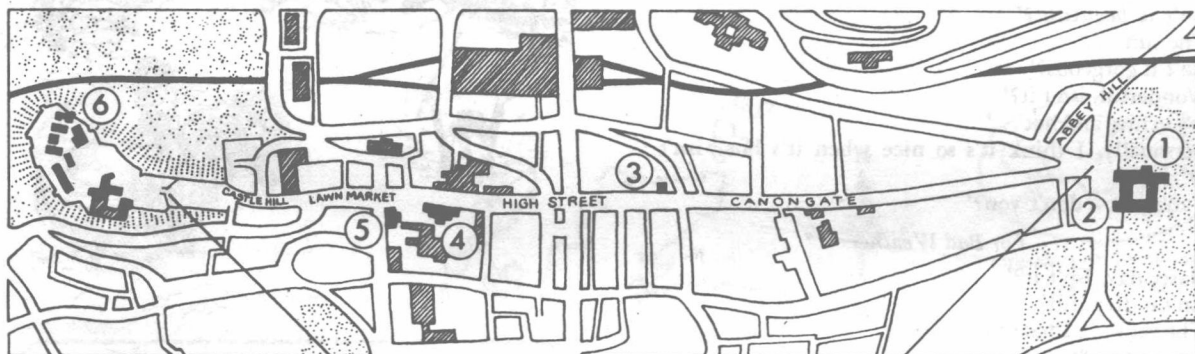

The three roads together between these two points are called.....

### THINGS TO SEE IN EDINBURGH

☐ Abbey: built in ..... by King David of Scotland.

☐ John Knox House: now a .....

☐ Heart of Midlothian is a heart-shaped design in the .....





☐ The Palace of Holyrood .....

☐ Edinburgh Castle: part of this, Queen Margaret's chapel is the ..... building in Edinburgh.

☐ St Giles's Cathedral: where ..... preached.

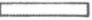
Reading and writing

North Wales' Major Attractions

SPRING  ● Season open  
SUMMER  ○ Day open  
AUTUMN   
WINTER 

		Monday	Tuesday	Wednesday	Thursday	Friday	Saturday	Sunday
1	Portmeirion	●	●	●	○	○	○	○
2	Rhuddlan Castle	●	●	●	○	○	○	○
3	Rhyl Floral Hall	●	●	●	○	○	○	○
4	St. Winifreds Well, Holywell	●	●	●	○	○	○	○
5	Segontium Roman Fort	●	●	●	○	○	○	○
6	Snowdon Mountain Railway, Llanberis	●	●	●	○	○	○	○
7	Sun Centre, Rhyl	●	●	●	○	○	○	○
8	Swallow Falls, Betws-y-Coed	●	●	●	○	○	○	○
9	Tegfryn Art Gallery, Menai Bridge	●	●	●	○	○	○	○
10	Trefriw Woollen Mills	●	●	●	○	○	○	○
11	Welsh Mountain Zoo, Colwyn Bay	●	●	●	○	○	○	○



Write a postcard to an English friend about your holiday in Wales.



Rhuddlan's mighty castle.

COLOURMASTER INTERNATIONAL

CA 58

POST OFFICE  
PREFERRED  
Printed in Great Britain

PLX14127

Hotels, Motels, Inns and Guest Houses

Town (County)  
Hotel  
Address  
Telephone number

	Overnight bed and breakfast		Dinner, bed and breakfast		Full board	Weekly terms		Number of letting rooms	Private Public	Number of bathrooms	Period open months	Other facilities
	Min.	Max.	Min.	Max.	Min.	Max.	Min.					
	£	£	£	£	£	£	£				1-12	
<b>TREFRIW</b>												
Gwynedd (Caernarfonshire)												
Inn												
Ye Olde Ship T. Llanrwst 640073			7-50					3	1	1-12	P X F A	
Guest Houses												
Argoed T. Llanrwst 640091				32-00				2	1	1		P W L F C
Gaynor House T. Llanrwst 640208	3-50		7-00	35-00				2 2 3	1	1-12		P W L F C
Trefriw Wells T. Llanrwst 640057	5-50		10-00					1 4	1	1-12		P X F C
Private Houses												
Belmont, Ffordd Crafant												
T. Llanrwst 640463			7-00	35-00				2	1	4-10		P W L F C
Kendal T. Llanrwst 640200		3-25		35-00				2 1	1	1-12		P W L F C
Tan-y-Coed T. Llanrwst 640766	3-50	4-00	6-00	35-00				4 1	1	1-12		P W L F C

**P** Outdoor parking available.

**UL** Not licensed for sale of alcoholic drinks.

**X** Dogs not allowed under any circumstances. If this symbol does not appear it is still advisable to contact the establishment concerned.

**B** Childrens cots and high chairs and baby sitting/listening service available.

**C** Reduced Rates for children.

**A** Ironing facilities available for guests use.

## 5 Finding out the house rules

### Listening

Put a cross on the picture where the rule is being broken. Make brief notes of each rule.

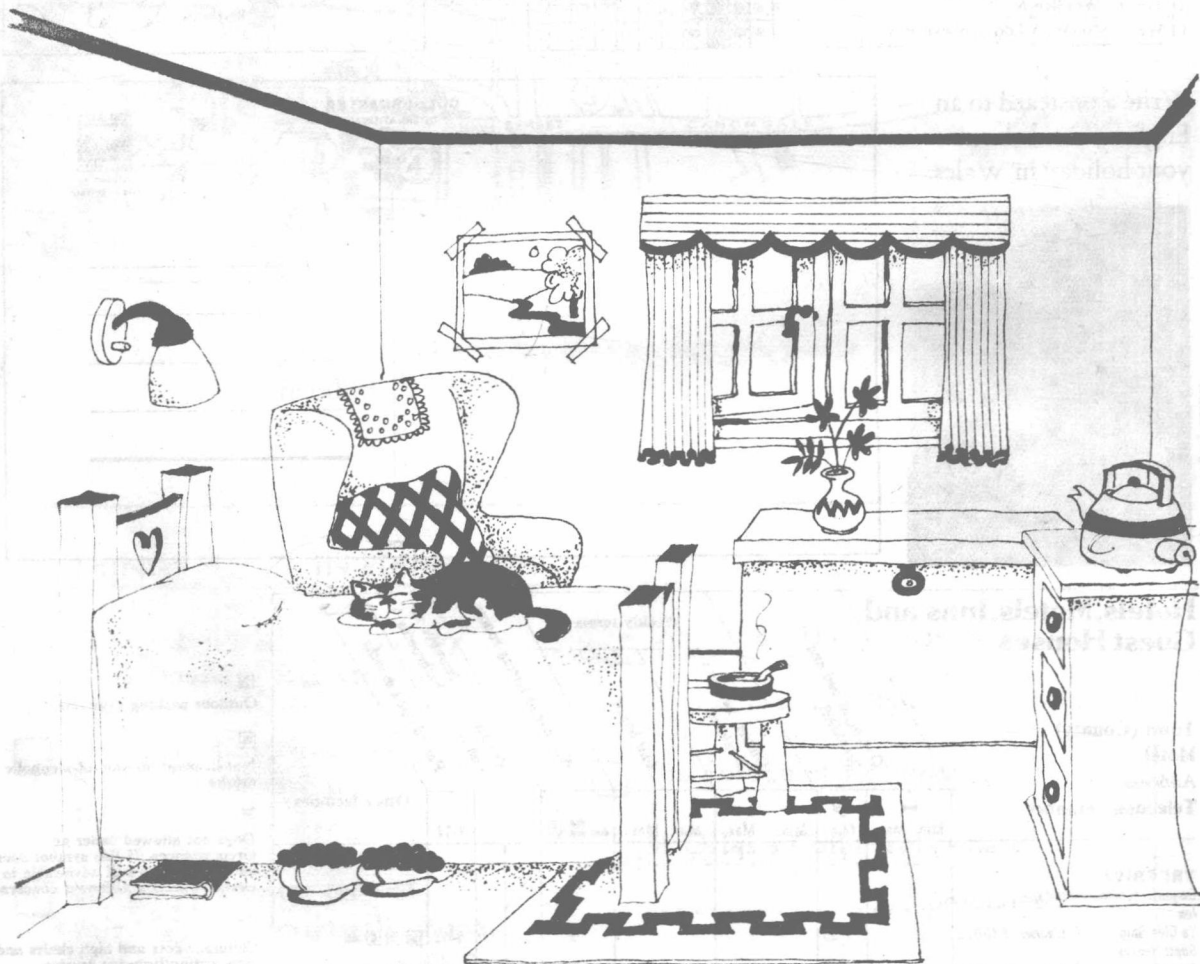

## Reading and writing

You are staying at a hotel. Read the notices below.

**On arrival** Find your room. Put a circle round the number on the plan.  
Find the fire exit. Put 'FE' on the plan and draw a line from your room to the exit.  
Find the nearest fire extinguisher. Put a circle round the symbol on the plan.

**On departure** Pay bill for 7 nights = £.....  
Where do I leave the key?.....  
Can I leave my room after lunch?.....  
Can I pay by cheque? .....

It is essential that all guests read this notice.

### Fire Precautions

#### If you detect a fire

1. Sound the fire alarm.
2. For small local outbreaks, and if there is no personal danger, try to put out the fire by using the nearest extinguisher.

#### In the event of fire

1. Warning bells/sirens will ring continuously.
2. Close all doors and windows.
3. Evacuate the Hotel by using: —  
**your nearest exit, which is**

TURN LEFT THEN RIGHT

.....  
TO EXIT  
.....

### General Information

#### Vacating Rooms

Bedrooms must be vacated by NOON on the day of departure. PLEASE LEAVE YOUR KEY WITH RECEPTION.

#### Cheques

We regret that cheques cannot be accepted unless supported by a bankers card.

Your room number is

14

Your room rate is £ 15.00 per night  
for 1 person

including morning paper, early morning tea,  
English breakfast and VAT.

Departure date

7 August





## 6 Phoning a flat-owner

### Listening

Put a tick or a cross in the boxes.

Fill in the missing information.

Ring Oxford 40414 about  
furnished flat

Find out:

☒ or ☐

Near City Centre

☐

Near Shops

☐

Garden

☐

Central heating

☐

Visit tomorrow 5 p.m.

☐

Rent per month .....

Number of rooms .....

Floor .....

Name of landlord/landlady

Address