

栋梁集

1

北京市建筑设计研究院作品选



中国计划出版社

贝思出版有限公司

86.3586

北京市建筑设计研究院

作品选

1949 - 1996

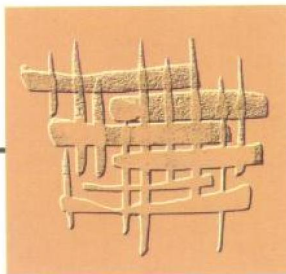

INTRODUCTION OF BEIJING INSTITUTE OF ARCHITECTURAL DESIGN AND RESEARCH

Beijing Institute Architectural Design and Research (formerly named Beijing Institute of Architectural Design) was set up in 1949. It is a big comprehensive design and research unit specializing in design of civil buildings and having the right to do business in foreign countries. It was listed as the No.1 architectural design unit among the top hundred comprehensive design units in the evaluation made by the Ministry of Construction, State Statistical Bureau and China Construction Enterprises Appraisal Counter in 1993 and the No.1 unit among the design and research units of provincial level in the country by China Association of Geological Survey and Design Units in the evaluation on five indexes (per capita income, tax and profit, CAD, property and awarded projects). It has been honored with the title of Design and Research Unit with Outstanding Contributions to the Architectural Design in Beijing Municipal Government in October, 1993. It has now 1265

employees, of whom 1075 are technical persons, 6 national master architects, 296 senior architects and engineers, 419 architects and engineers. The Institute has been equipped with advanced computers and other facilities. In the Institute, there are 5 comprehensive design departments, a housing design and research department, research unit, technology development unit and technical support department. It has established branch offices in Shenzhen, Xiamen, Hainan and Dalian and the interior design department of Tianshun Company Limited. In Hong Kong and joint venture design offices of Jianhus, Jialide and Jintian with companies of Japan, the United States and Hong Kong. It has some project designs in cooperation with foreign and Hong Kong architects and international technical exchanges and technical cooperation.

Its business scope includes city planning of specialized districts and city quarters, design of large public and civil build-

ings, interior design, designs of building stitcheries, water supply and drainage, gas, heating, Air-conditioning, telecommunication, lighting, power, underground projects; cost estimation, pre-tender estimate of building for construction projects, technical consultation, supervision of construction work, general contract, work quality inspection, application study of construction technology, development of new materials and equipments and computer and supervision personnel to foreign countries.

In the past ten years, 750 projects have been designed annually with total floor areas of 3500000 square meters. Since the founding of the Institute, the floor areas designed by the Institute are more than 110 million square meters. The followings are a few outstanding works; The People's Great Hall. The Cultural Palace of Nationalities, Beijing Hotel, Kunlun Hotel, Capital Hotel, Grand View Garden Hotel, Wuzhou Hotel, Jinfeng Building, Otani

Changfugong Center, China International Exhibition Center, Yanhuang Art Gallery, National Olympic Sports Center and the Asian Games Village, Beijing Western Railway Station, New Terminal Building of the Capital Air Port, Office Building of the All-China Women Federation, Tongren Hospital, Children School of the Foreign Trade Ministry, Enjili Residential Quarter, Morocco Sports Centre, Youth Centre of Tunis.

Since 1977, the Institute has won 23 National prizes, 47 Construction Ministry prizes and 89 Beijing Municipality prizes. It has accomplished 1763 research subjects on acoustics, lighting heating, power supply, fire resistance, earthquake resistance, energy saving and developed 67 items of new products and 81 items of computer software. Of these subjects and items, 35 has been awarded, National Scientific and Technical Progress Prizes, 38 Construction Ministry prizes and 105 Beijing Municipality Prizes.

As the design of the Asian

Games Project highlighted both the modern spirit and strong national characteristics and played an important role in holding the 11th Asian Games, the Institute has won favorable appraisals from experts both at home and abroad and won the ports Architecture Prize firstly established and issued by the International Olympic Committee in 1992, which was signed by the President of the International Olympic Committee, Juan-Antonio Samaranch.

In the spirit of "Unity, Contribution, Reality and Creation", the Institute attaches great importance to talented personnel, scientific research, technical information and equipments, quality management and excellent service. It will present "High level, High quality and High efficiency of work, More Achievements, Theories and Talented Personnel" and face the new era and the new world in the future.

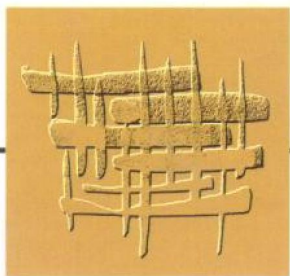

北京市建筑设计研究院简介

北京市建筑设计研究院（原名北京市建筑设计院）成立于1949年10月，是一个享有对外经营权的大型综合民用建筑设计、科研单位。1992年在由国家建设部、国家统计局和中国建设企业评价中心首次评出的“中国建筑施工企业、中国房地产开发企业和中国勘察设计公司综合实力百强”中，该院在民用建筑设计单位中名列第一；1995年，中国勘察协会对全行业省级以上设计科研单位五项指标（人均收入、人均税利、CAD绘图率、人均资产、获奖项目）综合评价及考核，该院列第一位；1993年10月北京市政府曾授予该院“首都建筑设计突出贡献设计研究单位”荣誉称号。

该院现有职工1240人，其中：技术干部1052人，有国家设计大师6名，高级建筑师、高级工程师289人，建筑师、工程师406人。该院

有一级注册建筑师106人，二级注册建筑师138人。并拥有先进的计算机设备、工作站以及相应的设施。院本部设有五个综合设计所，除住宅设计研究所外，还设有研究所、技术发展中心、科技处、技术供应所等机构，并在深圳、厦门、海南、大连等地设置了分院，在香港设有天顺有限公司室内设计部，与日本、美国、菲律宾和香港地区的一些公司合作，成立了“建华”、“佳利德”、“金田”等合资设计公司，还与国外和香港地区的一些建筑师开展了项目合作设计，不断扩展国际间的技术交流与合作。

该院业务范围包括：城市设计、专用地段及小区规划、大型公共与民用建筑设计、室内设计；建筑结构、给水排水、煤气、热力、供暖、空调节、电讯照明、动力、地下工程等方面的工程设计；工程概预算、建筑招标准底编制、技术咨询、

监理、总承包、工程质量检测以及工程技术应用研究、新材料和新设备的开发、计算机软件开发等；同时承接建筑设计业务，对外派遣本部门的设计、咨询和监理劳务人员。该院设计近十年能力平均数为：每年完成设计项目750多项，建筑面积达350余万平方米。从1949年成立到现在约48年中，累计完成设计面积1.1亿平方米。代表作品有：人民大会堂、民族文化宫、北京饭店、昆仑饭店、首都宾馆、大观园酒店、五洲大酒店、金丰大厦、长富宫中心、中国国际展览中心、炎黄艺术馆、国家奥林匹克体育中心及亚运村、北京西客站、首都机场新航站楼、全国妇联办公楼和妇女活动中心、同仁医院、经贸部职工子弟学校、方庄居住区、恩济里小区、摩洛哥体育中心、突尼斯青年之家等。

从1977年以来，设计获国家奖的有23项，获建设部奖的有47项，获北京市奖的有89项。

完成声、光、热、电、消防、抗震、节能等研究课题1763项，开发新产品67项，开发计算机软件81项。科研获国家科技进步奖的有35项，获部科技进步奖的有38项，获北京市科技进步奖的有105项。

该院因亚运工程设计具有强烈的时代精神和鲜明的民族特色及为成功地举办第11届亚运会起到了重要作用，同时受到国内外有关专家的好评，并获得1992年国际奥委会首次设立及颁发的由国际奥委会主席萨马兰奇签名的“体育建筑奖”。

该院从“团结、奉献、求实、创新”的精神出发，重视人才，重视科研，重视技术信息，重视技术设备，重视质量管理，重视优质服务，并以“高水平、高质量、高效益、出成果、出理论、出人才”为目标，面向时代，面向世界，迎接未来。

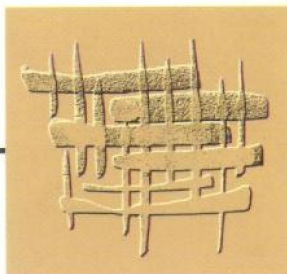

栋梁集 I 《北京市建筑设计研究院作品选》1949~1996

内容提要

《北京市建筑设计研究院作品选》一书由北京市建筑设计研究院与贝思出版有限公司及中国计划出版社共同编辑出版。

北京市建筑设计研究院是我国规模大、实力强的民用建筑设计研究院。自1949年成立以来，作品遍及北京大地、中国的东西南北，在海外也有作品耸立。

本书重点介绍了设计院近十年的获奖作品，80年代以前的作品点到为止。内容包括城市设计与小区规划、住宅、医疗院、办公楼、综合商厦、宾馆、学校、体育馆、剧院、博览馆等近百项建筑的概况、室内外景观等。该书近308页，共展示精美图片612幅。设计图纸188张，中、英文对照，特大16开本彩色印刷。

本书可供建筑设计、研究、教学等有关人员参考。

编辑委员会主任：吴德绳

副主任：赵景昭、何玉如、李铭陶、陈杰

主编：林达生、吴竹涟、管健、

编辑：廖淑勤、索之娣

翻译：刘河

摄影：杨超英、刘锦标

封面：南京新百大厦 作者：刘力

图书在版编目(CIP)数据

北京市建筑设计研究院作品选：栋梁集 I/北京市建筑设计研究院等主编。—北京：中国计划出版社，1997·4

ISBN 7-80058-569-7

I. 北… II. 北… III. 建筑设计-作品集-北京 IV. TU 207

中国版本图书馆CIP数据核字(97)第06435号

栋梁集 I 《北京市建筑设计研究院作品选》1949~1996

出版

中国计划出版社

地址：北京市西城区月坛北小街2号3号楼

邮政编码：100837 电话：(010) 68580048

贝思出版有限公司

地址：香港柴湾嘉业街18号明报工业中心B座607-8室

电话：(852) 28971688

发行

各地新华书店发行

设计制作及电分

广州贝思广告制作电分有限公司

(020) 86578290

广州金羊彩印有限公司印刷

850 X 1168毫米 1/16 印张19 100千字 印数 1~4000册

1997年5月第一版 1997年5月第一次印刷

ISBN 7-80058-569-7 / TU-34

定价：280元

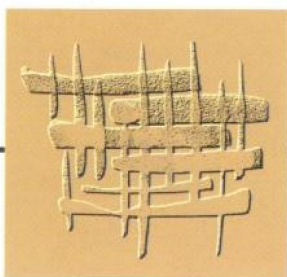

目录

会堂、博览建筑	7
办公写字楼	45
宾馆建筑	83
教育建筑	159
体育、演艺建筑	189
公寓、住宅建筑	222
医疗建筑	251
交通、商业工业建筑	261
室内设计方案	277
建筑设计方案	286
城市设计、小区规划	301

人民大会堂	8
THE GREAT HALL OF THE PEOPLE	
中国历史、中国革命博物馆	12
MUSEUM OF CHINESE REVOLUTION AND CHINESE HISTORY	
毛主席纪念堂	14
CHAIRMAN MAO'S MEMORIAL HALL	
中国人民革命军事博物馆	16
THE CHINESE MILITARY MUSEUM	
炎黄艺术馆	20
YAN HUANG ART GALLERY	
民族文化宫	22
THE CULTURAL PALACE OF THE NATIONALITIES	
北京青年宫	24
BEIJING YOUTH PALACE	
北京动物园大熊猫馆	28
THE PANDA HOUSE OF BEIJING ZOO	
潘天寿纪念馆	30
PAN TIANSHOU MEMORIAL MUSEUM	
北京建材经贸大厦	32
THE EXHIBITION HALL OF THE BUILDING MATERIALS TRADE CENTER	
北京天文馆	36
BEIJING PLANETARIUM	
中国国际展览中心 2-5 号馆	38
HALLS NO. 2-5 OF CHINA INTERNATIONAL EXHIBITION CENTRE	
突尼斯青年之家	40
YOUTH'S CENTRE OF TUNIS	

会堂

博

览

建

筑

人民大会堂

THE GREAT HALL OF THE PEOPLE



位于北京天安门广场, 建筑面积 171,000 平方米, 1959 年建成。建筑南北长 336 米, 东西宽 206 米, 高 46.5 米, 四周入口由 134 根直径 2 米的柱廊组成, 进东门经过中央大厅, 通向有 3 层共 1 万座席的大会堂, 进北门经交谊大厅和汉白玉的大楼梯, 通向可容 5,000 座席的宴会厅, 进南门为人大常委会办

公楼, 有接待厅、大小会议室、办公室和休息室等, 整个会堂拥有 300 多个厅室, 其中以各省、市、自治区命名, 室内装修和陈设具有地方特色的大厅约 30 个, 大会堂装有调节室内温湿度的设备和广播、电视、扩音译意风及拍摄电影的固定照明等设备。

This project completed in 1959, is at Tiananmen Square and has a total floor area of 171,000 square meters. Its north-south length is 336 M, east-west width 206 M, building height 46.5 M, Colonnades with 134 columns of a diameter of 2 M are at the entrances of

the 4 sides. The east entrance leads to the 3 - level 10,000 - seat auditorium through central lobby. The north entrance leads to the 5,000 - seat banquet hall through friendship hall and white marble grand stair. The south entrance leads to the office block of the standing com-



mittee of the people's Congress with offices, conference rooms, reception and lobbies. The 300 or more halls are named respectively with the titles of the provinces, cities and autonomous regions and 30 of them are decorated and furnished in different local styles.

Temperature, humidity, sound, TV, interpretation, camera and lighting control systems have been installed.



中央大厅



中央大厅

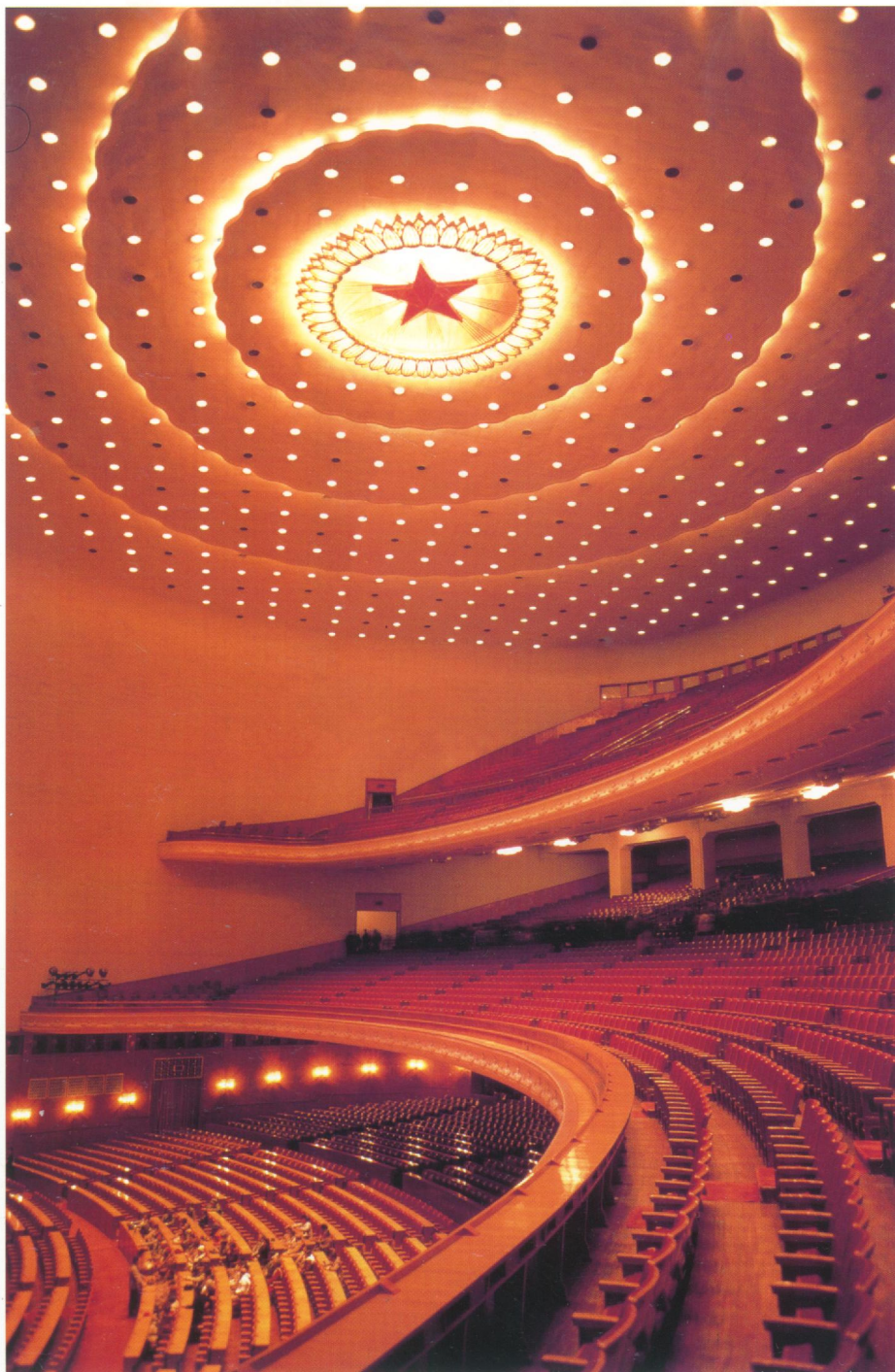

万人大会堂



迎宾厅



东大厅

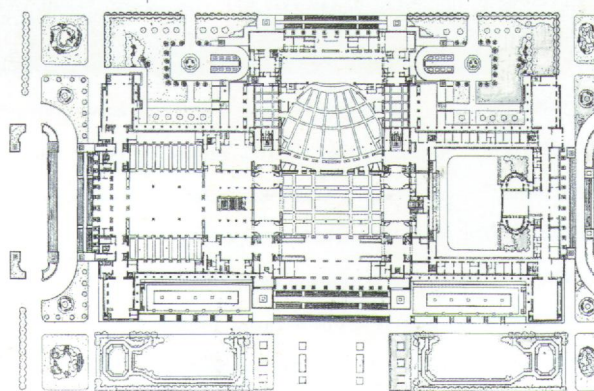

工程地点 : 北京天安门广场
 竣工日期 : 1959 年
 建筑面积 : 17 万平方米
 Location : Beijing Tiananmen Square
 Completion : 1959
 Floor area : 170,000M²

中国历史、中国革命博物馆

MUSEUM OF CHINESE REVOLUTION AND CHINESE HISTORY



位于天安门广场，用地9.2公顷，建筑面积65,152平方米，1959年建成。设计采用内院式布局，三个内院构成“四”字形平面，南为历史博物馆，北为革命博物馆，中部为门厅、中央大厅、陈列馆及有700座席的礼堂。主体建筑3-4层，陈列面积23,472平方米，可同时容纳10,000人参观。

This project with a total floor area of 65,152 square meters on a site of 9.2 hectares was completed in September 1959. Exhibition halls are arranged around three inner courts. The History Museum is in the south, the Revolution Museum the north, the entrance and central lobbies, exhibition halls and 700 - seats auditorium the centre. A total exhibition area of 23,472 square meters

accommodates 10,000 visitors at the same time. The main building has 3 - 4 storeys .

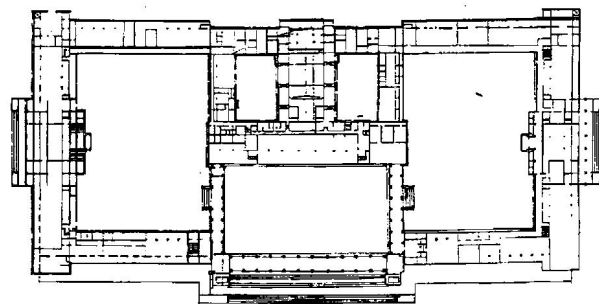

工程地点 : 北京天安门广场
 竣工日期 : 1959 年
 建筑面积 : 65152 平方米
 Location : Beijing Tiananmen Square
 Completion : 1959
 Floor area : 65,152M²



展室



毛主席纪念堂

CHAIRMAN MAO'S MEMORIAL HALL



位于北京天安门广场，1977年建成。纪念堂为方形建筑，下部为边长105.5米，高4米的双层花岗石基座及汉白玉栏杆，中部是每边11开间的柱廊，上部为黄色琉璃平板的重檐屋顶，总高度33.6米。纪念堂主要由南、北大厅和瞻

仰厅、休息厅组成。1983年在休息厅增加了毛泽东、周恩来、刘少奇、朱德革命业绩纪念室。本工程是在八个省市设计人员所提建筑方案的基础上，由北京市建筑设计研究院和有关单位组成规划设计组共同完成的。

Chairman Mao's Memorial Hall was completed in 1977 and is in square layout. This memorial building has a double-tiered granite base with a boundary of 1,055 meters and a height of 4 meters decorated with white

marble balustrades. An 11-bay colonnade embellishes each of the four sides. The double-leave roof is decorated with yellow glazed tiles. The total building's height is 33.6M. This Memorial Hall consists of a north hall, a



south hall, a central homage hall and parlors. The parlors were renovated to exhibition rooms for the revolutionary deeds of Mao Ze-dong, Zhou En-lai, Liu Shao -qi and Zhu De in 1983. The project was co -designed by

the Institute and other units on the basis of the architectural proposal submitted by designers from 8 provinces and cities .



工程地点 : 天安门广场
竣工日期 : 1977 年
建筑面积 : 28225 平方米
Location : Tiananmen Square
Completion : 1977
Floor area : 28,225M²



中国人民革命军事博物馆

THE CHINESE MILITARY MUSEUM



位于北京复兴门外大街，占地8.04公顷，建筑面积60,557平方米，1959年建成。建筑物平面呈“山”字形，中间为30米见方的中央大厅，两侧设有大小陈列室10个，兵器馆、电影厅各1个，另有2个露天陈列场。正面采取渐次升

高的立体形，全部墙面呈花岗岩色，屋檐部分用金黄色琉璃饰面，屋顶竖立直径6米的军徽标志，总高度97.47米，整个建筑给人以庄严、挺拔的感觉。

This project, occupying a site of 8.04 hectares and located on Fuxingmenwai Avenue has a total floor area of 60,557 square meters. The ground floor is in "E" shape layout. The central hall, 30 M x 30 M, is flanked

by 10 exhibition halls of various sizes, a cinema and two exhibition courts. Granite is used on the elevations and yellow glazed tiles on the eaves. A symbol of the military emblem of a diameter of 6 m is erected