

ALCORNES  
JRZANST  
IULIANE  
ENVICIN

图书在版编目(CIP)数据

2011欧博设计/ 法国欧博建筑与城市规划设计公司,  
深圳市欧博工程设计顾问有限公司编著. —北京: 中国建筑  
工业出版社, 2012.3

ISBN 978-7-112-14087-9

I. ①2··· II. ①法··· ②深··· III. ①建筑  
设计—作品集—中国—现代 IV. ①TU206

中国版本图书馆CIP数据核字(2012)第032064号

责任编辑: 常燕 袁瑞云

## 2011欧博设计

法国欧博建筑与城市规划设计公司

深圳市欧博工程设计顾问有限公司 编著

\*

中国建筑工业出版社出版、发行(北京西郊百万庄)

各地新华书店、建筑书店经销

AUBE 欧博设计制版

深圳市国际彩印有限公司印刷

\*

开本: 787×1092毫米 1/12 印张: 22 字数: 536千字

2012年3月第一版 2012年3月第一次印刷

定价: 238.00元

ISBN 978-7-112-14087-9

(22133)

版权所有 翻印必究

如有印装质量问题, 可寄本社退换

(邮政编码 100037)

**2011 AUBE**

# 前言

## PREFACE

### 渐渐地顿悟

西藏，拉萨，大昭寺前，晨曦里，香火中，一汉子向着大殿，下跪、扑身、五体投地、起身，一气呵成。他在与佛祖对话？在与自己对话？这是宗教吗？我迷惑。

法国，朗香教堂，2003年一场大雪后，一位日本建筑学学生站在雪地里，顺着雪一样白的墙面，仰头望向屋顶。他在寻找？在圆梦？

西班牙，毕尔巴鄂，2005年春，我按图索骥，寻找改变了这个城市的那座建筑，“这条街右转直走就到了”，转向，一瞬间我看到了那个天外来客……我究竟在找什么？

深圳，某写字楼会议室，2006年夏，业主咆哮，问责，攻击，泄愤。是我们不负责？不用心？不努力？还是我们在坚持什么？

深圳，某餐厅，同学聚会中，“某某当年不怎样吧，人家现在……”“你早该出来自己做……”

……我问我自己，他们说的是我想要的？不止吧？

深圳，生态广场C栋，2011年某晚，众人加班，刚完成了一张草图的我点支烟，侧头看看自己的团队，他们为项目？为家？为什么？

西藏，拉萨，大昭寺前，八廓街上，我又看到了那个汉子，众人中面目祥和，眼神安定坚毅。忽然想起一位朋友的话：执着于自己的梦想，就是信仰。执着于自己的信仰，就是宗教。

欧博设计  
设计董事 杨光伟

## THE JOURNEY TO INSIGHT

Jokhang Temple, Lhasa, Tibet. It was a dawn with burning incense. Facing the main hall, a man kneeled down, prostrated and got up at one stretch. Was he conversing with Buddhist or himself? Was that religion? I was confused.

Chapelle de Ronchamp, France. It was in 2003 and had just snowed heavily. A Japanese architecture major stood in snow and looked over snow-white walls and up the roof. Was he looking for something? Was he interpreting a dream?

Bilbao, Spain. It was in the spring of 2005. Following a map, I tried to find the building that had changed the city. I walked along the street and turned right, as I was told. And the heavenly building came right into sight. What on earth was I looking for?

A conference room of an office building in Shenzhen. It was in the summer of 2006. Proprietors were shouting, complaining, blaming and venting their resentment. Were we irresponsible? Did we not try our best? Or were we just persisting in something?

A restaurant, Shenzhen. It was a classmate reunion. "That guy seemed not promising back then, but now ....." "You should have become self-employed long ago.....".....I asked myself whether what they talked about was what I wanted? Or was there more?

Building C of the Ecological Plaza, Shenzhen. It was a night in 2001 and employees were overworking. Having finished a draft, I lighted a cigarette and then looked at my team. Were they working so hard for projects, for their family or for something else?

Jokhang Temple, Lhasa, Tibet. On the Barkhor Street, I met the man once again. He was calm, firm and peaceful among crowds, which reminded me of what one friend had told me---faith is to persist in one's dream and religion is to persist in one's faith.

**AUBE Conception**  
**Design Director: Yang Guangwei**

# 目录

## CONTENTS

### ZHONGTIAN · FUTURE ARK, GUIYANG 贵阳中天·未来方舟

贵阳中天·未来方舟A区文化活动中心建筑及景观设计 Architectural and Landscape Design of The Culture Center of Zhongtian · Future Ark, Guiyang	008
贵阳中天·未来方舟样板房建筑设计 Architectural Design of the Show Flat of Zhongtian · Future Ark, Guiyang	018
贵阳中天·未来方舟F3地块建筑设计 Architectural Design of The Lot F3 of Zhongtian · Future Ark, Guiyang	024
贵阳中天·未来方舟-东懋中心建筑设计 Architectural Design of the Dongmao Center of Zhongtian · Future Ark, Guiyang	032

### URBAN PLANNING 规划

三亚万科湖心岛修建性详细规划及建筑方案设计 Detailed Planning and Architectural Design of Vanke Center Island Project in Sanya	040
深圳盐田翡翠岛项目规划、建筑及景观设计 Planning, Architectural and Landscape Design of the Feicui/Jade Island, Yantian, Shenzhen	048
唐山湾国际游艇社区项目概念方案规划设计 Planning Design of the International Yacht Community of Tangshan Wan	054
苏州太湖国家旅游度假区东入口地区城市设计 Urban Design of the East Entry of Taihu-Lake International Tourism Zone, Suzhou	060
深圳湾生态科技城B-TEC项目规划及建筑方案设计 Planning & Architectural Design of B-TEC City of Shenzhen Bay	068
长城笋岗城市综合体规划及建筑概念方案设计 Planning & Architectural Design of the Great-wall Complex Building In Sungang, Shenzhen	084
浙江省余杭高新技术产业园区科技园一期工程规划及建筑设计 Planning & Architectural Design of the Yuhang High-tech Industry Park (phase I), Zhejiang	088
杭州转塘(1-C2-03地块)项目规划及建筑设计 Planning & Architectural Design of the Lot 1-C2-C3 of Zhuantang Area, Hangzhou	094

### ARCHITECTURE 建筑

深圳市塘朗车辆段A区建筑概念方案设计 Architectural Design of the Parcel A of Tanglang Rolling Stock Depot, Shenzhen	102
南海会馆概念性建筑设计 Architectural Design of The South Sea Memorial Hall, Foshan	106
百度国际大厦建筑设计 Architectural Design of Baidu International Tower	110

深圳市侨城北工业区升级改造工程建筑设计 Architectural Design of the Upgrading & Renewal Project of the Industrial Park in the North of Oct, Shenzhen	116
城建观澜仁山智水花园天际会所建筑设计 Architectural Design of The Horizon Club of Expander The Garden of Benevolence & Wisdom, Shenzhen	122
中铁南方总部大厦建筑设计 Architectural Design of the Crsid Tower	126
昆明滇池湖岸花园项目建筑设计 Architectural Design of the Dianchi Lakeside Residence, Kunming	130
国家(青岛)通信产业园1、2、3号地块规划、建筑、景观方案设计 Planning, Architectural & Landscape Design of the Plots 1/2/3 of the Communication Industry Park of Qingdao	136
阿里巴巴深圳大厦建筑概念方案设计 Architectural Design of Alibaba's Branch Tower in Shenzhen	140
深圳市宝安区新安宝城34区改造项目建筑设计 Architectural Design of the Renewal Project of the 34 <sup>th</sup> Block of Bao'an District, Shenzhen	146
深圳职业技术学院西校区综合楼工程建筑设计 Architectural Design of the Multiple-use Building in the West Campus of Shenzhen Polytechnic	150

## LANDSCAPE 景观

无锡地铁1号线胜利门站广场景观方案征集 Landscape Design of the Victory Gate Station Square of Wuxi Metro Line 1	158
无锡地铁1号线出入口、风亭外观景观效果及下沉广场景观方案征集 Landscape Design of The Exit of Wuxi Metro Line 1, Its Wind Pavilion and Sunken Square	168
贵阳云岩渔安安井回迁安置居住区D组团景观设计 Landscape Design of the Group D of the Relocation Residential Area in Anjin, Yuan, Yunyan, Guiyang	178
贵阳规划展览馆景观设计 Landscape Design of Guiyang Planning Exhibition Hall	186
昆明滇池湖岸花园桂园中心花园 Landscape Design of the Osmanthus Central Garden of the Dianchi Lakeside Residence, Kunming	190
深圳南海中学景观方案设计 Landscape Design of Nanhai (South Sea) Middle School, Shenzhen	196
贵阳民族盛会广场景观方案设计 Landscape Design of the National Minorities Festival Square in Guiyang	200







# ARCHITECTURAL

## AND LANDSCAPE DESIGN OF THE CULTURE CENTER OF ZHONGTIAN · FUTURE ARK, GUIYANG

### 贵阳中天·未来方舟A区文化活动中心建筑及景观设计

#### ARCHITECTURAL DESIGN 建筑设计

Under the enlightenment of Zhongtian's corporate culture that the present is the future and taking the basic functions of a sales center, this project is meant to introduce and promote Yu'an to clients. Organically, the culture center is divided into three sections which form the following sequence (cloud box-rock box-magic box) in the transition from the present to the future. The transparent shell of the culture center submerged in mist and cloud, As a time tunnel supported by independent structure, cloud offers visitors with various sensory temptations and leads them to the second part of the sequence - the rock box, where they experience astonishing high technology. The whole visit will reach its peak at global screens. In the end, magic box, which contains the near future, shows visitors Zhongtian's corporate image and the beautiful future home.

“现在就是未来”是中天的企业文化。受其启发并结合销售中心的基本诉求，项目向客户展示渔安并达到推广之目的。文化活动中心有机分散为三个体量，形成了由“现实向未来”过渡的三个序列：cloud box-rock box-magic box。透明的外壳裹绕着轻舞的云雾，包裹着若隐若现的cloud，cloud作为独立结构支撑的时光隧道，让游客经历过各种感官的诱惑之后，进入rock box来到第二个建筑序列，这里包含了震撼的高科技体验，并在环球影幕处达到游艺的高潮。最后，magic box 销售中心，容纳了触手可及的未来，向游客展示着中天的企业形象，未来的美好家园。

#### LANDSCAPE DESIGN 景观设计

First, the project carries forward the building's design principle, strengthening its design concept and establishing the relations between the building and its surrounding water.

The soil, dug from mountains in the west of the culture center, will be used to form a hill on its south. The water will be led to the culture center to form a mirror-like pool. In this way, water systems in the culture center will have a visual and conceptual source.

Second, establishing relations between the building and land

Landscape water systems will be connected through such landscaping factors as cascades and lake views so as to form a recyclable whole.

Third, ecology and sustainability

Native plants are used to create wetland landscape and strengthen water's self-purification. And a great importance is attached to the original ecological landscape and environmental sustainability.

延续建筑的设计原理、强化建筑设计概念，并建立联系：

延续建筑被水包围的宏伟气势。从文化活动中心东侧山体挖出的土方量填充至文化活动中心南侧塑造山体，并引水至文化活动中心形成镜面水体，为其水系从视觉和概念上找到源头。

建立建筑、地块之间的联系：

通过叠水、湖景等景观要素使景观水系相互连接和流动，文化活动中心水系成为一个可循环的整体系统。

生态及可持续性：

运用原生植物，营造湿地景观，强化水体自净功能，注重原生态景观和环境持续性发展。

Client : Guiyang Real Estate Development Co. Ltd. of Zhongtian  
Urban Development Group

Location : Yunyan District, Guizhou

Land area : 7.2ha

Building area : 21 000 m<sup>2</sup>

Landscape area : 60 000 m<sup>2</sup>

Height : 21.2m

Function : sales center

Under construction

客 户 : 中天城投集团股份有限公司

位 置 : 贵阳市云岩区

用地面积 : 7.2hm<sup>2</sup>

建筑面积 : 2.1万m<sup>2</sup>

景观面积 : 6万m<sup>2</sup>

建筑高度 : 21.2m

主要功能 : 销售中心

在建项目

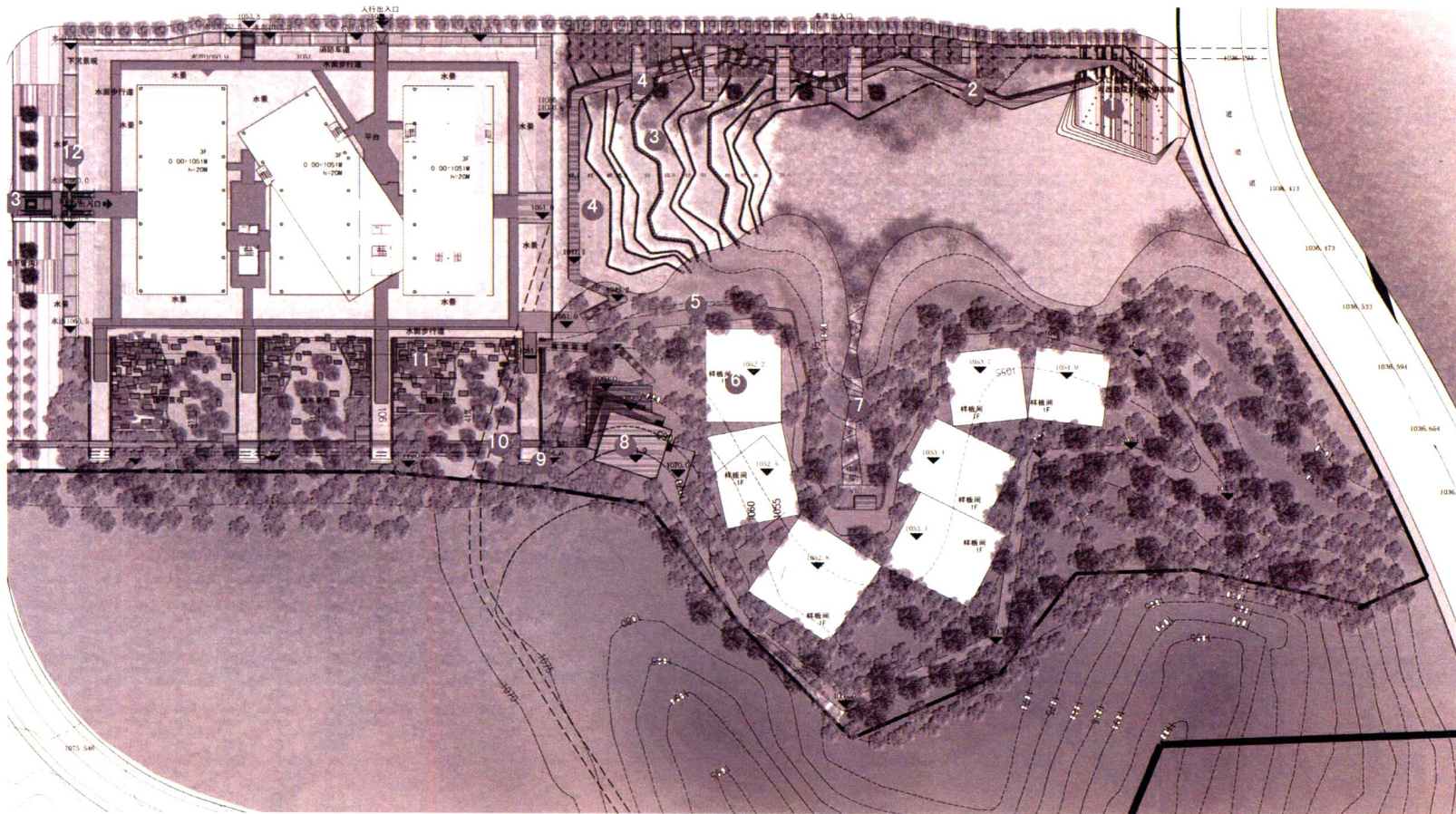





夜景效果图





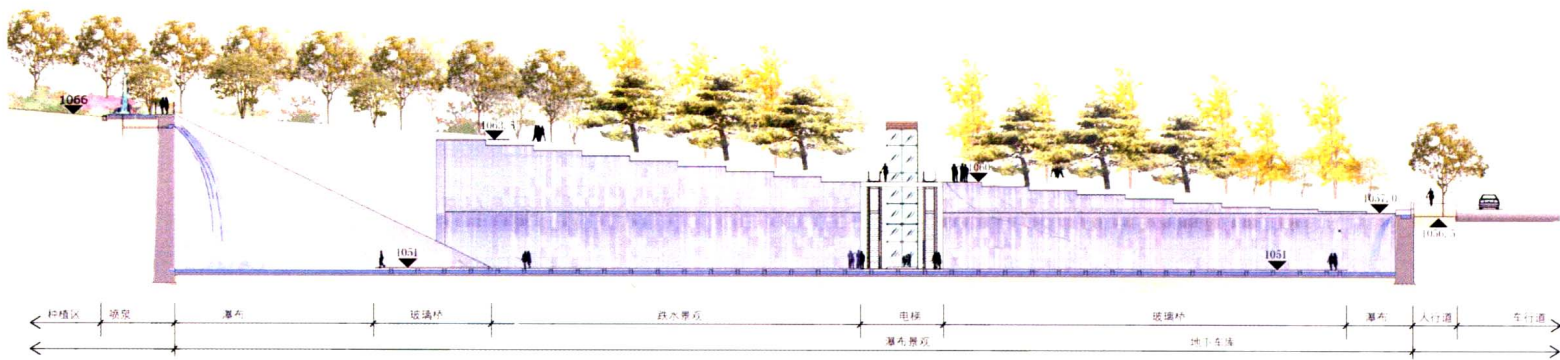

瀑布景观剖面 1:350

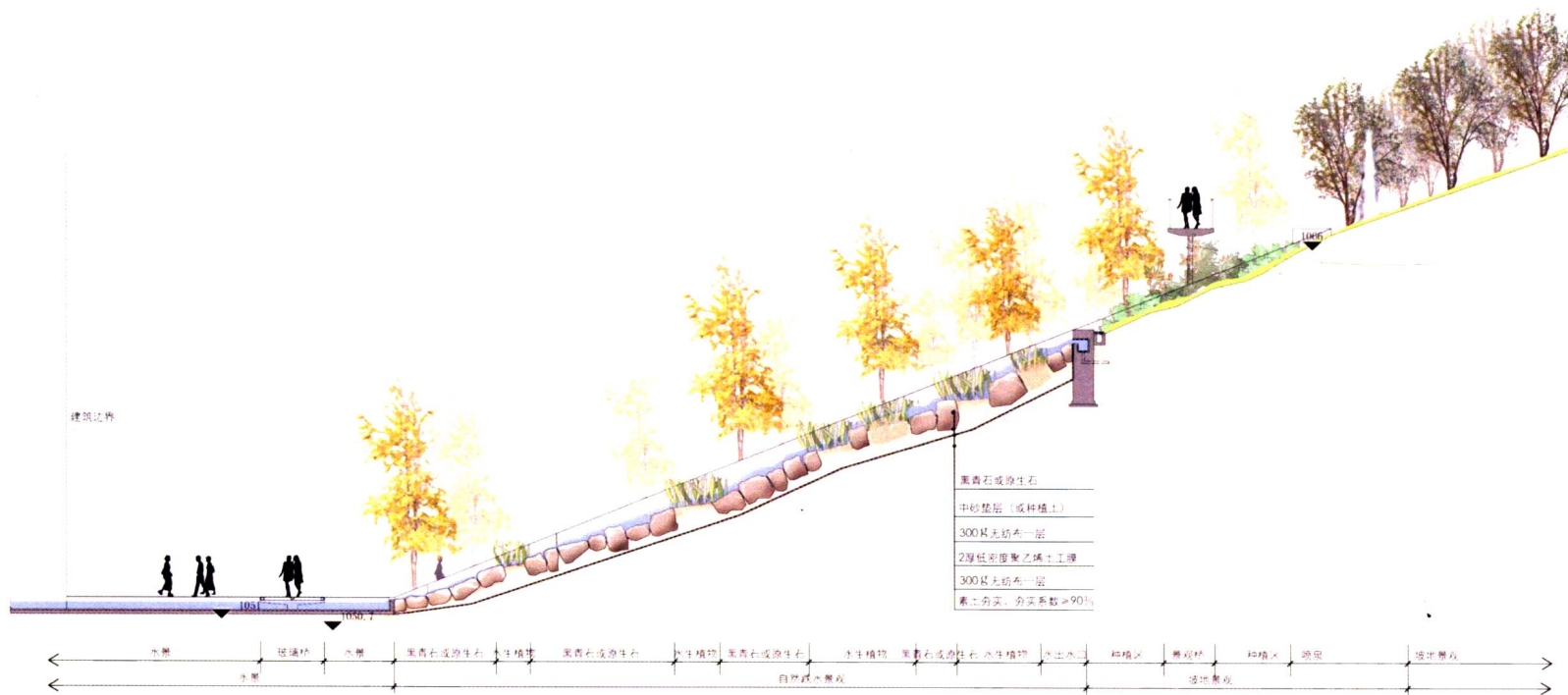

原生石跌水剖面 1:150



