

地 产生

样板房·售楼处·酒店

营销空间

REAL ESTATE

MARKETING SPACE

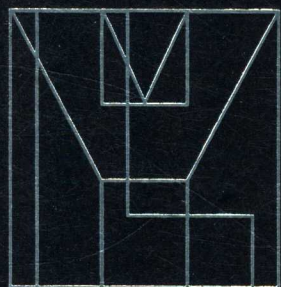

Y·L·H 室内设计作品

Y·L·H 室内设计作品

地產

样板房·售楼处·酒店

营销空间

REAL ESTATE

MARKETING SPACE

張雲 張浪 張懷 著

中國輕工業出版社



全國百佳圖書出版單位

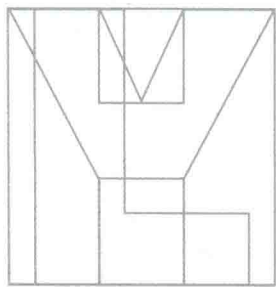

Y·L·H 室內設計作品

图书在版编目 (CIP) 数据

地产营销空间 / 张云, 张浪, 张怀著. -- 北京:
中国轻工业出版社, 2014.1

ISBN 978-7-5019-9534-9

I. ①地… II. ①张… ②张… ③张… III. ①房地产
- 市场营销学 IV. ① F293.35

中国版本图书馆 CIP 数据核字 (2013) 第 272507 号

责任编辑 毛旭林 责任终审 劳国强
装帧设计 赵 茹 责任监印 胡 兵 张 可

出版发行 中国轻工业出版社 (北京东长安街 6 号)
邮 编 100740
印 刷 北京顺诚彩色印刷有限公司
经 销 各地新华书店
版 次 2014 年 1 月第 1 版第 1 次印刷
开 本 889 × 1194 1/16
印 张 19
字 数 210 千字
书 号 ISBN 978-7-5019-9534-9
定 价 198.00 元

邮购电话 010-65241695
传 真 010-65128352
发行电话 010-85119835 85119793
传 真 010-85113293
网 址 <http://www.chlip.com.cn>
E-mail club@chlip.com.cn
如发现图书残缺请直接与我社邮购联系调换
131220J2X101HBW

Contents 目录

01	北京观山悦B反别墅样板房 Beijing Guanshanyue B Against Villa Model Houses	010
02	重庆约克郡新古典样板房 Yorkshire County New Classic Model Houses in Chongqing City	024
03	唐山铂悦山售楼处 Tangshan Boyueshan Building Sales Office	046
04	重庆约克郡别墅英伦样板房 Yorkshire County Villa England Style Model Houses in Chongqing City	056
05	重庆长嘉汇E户型样板间 Changjiahui E Model Houses in Chongqing City	076
06	秦皇岛铂悦山售楼处 Qinhuangdao Boyueshan Building Sales Office	088
07	御河印象主题酒店 Yuhe Impression Theme Hotel	098
08	北京观山悦A别墅样板房 Beijing Guanshanyue A Mountain Villa Model House	112
09	秦皇岛润地青云新中式样板房 Qinhuangdao Rundiqingyun New Chinese Model House	126
10	保定未来城售楼处 Baoding City Future Capital Sales Office	136
11	北京香江花园现代简约别墅精装修样板房 Beijing Xiangjiang Contemporary and Contracted Garden Villa Model House	146
12	北京观山悦售楼处 Beijing Guanshanyue Sales Office	160
13	秦皇岛润地青云港式样板间 Qinhuangdao Rundiqingyun Hong Kong Style Example Room	170
14	秦皇岛黄金海岸海阔海公馆 Qinhuangdao Golden Coast Sea Broad Mansion	182
15	重庆长嘉汇C户型样板间 Chongqing Changjiahui C	194
16	天津科技广场售楼处 Tianjin Science and Technology Square Floor	204
17	北京观山悦A反别墅样板房 Beijing Guanshanyue A against villa Model House	214
18	秦皇岛戴河首岭样板房 Qinhuangdao Daiheshouling Model House	226
19	秦皇岛铂悦山新中式样板间 Qinhuangdao Boyueshan New Chinese Style of Model House	240
20	润地青云新古典样板间 Rundiqingyun New Classic Model House Room	252
21	秦皇岛铂悦山现代奢华样板间 Qinhuangdao Boyueshan Modern Luxury Model Room	264
22	秦皇岛铂悦山现代简约样板房 Qinhuangdao Boyueshan Contemporary and Contracted Model House	274

地產

样板房·售楼处·酒店

营销空间

REAL ESTATE

MARKETING SPACE

张云 张浪 张怀 著

中国轻工业出版社



全国百佳图书出版单位

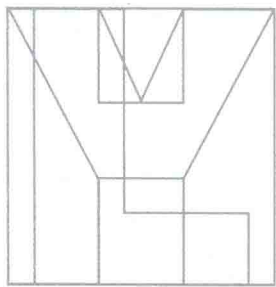

Y·L·H 室内设计作品

雲

The source of the design:
innovative ideas of Clouds and Fall papers

烟落紙的創意

是設計之源



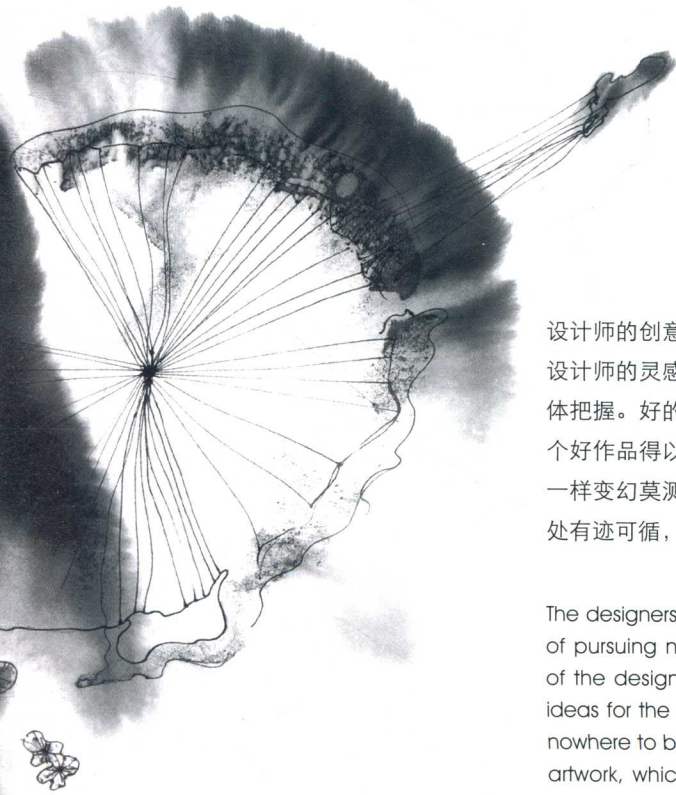

设计师的创意，不是简单的破陈除旧，更不是一味地求新立异。创意，常常来自设计师的灵感乍现，但它更来自设计师对项目立意的深入理解，对环境空间的整体把握。好的创意，无处可寻，却又无处不在；它是贯穿整个项目的灵魂，是一个好作品得以脱胎的源泉——就像高超玄妙的书法，挥毫间逸兴横飞，如同云烟一样变幻莫测、美妙多姿；待笔墨落纸，你就会发现，布局谋篇、起承转合，处处有迹可循，处处体现了作者独特的匠心。

The designers' ideas, is not a simple way of giving up the old issues, and not a way of pursuing new and different things. Creation, often comes from the inspiration of the designer, but it also sourced from the deep understanding of the project ideas for the designers, and the whole glimpse of the whole space. A good idea, nowhere to be found, but everywhere; it is the soul of the whole project, it is a good artwork, which was like the great mystery of calligraphy; in the whole, it was like unpredictable and wonderful clouds, for the ink and paper, you will find, organizing the handling down, there are telltale signs everywhere, and everywhere was embodied the author's unique craftsmanship.

浪

The soul of the design:
waves in the pursuit of Taosha

里淘沙的追求

是設計之本

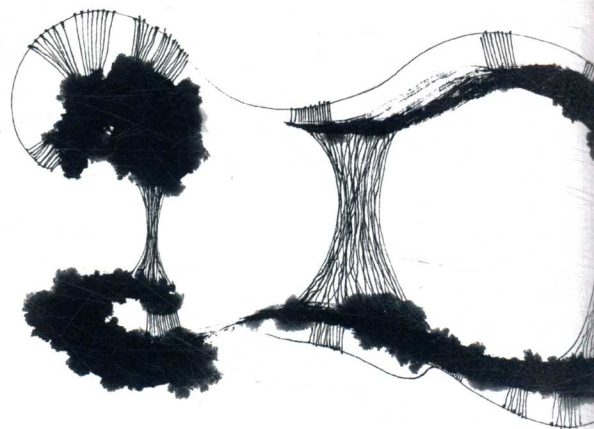

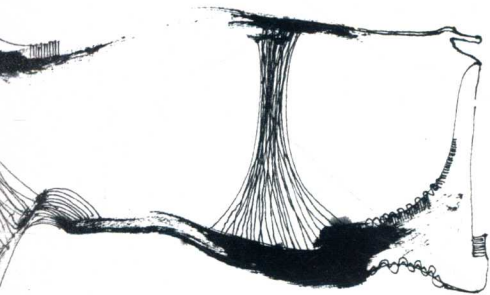

设计师的选择，往往有千万种；设计师的选择，又常常四目皆空。然而一张桌、一条椅，就能树立起一个房间的气质；一盏灯、一扇门，足以决定整个空间的风格。大元素、小细节，一个都不能马虎，不能随意地拼凑。所以设计，从来都不是凭空臆造，也不是简单的排列组合。唯有倾心追求，倾力搜罗，才能撷芳华于兰林之圃，择红玉于积珠之池，磨炼出佼佼佳作。

The choice of the designer, there are ten million species, and the designer's choice, and often four eyes are empty. However, a desk, a chair, you can set up the temperature of a room; a lamp, a door, enough to decide the style of the whole space. Elements, small details, anyone cannot careless, cannot piece together at random. So for the nature of design, is never something out of the thin air, also is not a simple combination. Pick only fall in love pursuit for, can be brilliant, and choose the ruby from pearl pool and practice for the anneal people.

怀

The top sense of the design:
pregnant with the Jin yu's insistence.

瑾握瑜的堅持

是設計之顛





我们的理想，是希望我们打造的每一个作品，能够让身处其中的每一个人都体验到快乐。为此，我们不断地挑战，不断地突破。取色彩变化，用线条肌理，采灯影光晕，凭物器摆设，跨越古典与现代，契合奢华与简约。不是没有遭遇瓶颈，也曾面临困境，但人文情怀的设计梦想，赋予了我们力量和信念。我们坚信，一个好作品，能受得住人们的评判，经得起时间的考验。时光淌过流年，铅华洗尽的，会是经典。

Our ideal, expect us to make every effort to make you a masterpiece, which can let everyone in space, experience the happy mood. To this end, we constantly challenge, constantly breakthroughs. Images in color changes, with line texture, adopt the halo, with content in decoration, crossing the classical and modern style, with luxury and contracted factors. Not a bottleneck and face difficulties, but the design of the humanity dreams, gives us strength and conviction. We firmly believe that a good work can live the good people of the judge, stand the test of the time. Time offered a year, it is still the Classic work of design.

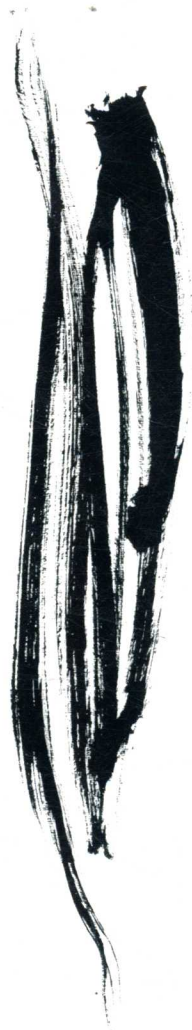

Contents 目录

01	北京观山悦B反别墅样板房 Beijing Guanshanyue B Against Villa Model Houses	010
02	重庆约克郡新古典样板房 Yorkshire County New Classic Model Houses in Chongqing City	024
03	唐山铂悦山售楼处 Tangshan Boyueshan Building Sales Office	046
04	重庆约克郡别墅英伦样板房 Yorkshire County Villa England Style Model Houses in Chongqing City	056
05	重庆长嘉汇E户型样板间 Changjiahui E Model Houses in Chongqing City	076
06	秦皇岛铂悦山售楼处 Qinhuangdao Boyueshan Building Sales Office	088
07	御河印象主题酒店 Yuhe Impression Theme Hotel	098
08	北京观山悦A别墅样板房 Beijing Guanshanyue A Mountain Villa Model House	112
09	秦皇岛润地青云新中式样板房 Qinhuangdao Rundiqingyun New Chinese Model House	126
10	保定未来城售楼处 Baoding City Future Capital Sales Office	136
11	北京香江花园现代简约别墅精装修样板房 Beijing Xiangjiang Contemporary and Contracted Garden Villa Model House	146
12	北京观山悦售楼处 Beijing Guanshanyue Sales Office	160
13	秦皇岛润地青云港式样板间 Qinhuangdao Rundiqingyun Hong Kong Style Example Room	170
14	秦皇岛黄金海岸海阔海公馆 Qinhuangdao Golden Coast Sea Broad Mansion	182
15	重庆长嘉汇C户型样板间 Chongqing Changjiahui C	194
16	天津科技广场售楼处 Tianjin Science and Technology Square Floor	204
17	北京观山悦A反别墅样板房 Beijing Guanshanyue A against villa Model House	214
18	秦皇岛戴河首岭样板房 Qinhuangdao Daiheshouling Model House	226
19	秦皇岛铂悦山新中式样板间 Qinhuangdao Boyueshan New Chinese Style of Model House	240
20	润地青云新古典样板间 Rundiqingyun New Classic Model House Room	252
21	秦皇岛铂悦山现代奢华样板间 Qinhuangdao Boyueshan Modern Luxury Model Room	264
22	秦皇岛铂悦山现代简约样板房 Qinhuangdao Boyueshan Contemporary and Contracted Model House	274

BEIJING GUANSHANYUE B AGAINST VILLA MODEL HOUSES

北京观山悦B反别墅样板房

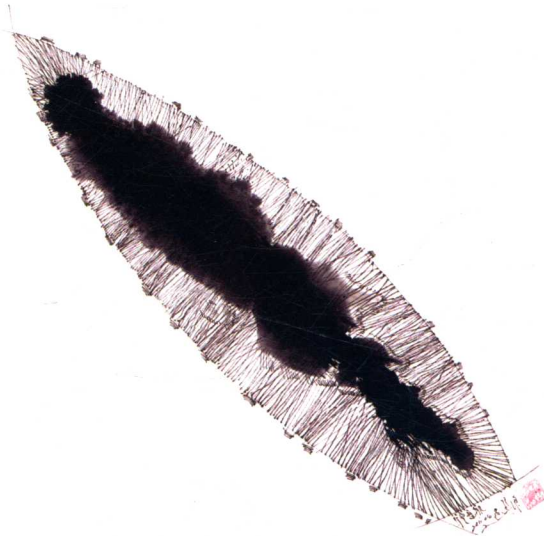

Project name: Beijing Guanshanyue B against Villa model houses

Developer: Beijing Tech-Park Construction (Group) Ltd
Construction area: 450 square meters

Using material: grey wood stone, brilliantly coloured purple stone, oak veneer, senior wallpaper, leather, metal, carve patterns or designed on woodwork, singeing brown stone, deep Hang stone, Grey Coloured glass, manual coloured drawing or pattern, senior paint, senior real wood floor

Project location: Beijing

Design time: March, 2012

项目名称: 北京观山悦B反别墅样板房

开发商: 北京科技园建设(集团)股份有限公司

建筑面积: 450m²

使用物料: 灰木纹石材、幻彩紫石材、橡木饰面、高级壁纸、皮革、金属雕花、烧毛石材、深杭啡石材、灰茶镜、手工彩绘、高级涂料、高级实木地板

项目地点: 北京

设计时间: 2012年3月

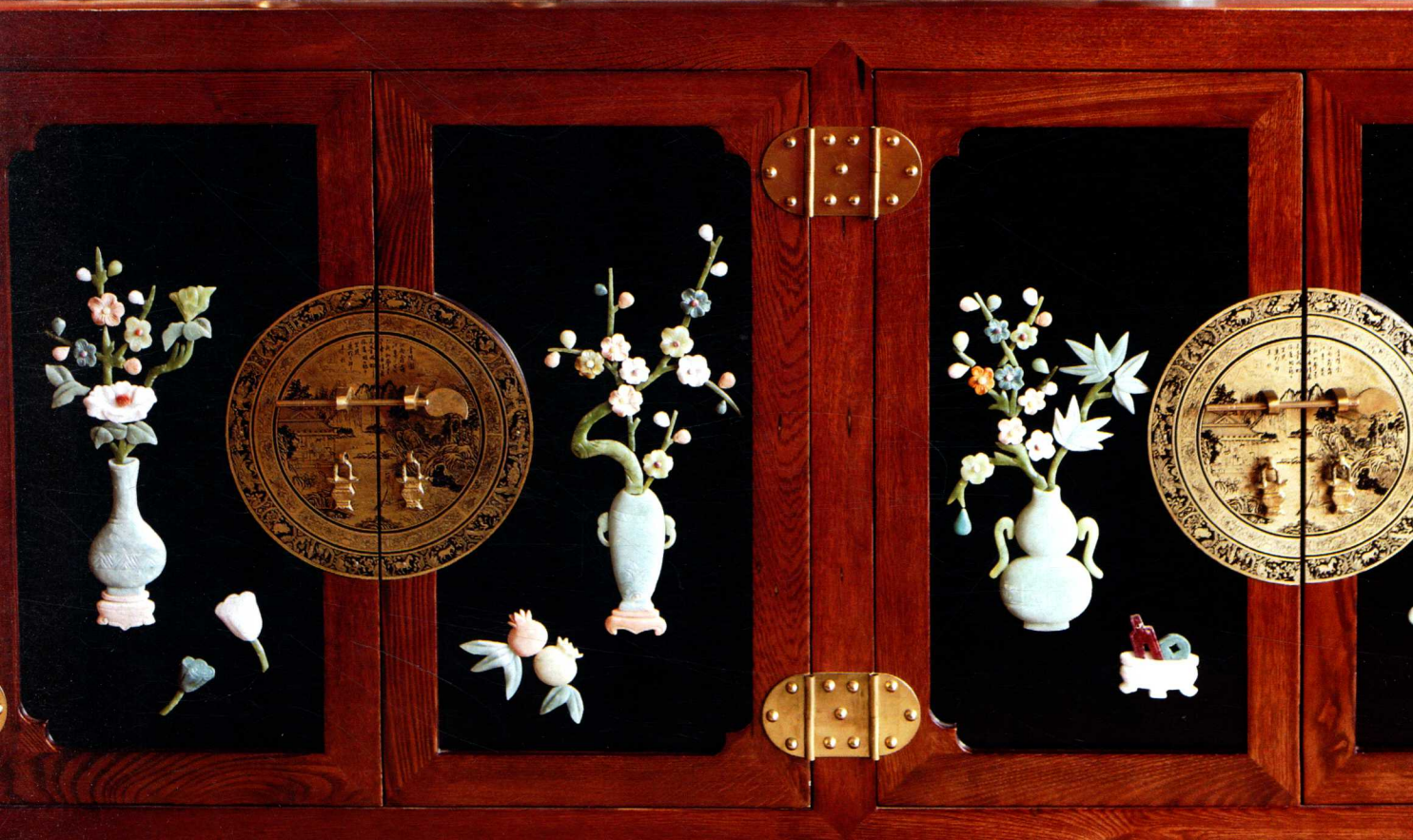
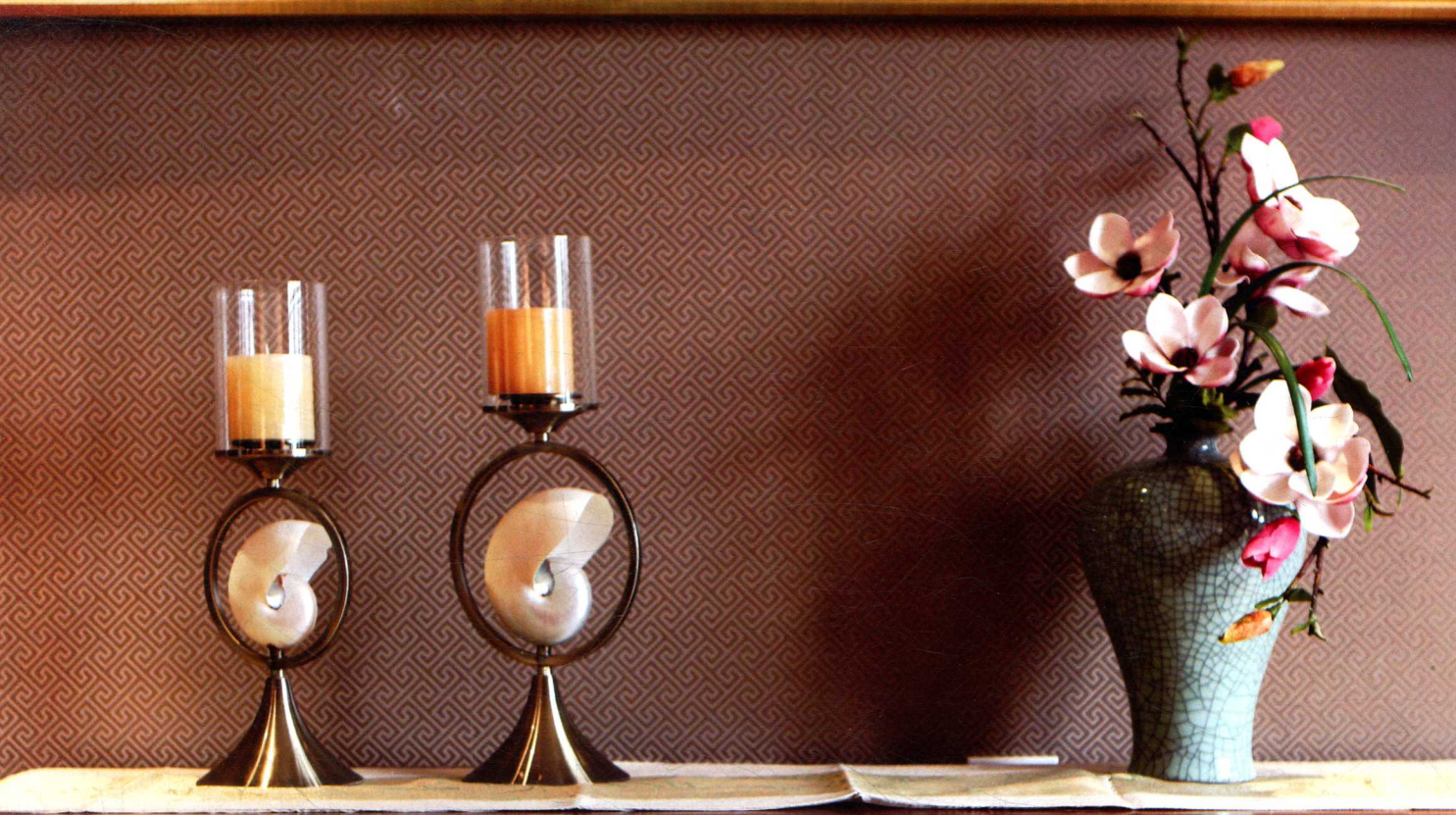



观山悦地理位置得天独厚，北观山景，南沐阳光。本案是面积450多平方米的大户型别墅样板房。设计师以深厚的中国文化为底蕴，融入现代化的创意，使整个空间在沉稳内敛的中式外表下，不乏温婉纤丽的点缀，呈现出优雅的高贵气质。

餐厅使用了木纹石材铺贴造型，结合深色木饰面金属圈边，古朴而不失时尚。

走廊及过道的创意取自中国传统的窗格式拼花。在设计师的精心排列下，抽象的花型，一路优雅地绽放，给每一个步入别墅的人带来轻松愉快的心情。

客厅以深咖色为主，搭着暗灰与茶色，诠释了中式风的庄重典雅。花格配上镜面，则让整个空间的线条变得生动。浅色的地面，金色的靠枕，为原本沉稳的客厅增添了几分跳跃的生机，既表现了迎宾待客的欢喜，又凸显了其高雅的生活格调。

书房的设计是本案的点睛之笔。在这里，设计师摒弃了复杂的造型。一整块硬木加工而成的书桌，充满质感；用木纹石材和旧木饰面组合而成的储物格，古朴安静；加上一整面落地玻璃的设计，整个书房显得简洁、大气；青瓷筒和展开的画卷，散发着独特的人文内涵及艺术气息。在这里，静可品茗阅读，动则挥毫泼墨，无不尽情尽兴。

楼梯护栏采用镂空的方式，原创的中式窗格拼花再次点缀其间，和走廊、过道遥相呼应。吊顶上的手绘图案，轻柔舒展，姿态美丽。放眼望去，整个空间动中有静，刚柔并济。

Guanshanyue has advantageous geographical location, north next to mountain, south to soak up the sun. This case is an area of 450 square meters large family villa example. The designer with profound Chinese culture as the background, into the modern ideas, under the Chinese style appearance of composed inside collection, there is no lack of beautiful center ornament, appear elegant noble temperature.

Restaurant to use the old blue brick files in the modeling of the shop is stuck, combined with dark wood veneer metal circle edge, of primitive simplicity and do not break vogue.

Corridor and the creative aisle spelling a flower from the window of Chinese traditional format. Under the careful arrangement of the designer the abstract pattern, elegant bloom all the way, in this way, everyone who comes to the villa can have a pleasant and comfortable mood.

The sitting room is given priority with the deep coffee color, a dark grey and dark brown, explained the Chinese tradition of grave and elegant. Beautiful case with mirror, let the whole space line becomes vivid. The ground of the light color, golden pillows, as originally composed of the sitting room, which added a few minutes of jumping to life, both shows the joy, welcome guests and highlights the elegant life style.

The design of the study is the nods eyeball pen of the case. Here, the designer gives up complex modeling. The desk was made up by a piece of hardwood, full of simple sense, used for old blue bricks and wood veneer combination storage, with primitive simplicity and quiet environment; Plus a whole born glass surface design, the whole study room appears concise and atmospheric, Celadon tube and a scroll, sending out the unique cultural connotation and artistic breath. Here, being in a quiet environment, you can read based on a cup of tea, being in a moving state with her, all happiness will be around.

Stair railing was adopted by the hollow out, and the original Chinese window flower was used for dotting in the zoom, and in comparison with the corridors and aisles. And the hand-painted design on the ceiling, gently stretch, beautiful look, the whole space was combined with the static and moving states, which seems better for the whole environment.

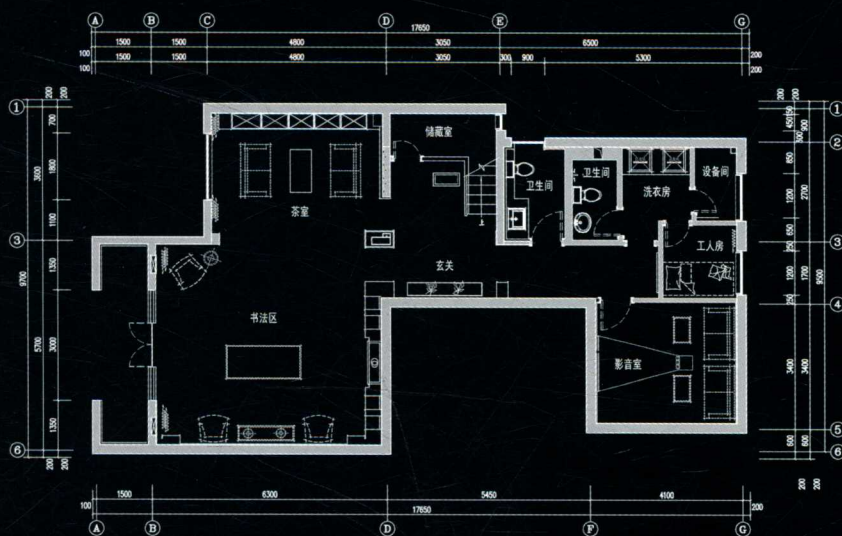

负一层平面布置图

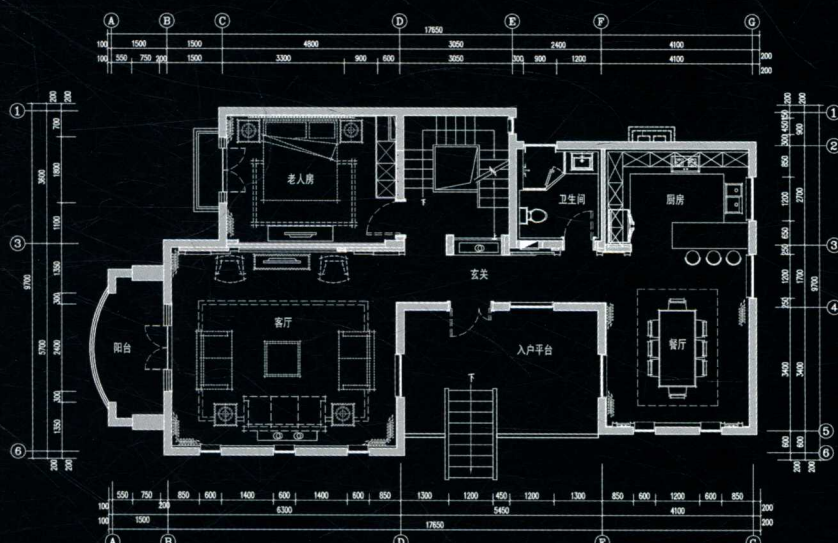

一层平面布置图

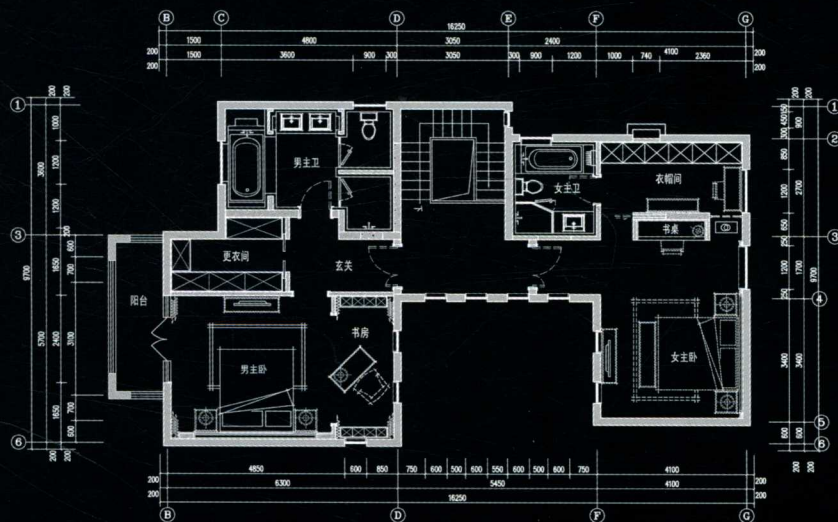

二层平面布置图