

世界建筑 14

World Architecture 14

Art Museum

艺术博物馆 II

佳图文化 编



华南理工大学出版社
SOUTH CHINA UNIVERSITY OF TECHNOLOGY PRESS

世界建筑 14

World Architecture 14

Art Museum

艺术博物馆 II

佳图文化 编



华南理工大学出版社
SOUTH CHINA UNIVERSITY OF TECHNOLOGY PRESS

·广州·

图书在版编目 (CIP) 数据

世界建筑. 14, 艺术博物馆. 2: 英文 / 佳图文化编. —广州: 华南理工大学出版社, 2014. 3
ISBN 978-7-5623-4080-5

I. ①世… II. ①佳… III. ①艺术—博物馆—建筑设计—作品集—世界—英文 IV. ① TU206

中国版本图书馆 CIP 数据核字 (2013) 第 243099 号

世界建筑 14: 艺术博物馆 II

佳图文化 编

出 版 人: 韩中伟

出版发行: 华南理工大学出版社

(广州五山华南理工大学 17 号楼, 邮编 510640)

<http://www.scutpress.com.cn> E-mail: scute13@scut.edu.cn

营销部电话: 020-87113487 87111048 (传真)

策划编辑: 赖淑华

责任编辑: 骆 婷 黄丽谊

印 刷 者: 广州市中天彩色印刷有限公司

开 本: 889mm×1194mm 1/16 印张: 17

成品尺寸: 245mm×325mm

版 次: 2014 年 3 月第 1 版 2014 年 3 月第 1 次印刷

定 价: 298.00 元

版权所有 盗版必究 印装差错 负责调换

Preface

Art centers, museums and other cultural buildings are important architectures for art appreciation or education purpose. In this new volume, we've selected some excellent projects to interpret the design skills of this kind of architecture. The book covers completed art buildings such as art galleries, museums, cultural centers, etc. around the world—we aim to include projects which are either of top quality or interesting, or ideally both. With professional design materials, high-resolution photographs and clear descriptions, it well introduces every project from all the aspects that will surely bring some inspirations to the readers.

Contents

Museum

National Museum of the Marine Corps	002
Natural History Museum of Utah	010
New Acropolis Museum	018
Gran Museo del Mundo Maya de Mérida	028
Renovation and Expansion of the Isabella Stewart Gardner Museum	036
NASCAR Hall of Fame	052

Exhibition Center

Cultural Center of EU Space Technologies	060
Indiana Convention Center Expansion	076
The Barnes Foundation	082
Pavilion 4	094

Cultural Activity Building

Dalian International Conference Centre	106
BRG Neusiedl am See	118

Universidad Politecnica de Valencia Expansion	130
Comba Tentes Educational Center	142
Southland Christian Church	154
Thebarton Community Centre	160
Le Temps Machine	166
Auditorium del Parco	176
LA FABRIQUE, laboratoire(s) artistique(s) et centre culturel à Nantes	184
Birmingham Ormiston Academy	190

Art Building

Théâtre 95	202
Theater De Nieuwe Kolk, Assen	216
New Theatre in Montalto di Castro, Italy	222
Opera House and Pop Music Stage Enschede	234
Pier K Theatre and Arts Centre	240
Hamer Hall	248
PALOMA Contemporary music venue at Nîmes Métropole	260



Education
Art Collection
Cultural Heritage

Keywords

Symbol

Angled

Flag-raising

National Museum of the Marine Corps

Location: Quantico, Virginia
Architect: Fentress Architect
Client: Marine Corps Heritage Foundation
Size: 11,150 m²

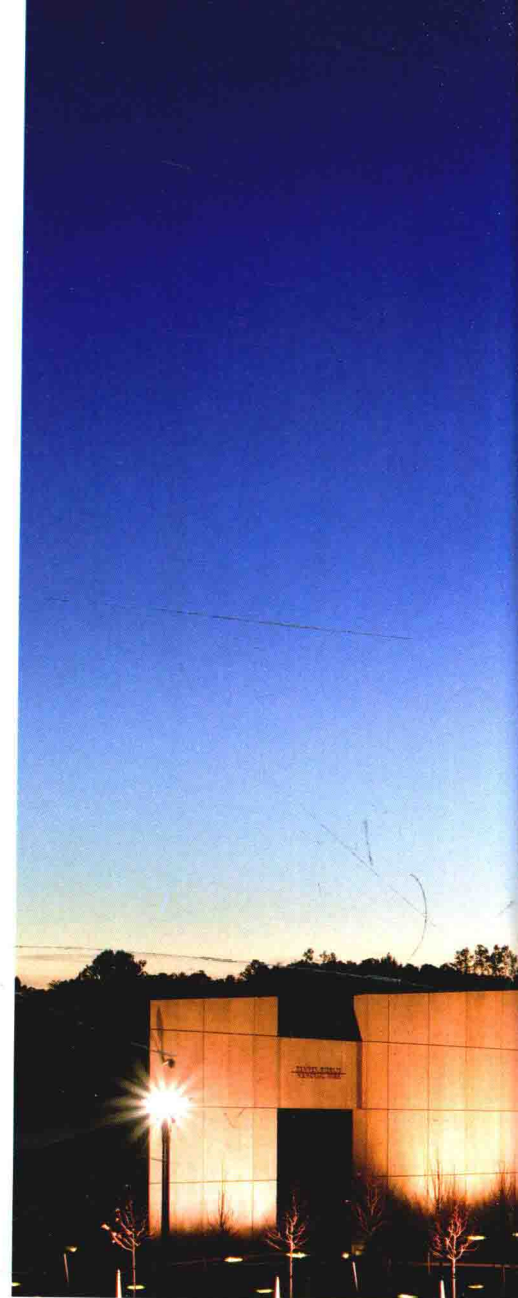

First prize winner in a national design competition, Curtis Fentress' design for the National Museum of the Marine Corps was honored with 20 awards in its first 20 months. Since President George W. Bush opened the museum in 2007, it has been visited by over one and a half million people, earning a reputation as a top cultural destination in the United States.

In seeking a symbol to illustrate the culture and history of the United States Marine Corps, Fentress Architects turned to an image embedded in the American soul since the final months of World War II: the flag-raising at Iwo Jima. This icon of determination, bravery and camaraderie inspired a winning competition design for a museum to serve as exhibition center, educational resource, and gathering place for a community much wider than Corps members alone. Through abstraction, the famous Joe Rosenthal photograph was translated into an angled, 210-foot stainless steel-clad mast that pierces a conical glass and steel skylight, giving the National Museum of the Marine Corps instant landmark status. Visible from Interstate 95, this bold form tops a circular building with clean lines expressed in simple, strong materials: cast-in-place concrete, steel, glass and stone. A broad plaza and entry create a natural link to the surrounding Semper Fidelis Memorial Park. The skylight also functions as a ceiling plane for the building's central gallery, where an efficient radial plan extends to house galleries, classrooms, visitor services, and restaurants. The museum's core is not just a connector. Eloquent quotations engraved in the inner walls speak of courage and commitment, while a terrazzo floor carries the pattern of a globe, representing



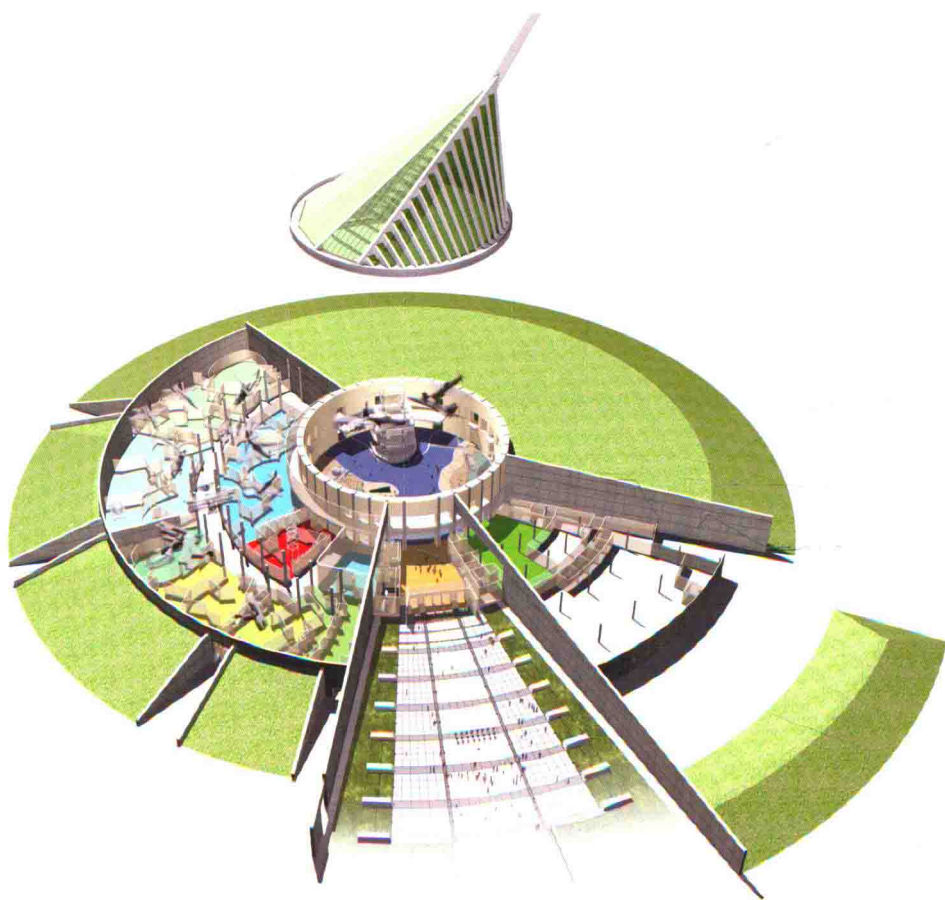

the land, sea and sky by which Marines have fought. Airplanes are suspended from the skylight, and other military transport vehicles are installed below, leading to immersion galleries. The circular form of the museum building also aids sustainable strategies. Part of the structure is embedded in earthen beams and a vegetated roof, which help regulate gallery temperature to conserve art and artifacts, provide acoustic buffering, and, in conjunction with the air flow, cool the building.

A nondenominational chapel sits atop a hill nearby, where visitors can reflect and worship. The wood, stone and glass-walled chapel is intended to host intimate events such as weddings, memorials and dedications.

"Military museums are not about war," says Curtis Fentress. "Instead, they celebrate the importance of maintaining peace and protecting citizens. At the National Museum of the Marine Corps, we mindfully searched for the ultimate icon to symbolize the end of war."

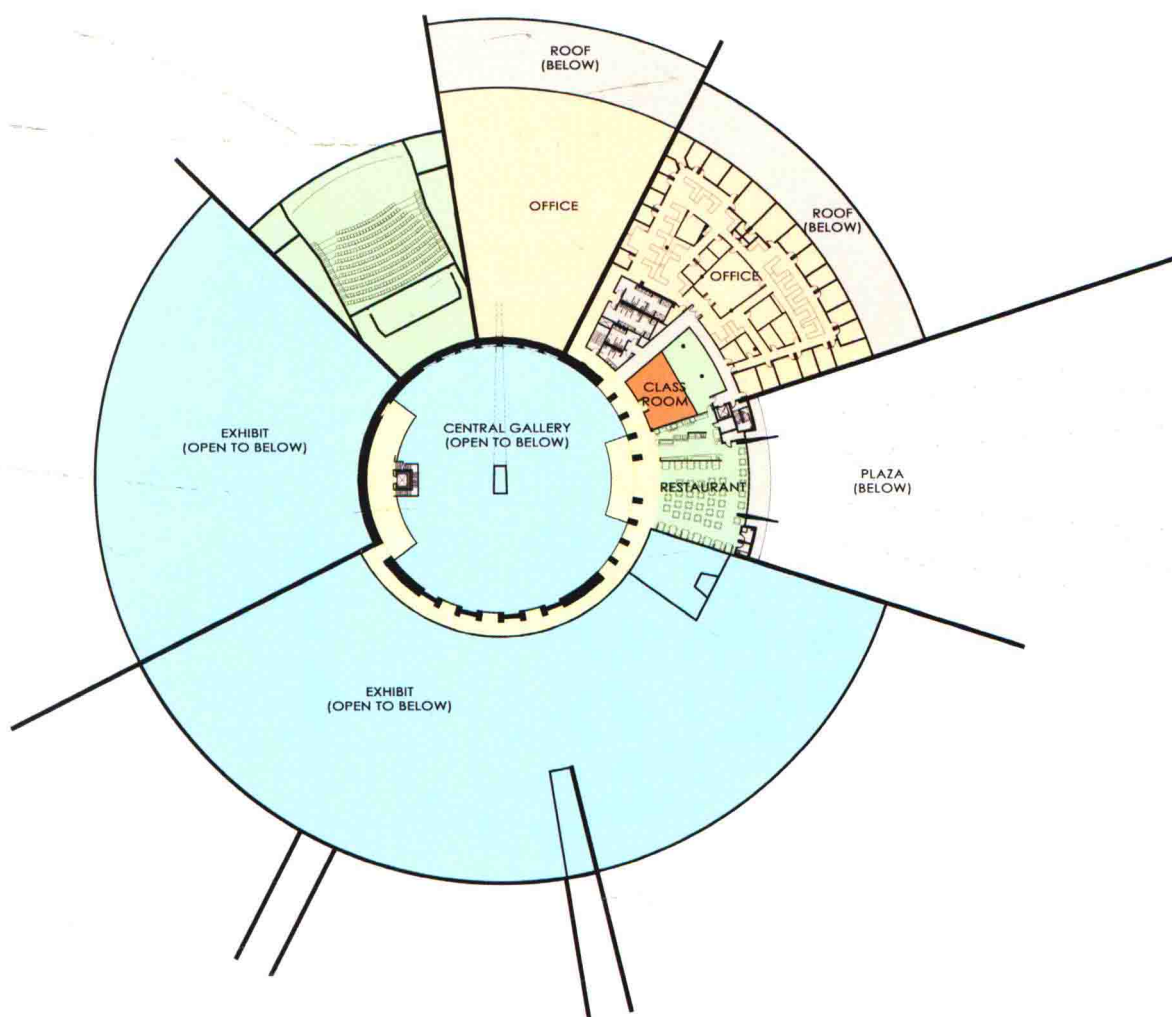
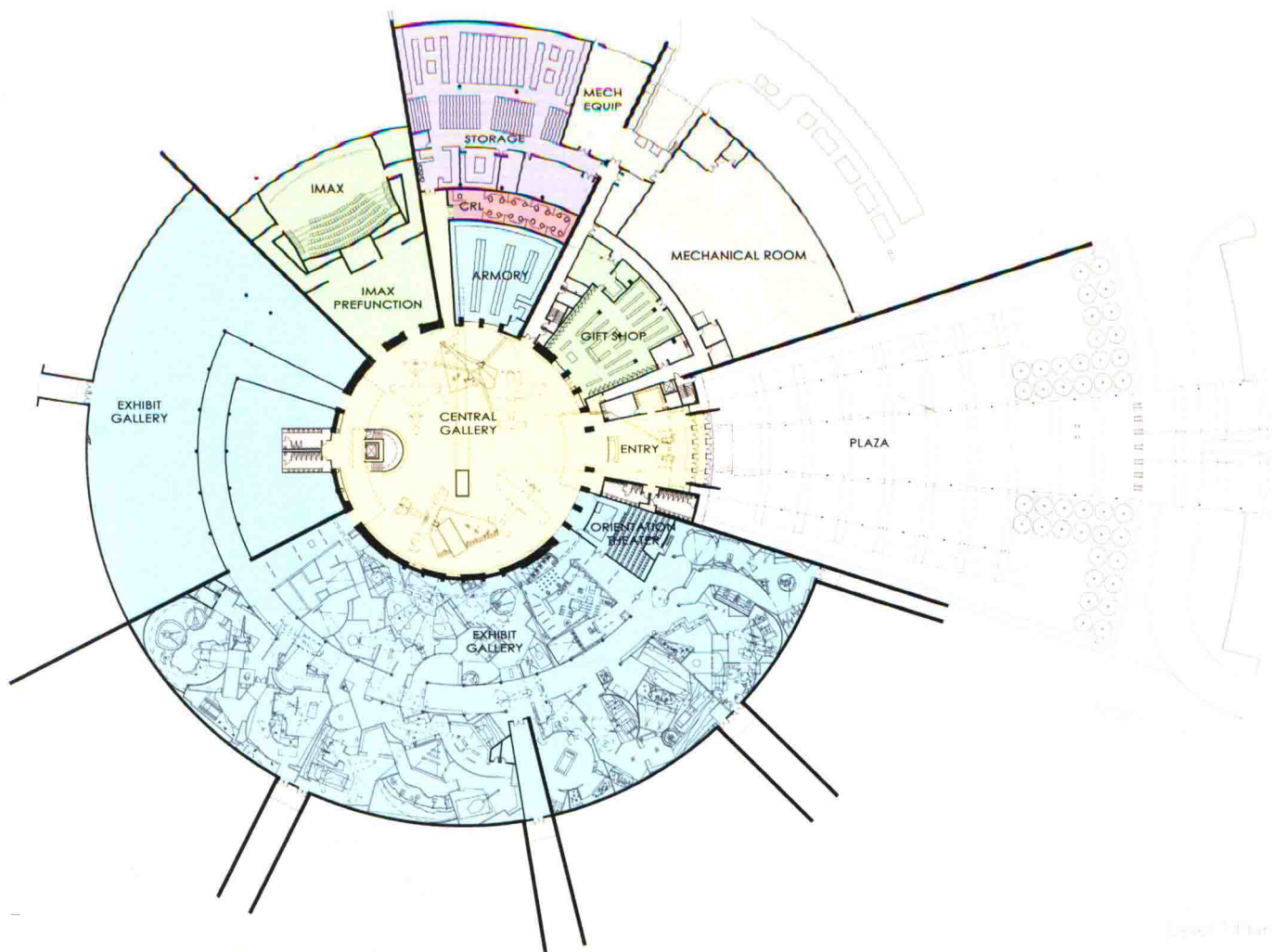

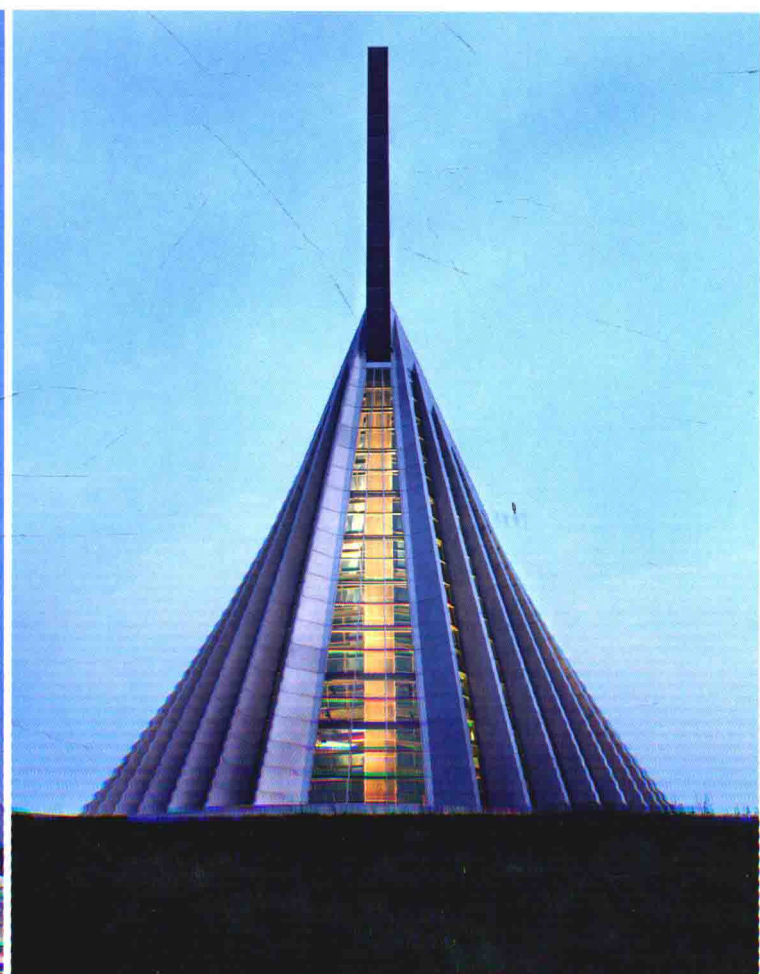
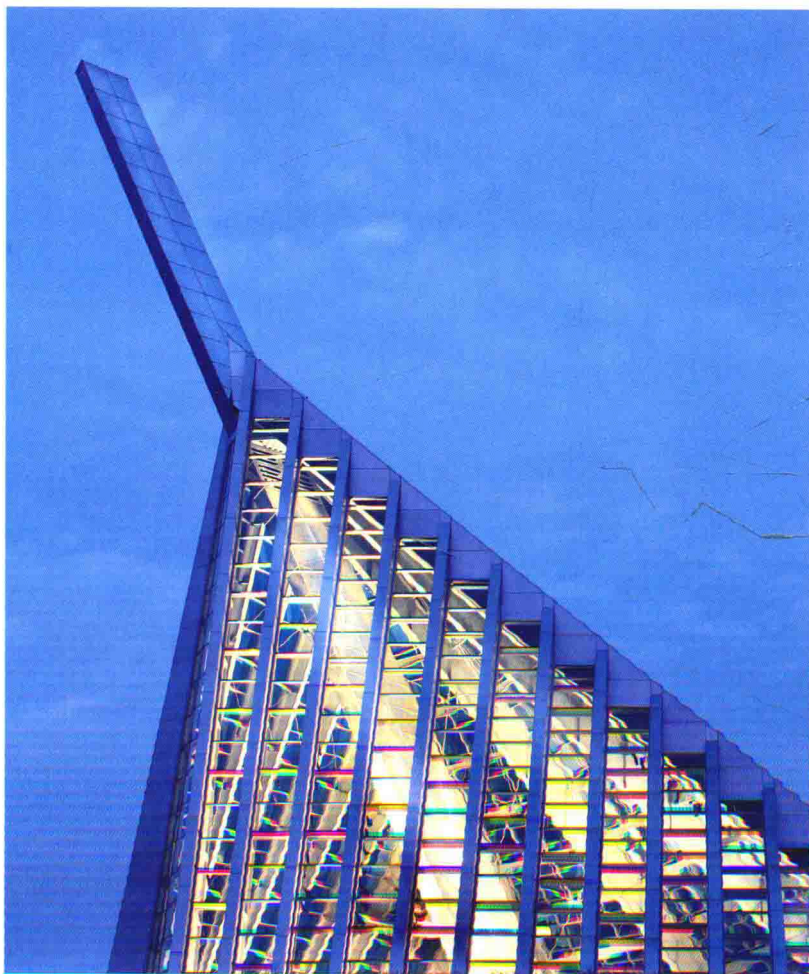
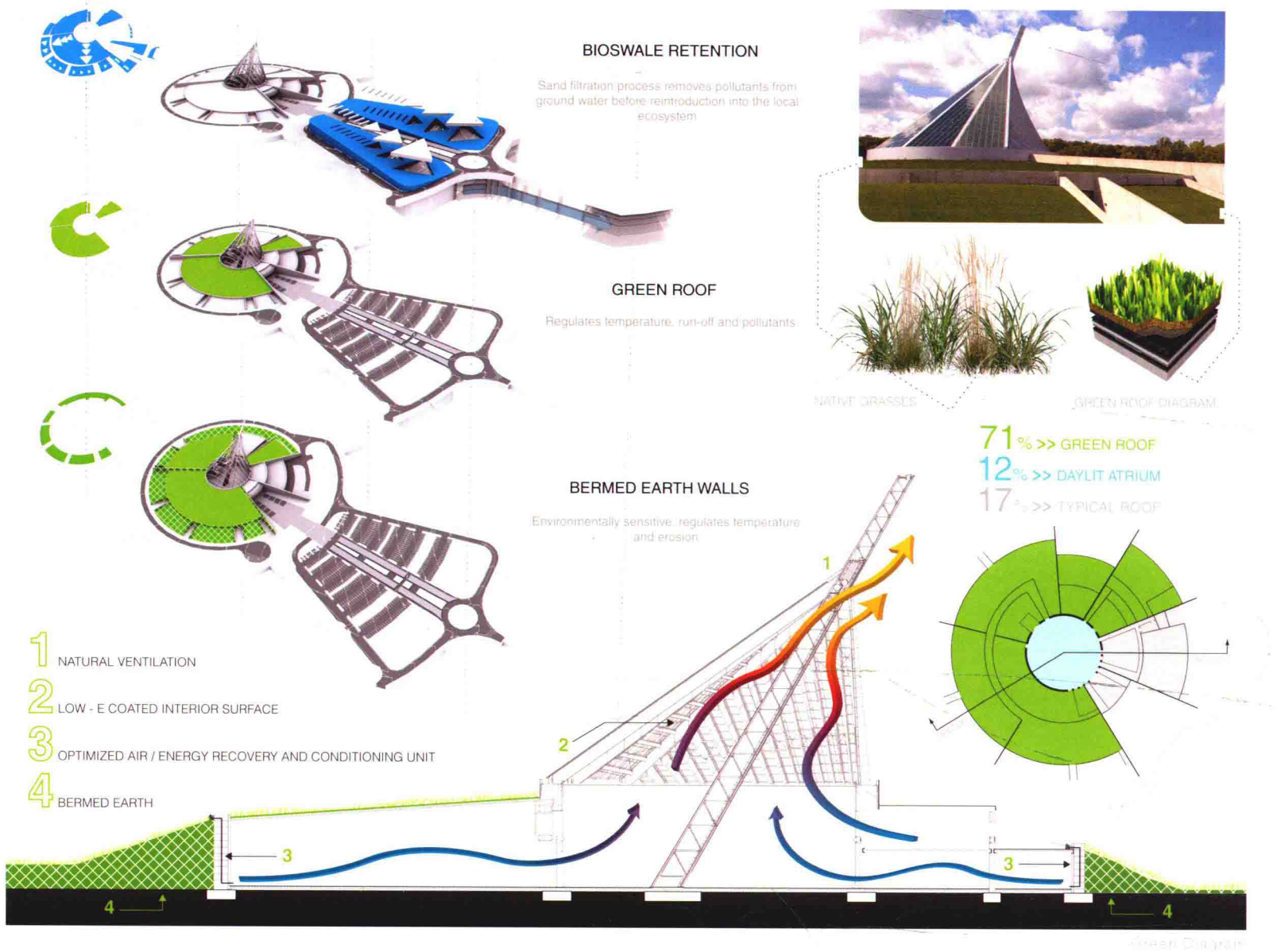



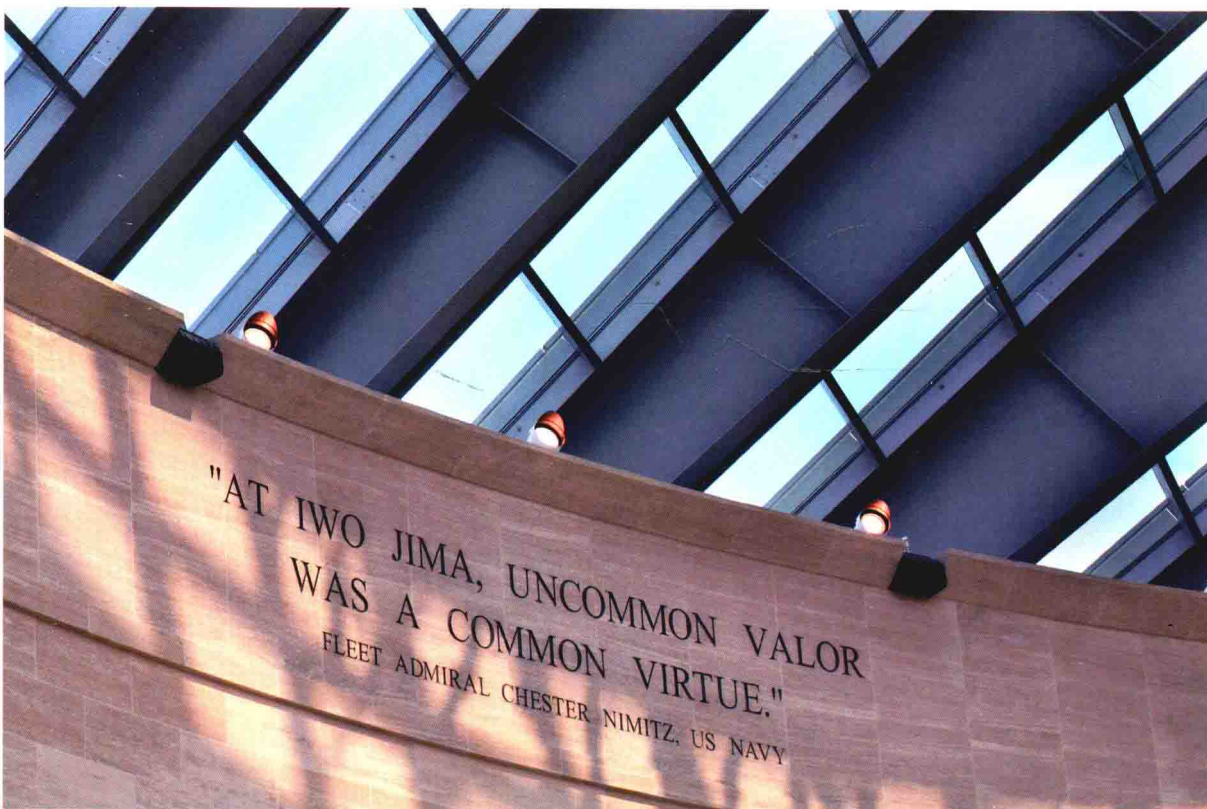

Keywords

Repository Natural Human

Natural History Museum of Utah

Location: Salt Lake City, Utah, United States
Architectural Design: ennead architects

The Natural History Museum of Utah (NHMU) is a museum located at the Rio Tinto Center on the campus of the University of Utah in Salt Lake City, Utah, United States. The museum shows exhibits of natural history subjects, specifically about Utah's natural history. The mission of the museum is to illuminate the natural world and the place of humans within it.

The museum's exhibit areas occupied almost 23,000 square feet (2,100 m²) on the first and second floors of the George Thomas Building, located on the University of Utah campus. The exhibits targeted three broad areas of the natural sciences: geology/paleontology, anthropology, and biology.

The Museum is part of the academic life of the University of Utah. The collections offer research opportunities and provide a learning laboratory for students. Museum programs expose students to many aspects of museum studies: educational outreach, exhibit design and fabrication development, public relations, and curriculum development.

The Museum is a repository for collections that were accumulated by the University's departments of Anthropology, Biology, and Geology. The collections are held in trust for faculty, graduate students, and undergraduates who have access to the collections for research and teaching purposes.



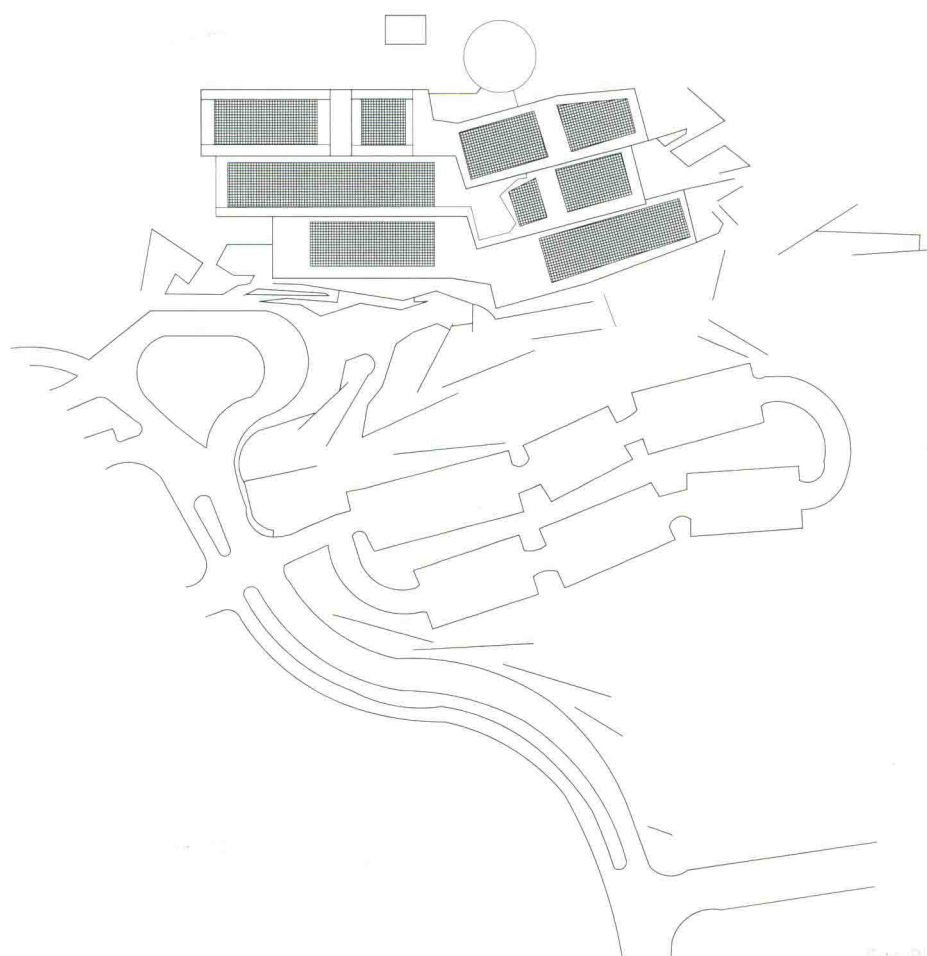

Site Plan

In-service training is offered by the Utah Museum of Natural History Education Department; university credit can be earned with these courses, leading to salary lane changes for public school teachers. These courses are coordinated with the Academic Outreach and Continuing Education and the Department of Teaching and Learning. As the founder of the University's Genetic Science Learning Center, the Museum continues to partner in its teacher training program.