

2011年室内细部年鉴

Interior+Architecture 室内+建筑



# Detail.

3

# 详细

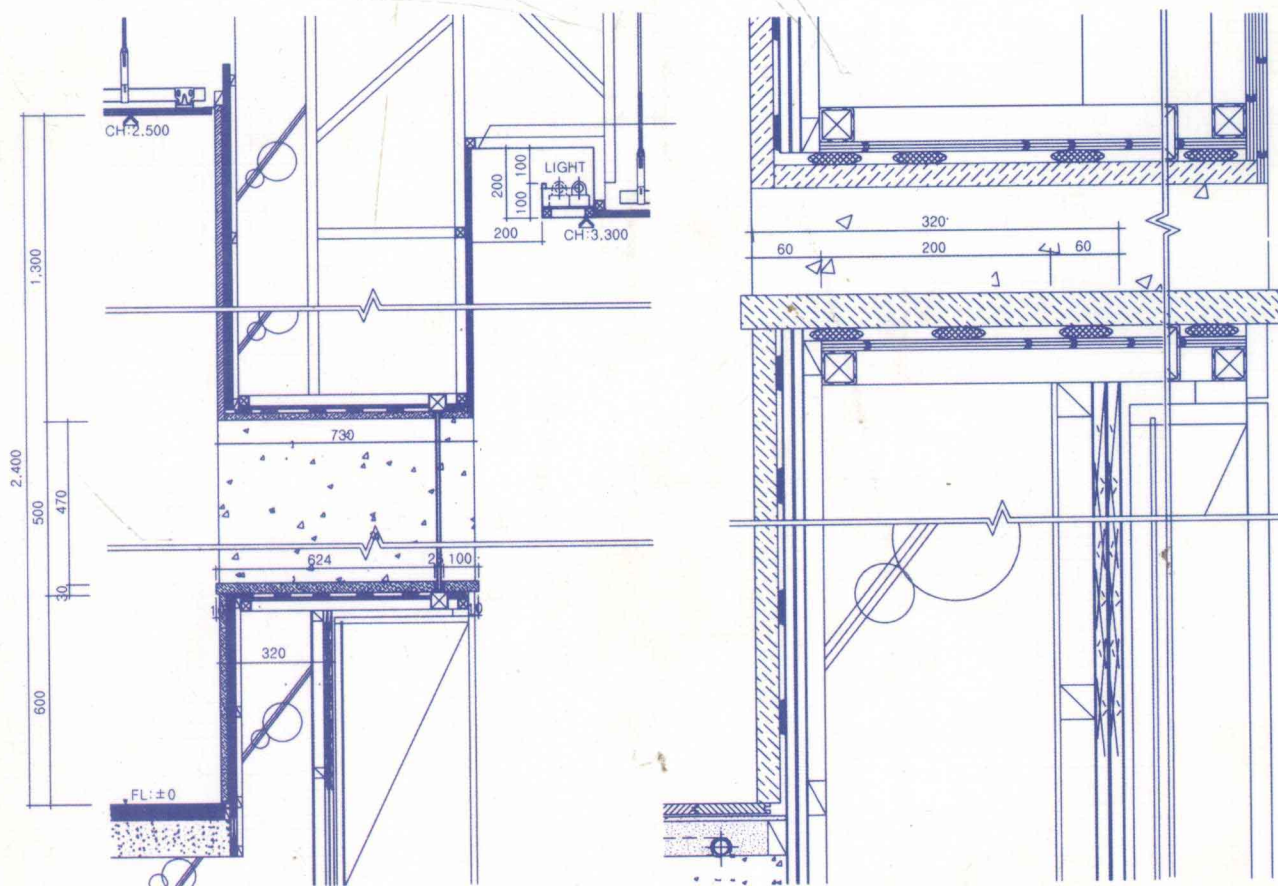

Interior+Architecture 室内+建筑

# Detail<sup>+</sup><sub>3</sub>

# 详细

# 目录 Contents

## CAFE & RESTAURANT

- 006 SUSHISAMBA 寿司桑巴
- 014 RAON 咖啡馆
- 020 Café vezzly 咖啡馆
- 030 T5 RESTAURANT, JFK AIRPORT T5餐厅 (肯尼迪机场)
- 040 Cafe Urara 咖啡馆
- 048 STK New York STK餐厅 (纽约)
- 058 Cafe Around the Corner 转角咖啡馆

## CULTURE & EDUCATION

- 068 Media Center Oberkirch 奥伯基希媒体中心
- 078 Ceramic Space & Life 陶瓷生活空间
- 096 Senior Friendly Products and Services Experiencing Center Seongnam City 城南市老年产品和服务体验中心
- 114 Bupyeong Arts Center 富平艺术中心
- 128 Sungkyunkwan University Samsung Library 成均馆大学三星电子图书馆
- 142 Jungdong Elementary School 俊东小学
- 152 LONGFORD COMMUNITY SCHOOL 朗福德社区学校

## OFFICE

- 162 CJ E&M CENTER OFFICE E&M总部
- 174 posco e&c Tower E&C塔
- 192 BLUECOM SPACE 办公空间
- 204 Office Storey 办公层
- 212 The Delicious Think Headquarters 公司总部

## MEDICAL

- 224 Conmaul Oriental Clinic 中医诊所
- 236 Ra Dental Clinic 牙医诊所
- 246 PHILIP MEDICAL CENTER 菲利普医疗中心
- 260 The Garden of Crocodile Bird Dental Clinic 鳄鱼花园牙医诊所
- 268 W plastic surgery 整容门诊
- 278 SEOUL PRIME SKIN CLINIC 首尔顶级皮肤诊所

Interior+Architecture 室内+建筑

# Detail<sup>+</sup><sub>3</sub>

# 详细

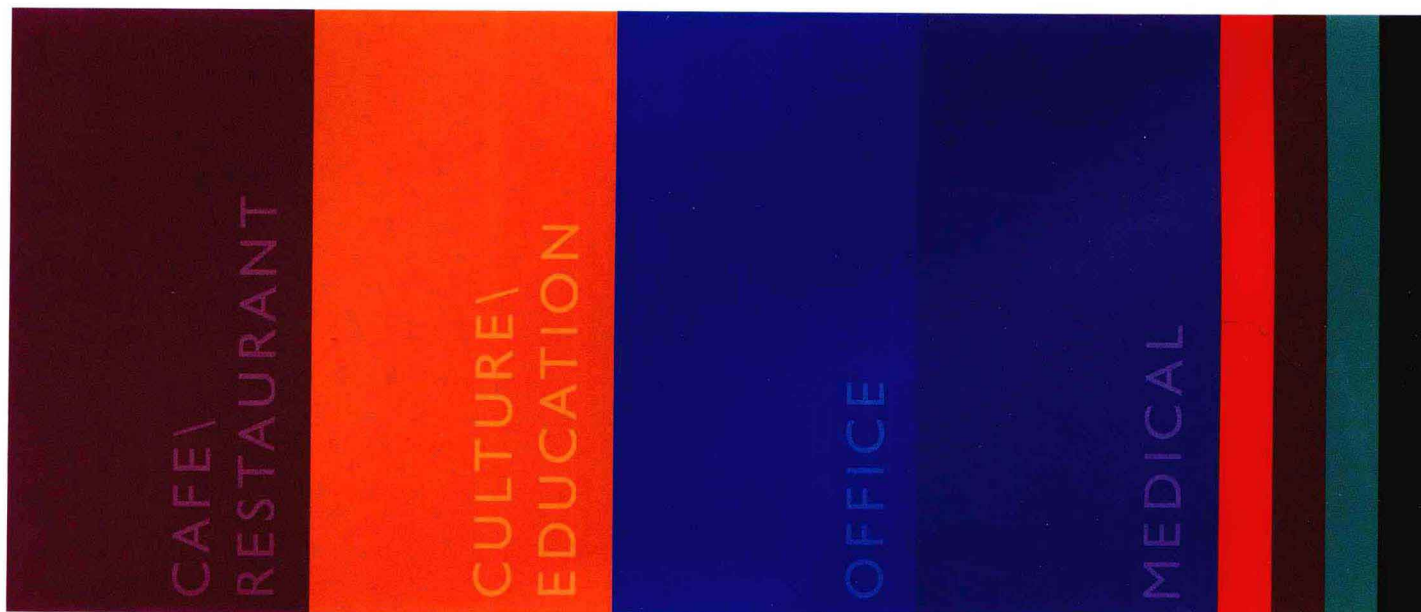

## Detail<sup>+</sup> 3

**Publisher** Jeong Kwangyoung  
**Editor** Choi Jihyun, Ha Jihae, Lydia Kim  
**Designer** Jeong Dongeun, Kwon Taenam

**Publishing** Archiworld Co., Ltd.  
5F Archiworld Bldg., 315-2  
Neung-dong, Gwangjin-gu, Seoul, Korea

**Price** US \$62

©Archiworld Co., Ltd. 2010  
Printed in Korea

# 目录 Contents

## CAFE & RESTAURANT

- 006 SUSHISAMBA 寿司桑巴
- 014 RAON 咖啡馆
- 020 Café vezzly 咖啡馆
- 030 T5 RESTAURANT, JFK AIRPORT T5餐厅（肯尼迪机场）
- 040 Cafe Urara 咖啡馆
- 048 STK New York STK餐厅（纽约）
- 058 Cafe Around the Corner 转角咖啡馆

## CULTURE & EDUCATION

- 068 Media Center Oberkirch 奥伯基希媒体中心
- 078 Ceramic Space & Life 陶瓷生活空间
- 096 Senior Friendly Products and Services Experiencing Center Seongnam City  
城南市老年产品和服务体验中心
- 114 Bupyeong Arts Center 富平艺术中心
- 128 Sungkyunkwan University Samsung Library  
成均馆大学三星电子图书馆
- 142 Jungdong Elementary School 俊东小学
- 152 LONGFORD COMMUNITY SCHOOL  
朗福德社区学校

## OFFICE

- 162 CJ E&M CENTER OFFICE E&M总部
- 174 posco e&c Tower E&C塔
- 192 BLUECOM SPACE 办公空间
- 204 Office Storey 办公层
- 212 The Delicious Think Headquarters 公司总部

## MEDICAL

- 224 Conmaul Oriental Clinic 中医诊所
- 236 Ra Dental Clinic 牙医诊所
- 246 PHILIP MEDICAL CENTER 菲利普医疗中心
- 260 The Garden of Crocodile Bird Dental Clinic 鳄鱼花园牙医诊所
- 268 W plastic surgery 整容门诊
- 278 SEOUL PRIME SKIN CLINIC 首尔顶级皮肤诊所

CAFFEE &  
RESTAURANT

咖啡厅和餐厅

SUSHISAMBA

寿司桑巴

RAON

咖啡馆

Café vezzly

咖啡馆

T5 RESTAURANT,

JFK AIRPORT

T5餐厅, 肯尼迪机场

Cafe Urara

咖啡馆

STK New York

STK纽约

Cafe Around the Corner

转角咖啡馆



## 寿司桑巴

Design ICRAVE

Design Team Lionel Ohayon, Siobhan Barry,  
Robert Delpazzo

Location Palazzo Casino Resort, Las Vegas,  
Nevada, USA

Built Area 650m<sup>2</sup>

Finish Glass-reinforced Gypsum Board,  
Graffiti Mural, Designed Millwork  
(Banquettes) Walnut, Rosewood  
(Tables) Dark Wenge Wood

Photograph Francis George, Francis Baytan

设计: ICRAVE工作室

设计团队成员: Lionel Ohayon, Siobhan Barry,  
Robert Delpazzo

地点: 美国内华达州拉斯维加斯帕拉索酒店赌场  
建筑面积: 650平方米

面层材料: 玻璃纤维增强石膏板, 涂鸦壁画,  
椅子: 胡桃木、红木, 餐桌: 黑木

摄影: Francis George, Francis Baytan

Reflecting the theatricality and exuberance of its decadent desert domain, SUSHISAMBA Strip - opened in July 2008 and is SUSHISAMBA's newest and largest location at 14,000 square feet. The ICRAVE-designed space mirrors the energy of the Las Vegas Strip by greeting guests with an architectural glass facade inspired by Mondrian in its linearity, color, and sharp edges. Dramatic 16-foot ceilings create a soaring atrium, which houses the main restaurant space, a vibrant, Carnival-inspired environment. An oversized art installation anchors the main restaurant space with a three-dimensional illustration through space of swirling 'ribbons' that explode from the center of the room and wrap their way around eating spaces, winding around the sushi bar and lounge, evoking a feeling of movement and dynamism.

为了反映其所处的戏剧性和热力充沛的沙漠背景，这个2008年7月开张的寿司桑巴餐厅是寿司桑巴旗下最新最大的餐厅，面积为14000平方英尺。这个由ICRAVE工作室设计的空间反映了拉斯维加斯赌场地带的活力，它建筑玻璃幕墙的灵感来自蒙德里安的线性、颜色和形状边界。戏剧性的16英尺高的天花形成了一个高敞的中庭，餐厅中主要的用餐区都集中在这个中庭里面，它创造了一个充满活力的狂欢环境。餐厅中的巨大艺术装置强调了各个用餐区，它是用一个从餐厅中心开始的三维旋转带子，包围在餐桌周围，穿过寿司吧台和休闲吧台，唤起顾客的运动感和活力感。

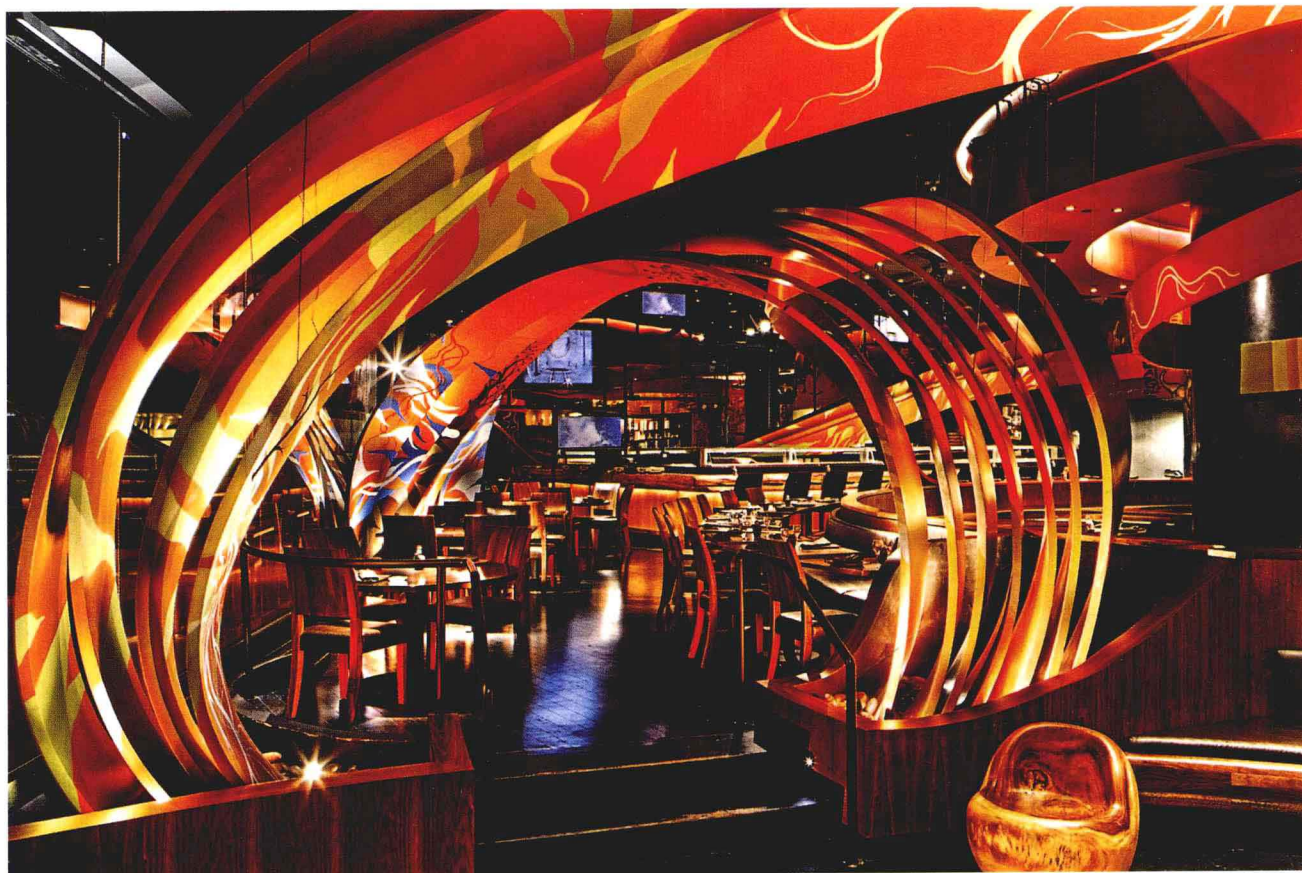

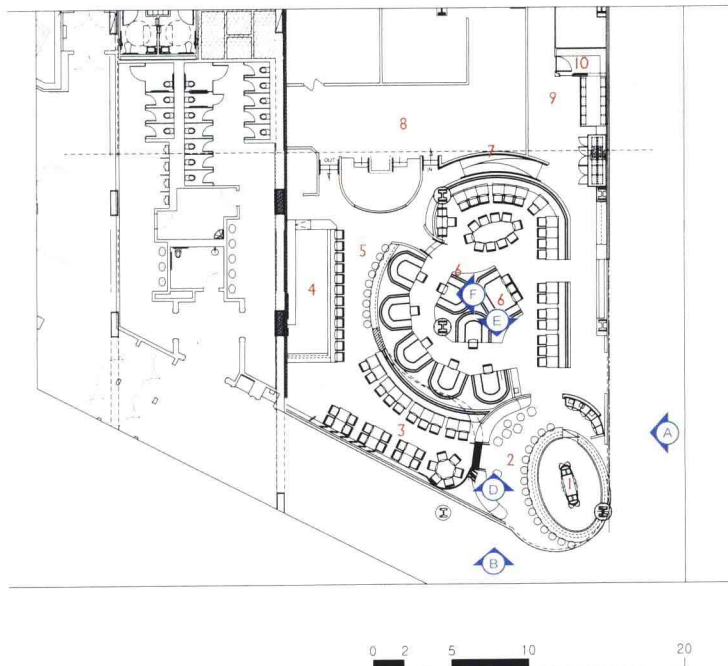

1. Main bar
  2. Bar lounge
  3. Raised dining
  4. Sushi bar
  5. Sushi dining
  6. Main dining
  7. Dining pod
  8. Kitchen
  9. Hallway
  10. Storage
- 1、主吧台
  - 2、休闲吧台
  - 3、抬高餐区
  - 4、寿司吧台
  - 5、寿司用餐区
  - 6、主要用餐区
  - 7、隔断
  - 8、厨房
  - 9、过道
  - 10、储藏室

Floor plan  
平面图



■ Exterior 餐厅外景

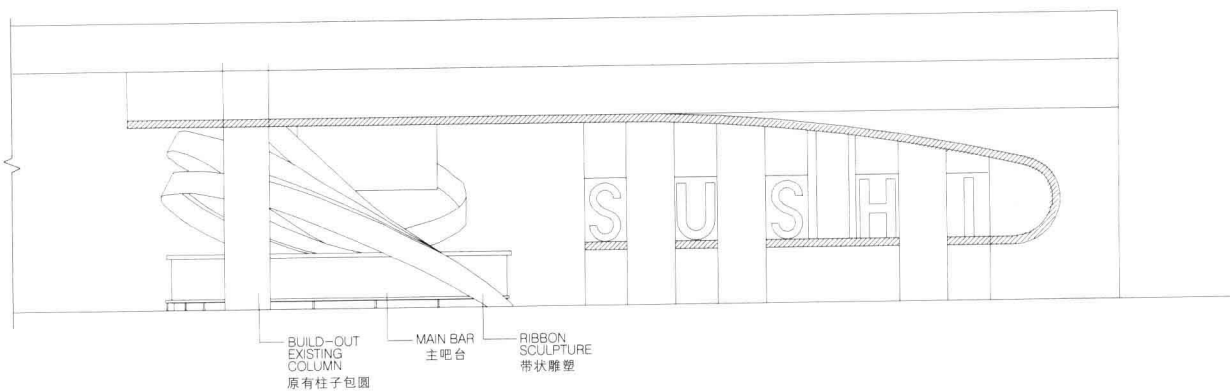

Elevation A  
A立面

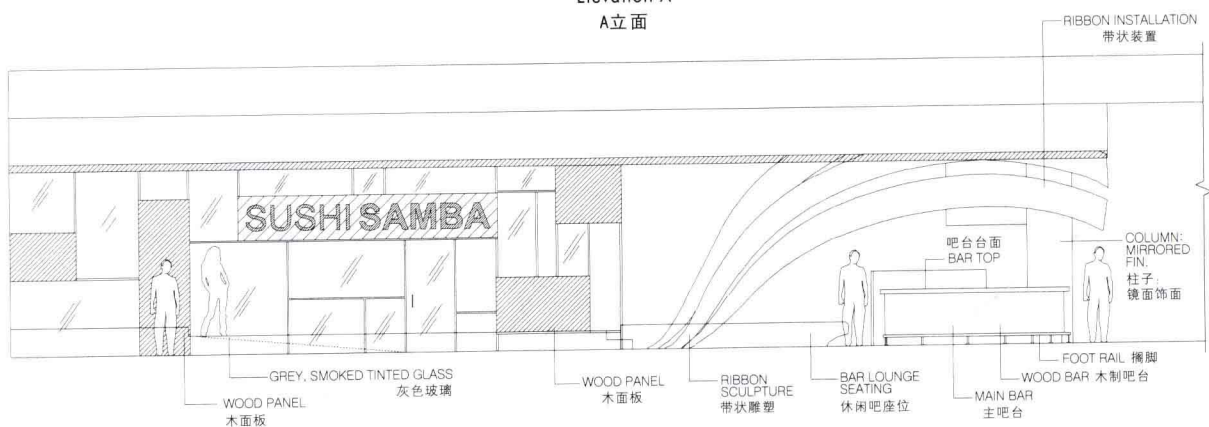

Elevation B  
B立面

■ Main bar 主吧台

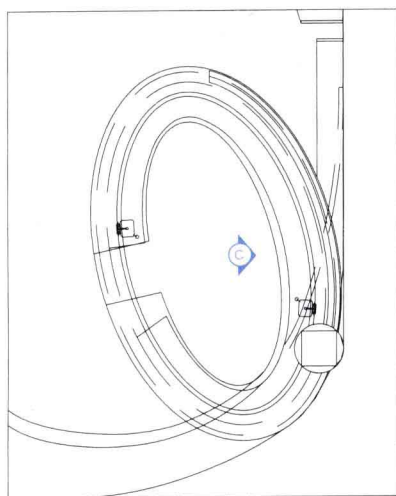

Part plan  
局部平面

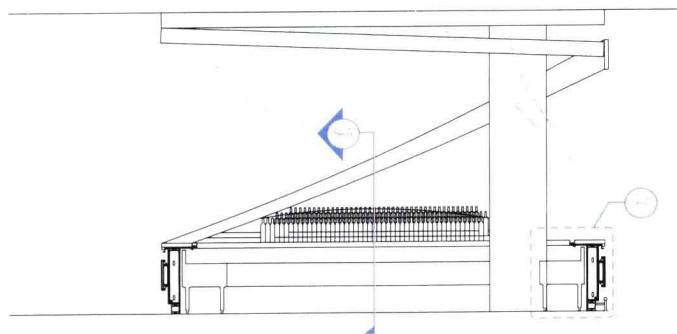

Elevation C  
C立面

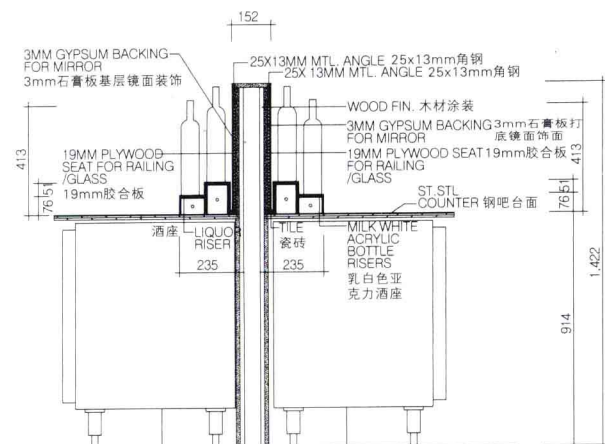

Section A  
A剖面

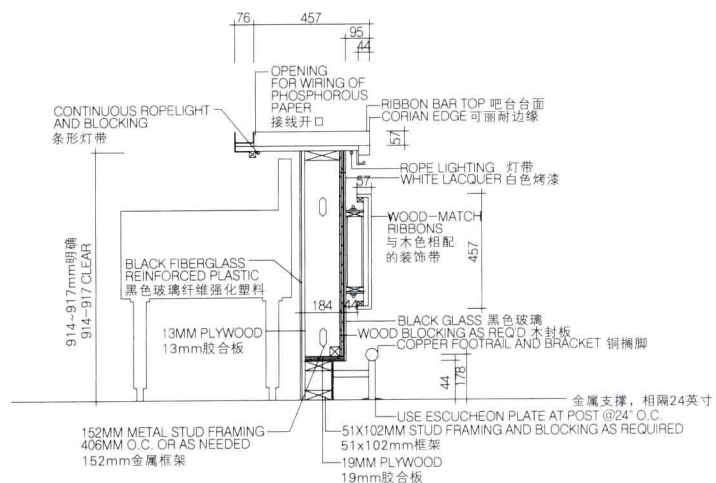

Detail A  
A大样



■ Lounge 餐厅内景

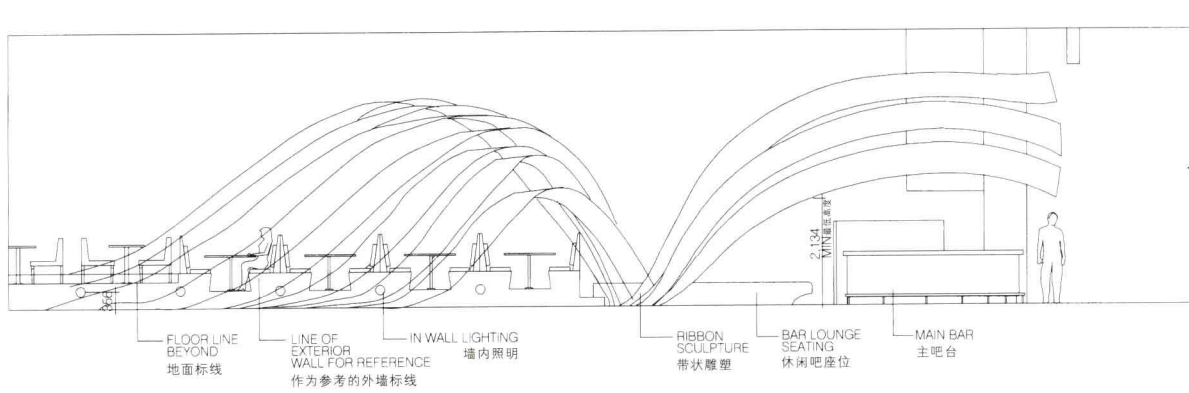

Elevation D  
D立面

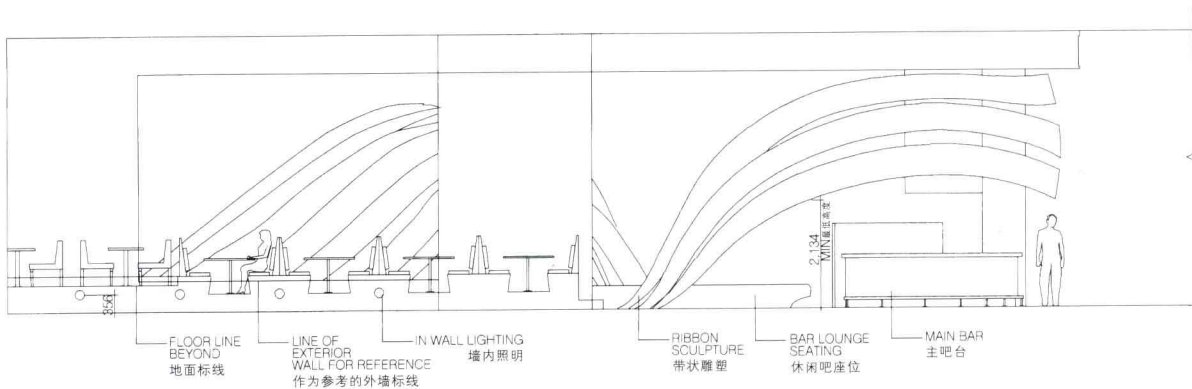

Elevation D'  
D'立面

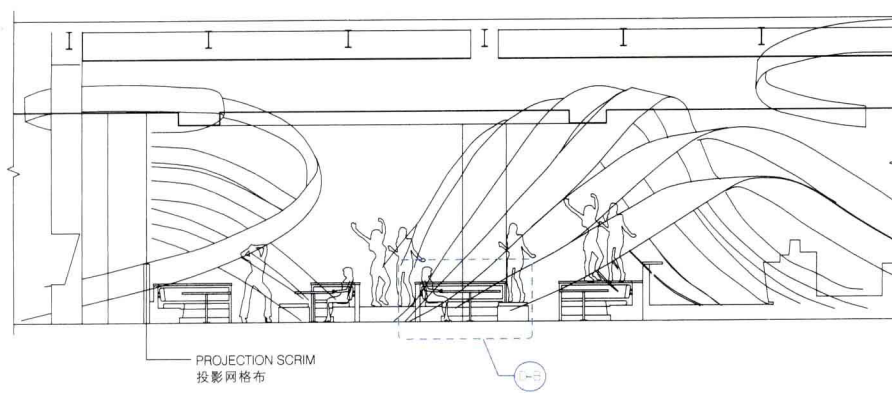

Elevation E  
E立面

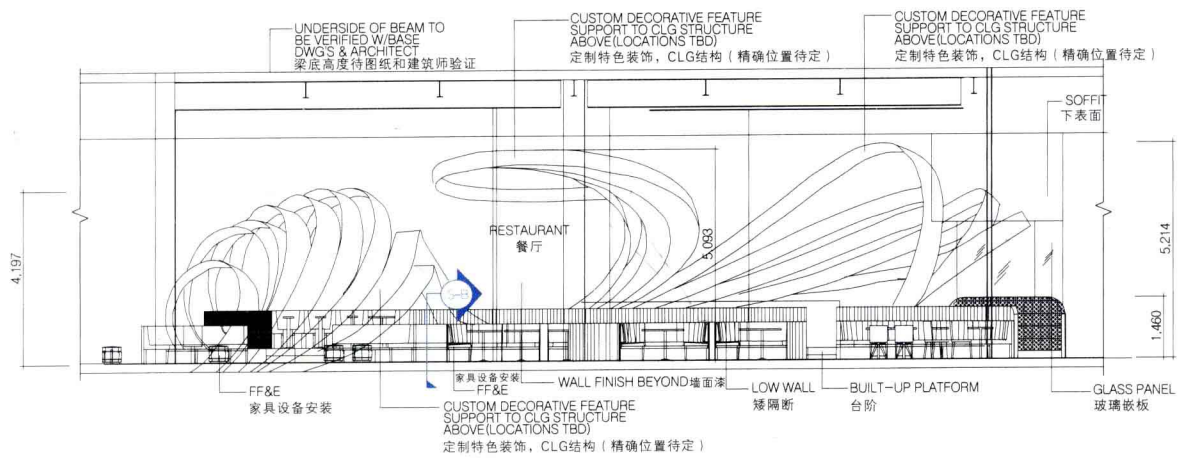

Elevation F  
F立面

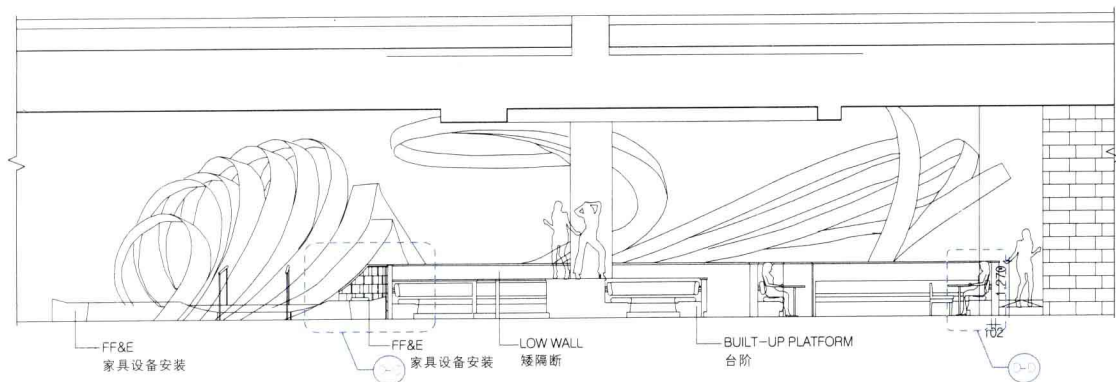

Elevation F'  
F'立面

■ Built-in chair 固定座位

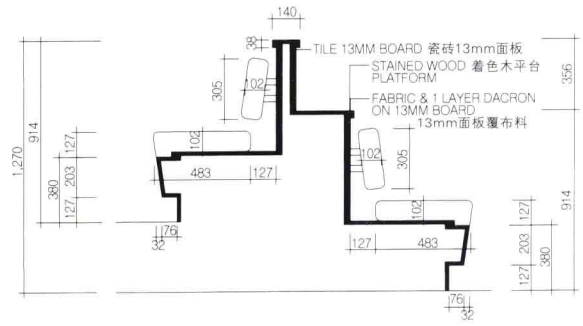

Section B  
B剖面

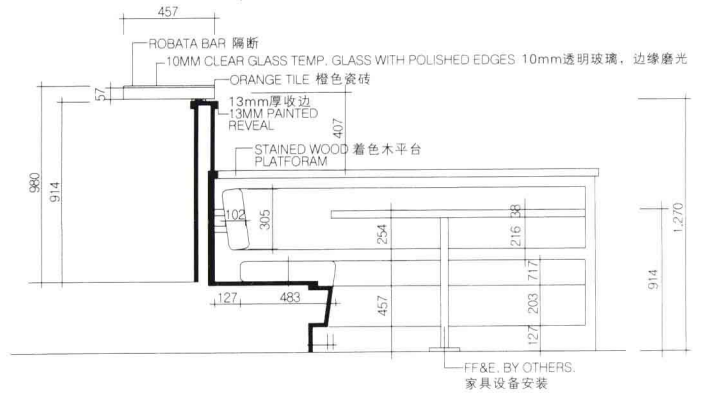

Detail B  
B大样

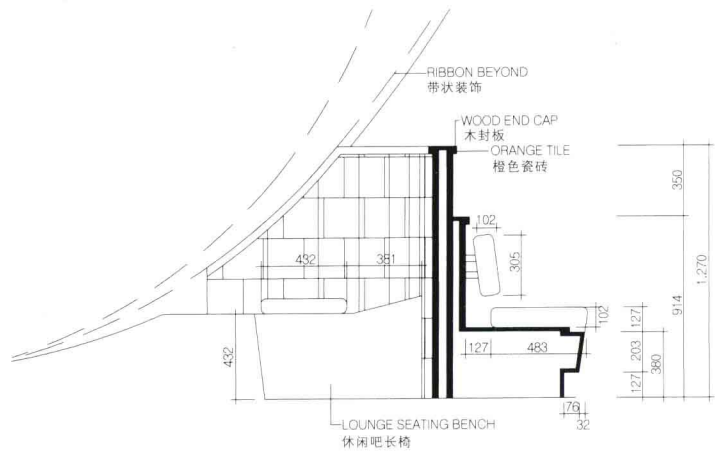

Detail C  
C大样

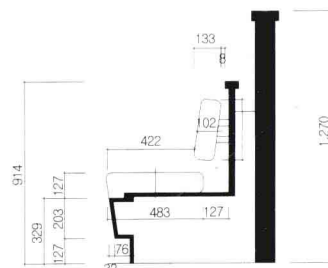

Detail D  
D大样

■ Shushi bar 寿司吧台

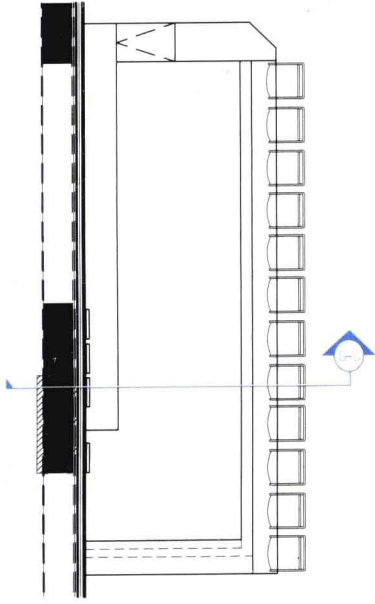

Part plan  
局部平面

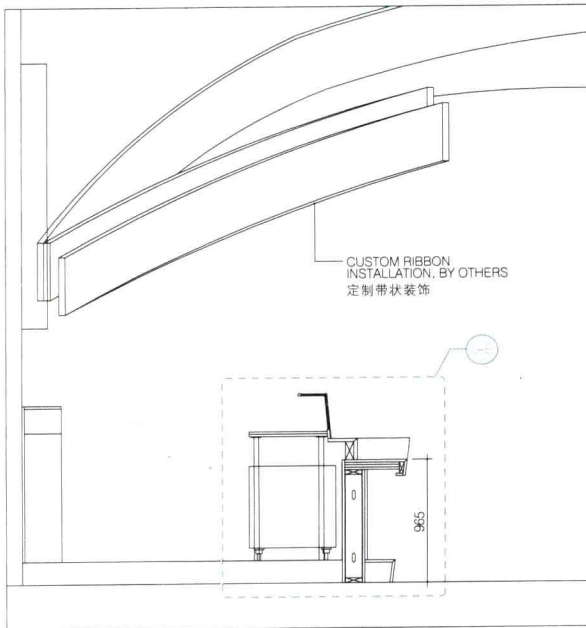

Section C  
C剖面

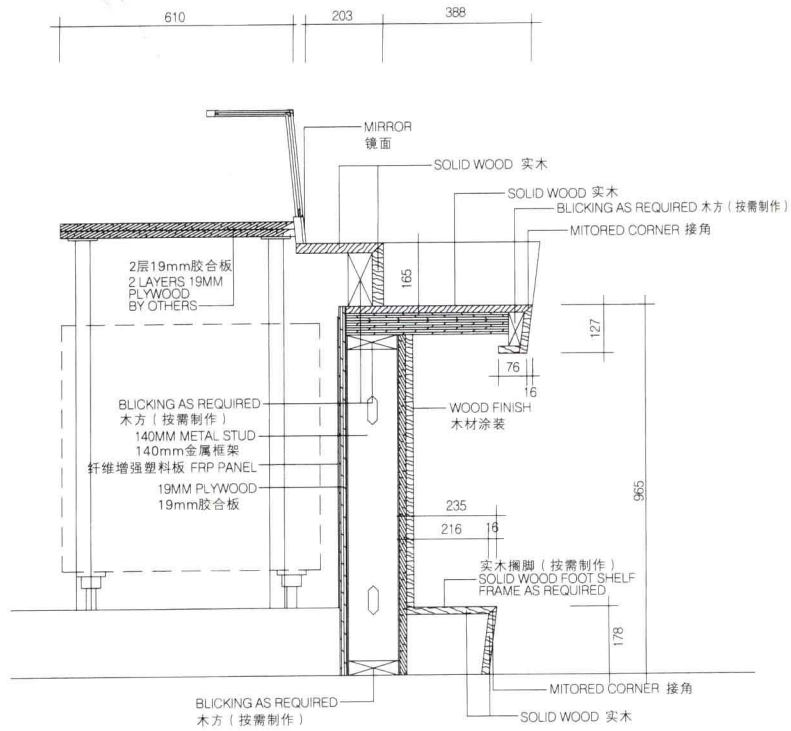

Detail E  
E大样



# RAON

## 咖啡馆

Design wakestyle vision BONO. · Jang Sung-jin

Design Team Jeong Ji-na, Ihm Sun-yu

Location Singil 6-dong, Yeongdeungpo-gu,  
Seoul, Korea

Built Area 136㎡

Finish Floor : Exposed Concrete, Epoxy

Wall : Birch Wood Panel

Ceiling : Exposed Concrete, Vinyl Paint

Construction wakestyle vision BONO.

· Kim Yong-dae

设计：Wakestyle视觉空间设计，Jang Sung-jin

设计团队成员：Jeong Ji-na, IHM Sun-yu

地点：韩国汉城永登浦区新吉6栋

建筑面积：136平方米

面层材料：地面：清水混凝土、环氧树脂

墙面：栎木木板

天花：清水混凝土、乙烯基漆

施工：Wakestyle视觉空间设计，Kim Yong-dae



Raon catches the eyes of passersby and stops their feet with its exterior with the warm light emitting among tall trees. The fascinating and attractive appearance draws people inside and reveals the rectangular plan that seems to suck the viewers to the interior.

The birch panels, which are suggestive of the local forest, faithfully represent the scene of tree branches growing and intersecting one another in a natural way, creating in-between spaces. The designer's intention is to break down the boundary of the interior and exterior spaces and bring the forest of the outside to the inside. Installed in the background of modern three elements – the wall, ceiling and flooring – were the vintage pendent lightings among the long axis and furniture with different feels. The veneer lighting fixture floating in the center adds warmth to the space and maximizes the spatiality.

The bar counter positioned at the end of the space gives an intimate atmosphere by providing a chance to watch how baristas works. Various accessories were displayed along the long axis of the room to complete a comfortable space.

在高树丛中的Raon咖啡馆用它温暖灯光照明的外墙停住行人的脚步，它迷人的外表引领行人走进它的室内去探索这个矩形的空间。

栎木木板暗示着本地森林，并且用自然的手法象征地描绘了树木之间的生长和交叉，创造了中间的空间。设计师的意图是想要打破室内和室外之间的界限，把室外的森林带到室内空间来。在现代三要素墙面、天花和地板之中，顺着室内长轴线和不同感觉的家具安装着老式悬吊照明灯具。其中悬浮在中心的片状照明增加了空间的温暖感和空间感。

吧台坐落在空间的尽头处，提供了私密的氛围和观察咖啡调配师工作的机会。装饰品沿着室内长轴放置，更增添了这里的气氛。