

2011年室内细部年鉴

Interior+Architecture 室内+建筑



# Detail. 4

## 详细

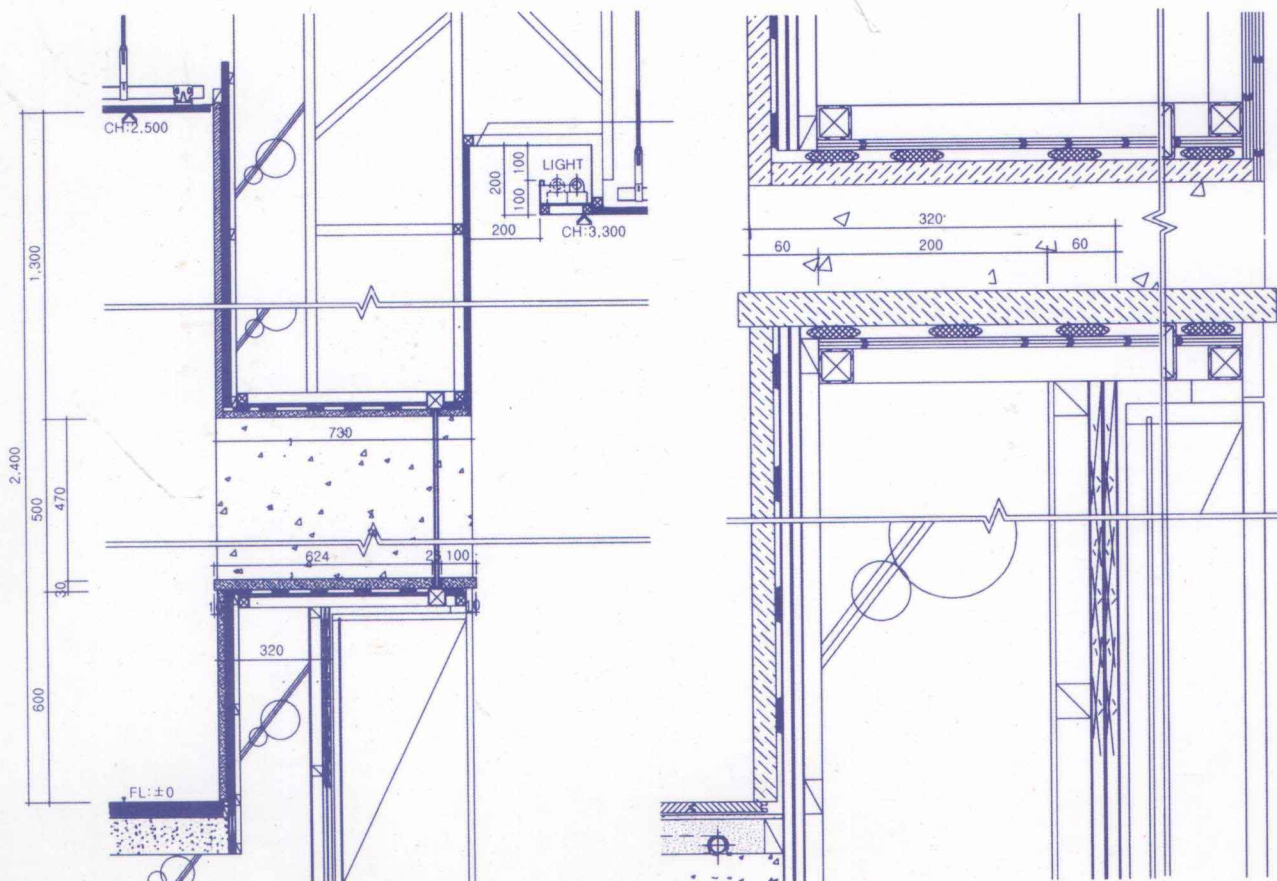

Interior+Architecture 室内+建筑

# Detail<sup>+</sup><sub>4</sub>

# 详细

# 目录

# Contents

## ENTERTAINMENT 娱乐空间

- 006 Superlounge LUV LUV俱乐部
- 018 Sugarcane 甘蔗夜总会
- 026 Aladdin Karaoke 阿拉丁卡拉OK
- 034 Holland Casino 荷兰赌场
- 050 Cinus, Central City 电影院

## SHOP 专卖店

- 064 dressroom Dressroom时装店
- 076 KOLON SPORT CULTURE STATION KOLON运动时装专卖店
- 086 Beautiful Gaze Beautiful Gaze眼镜专卖店
- 092 V NAIL & SPA V美甲及水疗店
- 102 Hairu Hair Treatment Hairu护发廊
- 110 ZURAH ZURAH眼镜专卖店
- 116 C.YUNHEE C. YUNHEE理发店

## HOTEL 酒店

- 124 IP BOUTIQUE HOTEL Ip精品酒店
- 138 Imperial Place Waterpark Resort & Spa, Cebu 皇宫水上度假村
- 164 Hotel Caldor Caldor酒店

## RESIDENCE 住宅

- 174 L's Residence, Cheongdam-dong 清潭洞的L住宅
- 186 Culture Club Lee & Go Lee & Go文化俱乐部
- 198 Moonhori House Moonhori之家
- 210 Uptown Penthouse 住宅区的顶层阁楼
- 218 Yeoksam Raemian Pentaville 在辄三洞的家
- 230 Chou's Apartment Chou的公寓
- 236 CHUNGDO SOLIUM TOWNHOUSE CHUNGDO SOLIUM联排住宅
- 264 Chohyangroo Chohyangroo住宅
- 272 BEAM HOUSE 梁楼
- 278 WRAP HOUSE 变形住宅

Interior+Architecture 室内+建筑

# Detail<sup>+</sup><sub>4</sub>

# 详细

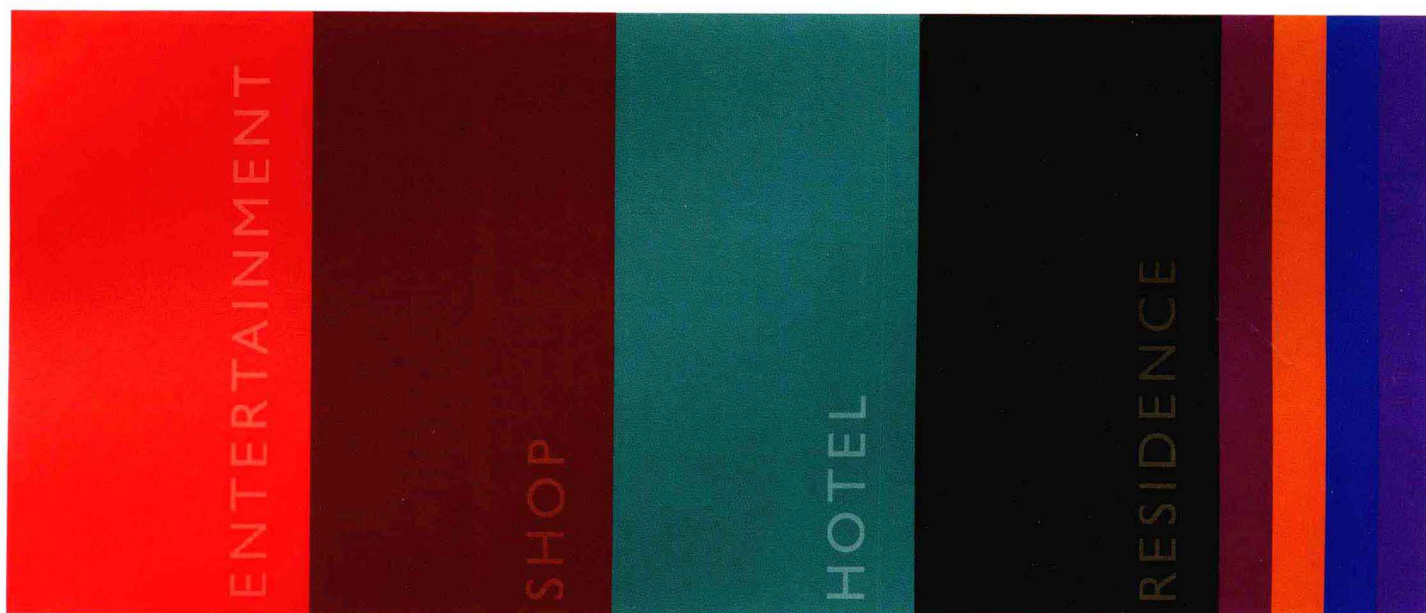

## Detail<sup>+</sup> 4

**Publisher** Jeong Kwangyoung  
**Editor** Choi Jihyun, Ha Jihae, Lydia Kim  
**Designer** Jeong Dongeun, Kwon Taenam

**Publishing** Archiworld Co., Ltd.  
5F Archiworld Bldg., 315-2  
Neung-dong, Gwangjin-gu, Seoul, Korea

**Price** US \$62

© Archiworld Co., Ltd. 2010  
Printed in Korea

# 目录

# Contents

## ENTERTAINMENT 娱乐空间

- 006 Superlounge LUV LUV俱乐部
- 018 Sugarcane 甘蔗夜总会
- 026 Aladdin Karaoke 阿拉丁卡拉OK
- 034 Holland Casino 荷兰赌场
- 050 Cinus, Central City 电影院

## SHOP 专卖店

- 064 dressroom Dressroom时装店
- 076 KOLON SPORT CULTURE STATION KOLON运动时装专卖店
- 086 Beautiful Gaze Beautiful Gaze眼镜专卖店
- 092 V NAIL & SPA V美甲及水疗店
- 102 Hairu Hair Treatment Hairu护发廊
- 110 ZURAH ZURAH眼镜专卖店
- 116 C.YUNHEE C.YUNHEE理发店

## HOTEL 酒店

- 124 IP BOUTIQUE HOTEL Ip精品酒店
- 138 Imperial Place Waterpark Resort & Spa, Cebu 皇宫水上度假村
- 164 Hotel Caldor Caldor酒店

## RESIDENCE 住宅

- 174 L's Residence, Cheongdam-dong 清潭洞的L住宅
- 186 Culture Club Lee & Go Lee & Go文化俱乐部
- 198 Moonhori House Moonhori之家
- 210 Uptown Penthouse 住宅区的顶层阁楼
- 218 Yeoksam Raemian Pentaville 在铎三洞的家
- 230 Chou's Apartment Chou的公寓
- 236 CHUNGDO SOLIUM TOWNHOUSE CHUNGDO SOLIUM联排住宅
- 264 Chohyangroo Chohyangroo住宅
- 272 BEAM HOUSE 梁楼
- 278 WRAP HOUSE 变形住宅

ENTERTAINMENT

娱乐空间

LUV俱乐部

Superlounge LUV

甘蔗夜总会

Sugarcane

阿拉丁卡拉OK

Aladdin Karaoke

荷兰赌场

Holland Casino

Cinus电影院

Cinus, Central City



# Superlounge LUV

## LUV俱乐部

*Design* Kutec

*Location* Itaewon-dong, Yongsan-gu, Seoul, Korea

*Built Area* 264m<sup>2</sup>

*Finish Floor* : Tile, White Epoxy

*Wall* : Tile, Water Paint, Copper Mirror,  
Black Mirror, Steel Sheet, Glass

*Ceiling* : Silicon, Vinyl Paint

*Construction* Teojeon Interior · Bae Sang-ho,  
Jo Gil-jung

设计：Kutec设计工作室

地点：韩国首尔龙山区梨泰院洞

面层材料：地面：瓷砖、白色环氧树脂涂料

墙面：瓷砖、水性涂料、铜镜、黑镜、不锈钢板、玻璃

天花：乳胶漆

施工：Teojeon室内设计工作室，Bae Sang-ho,  
Jo Gil-jung

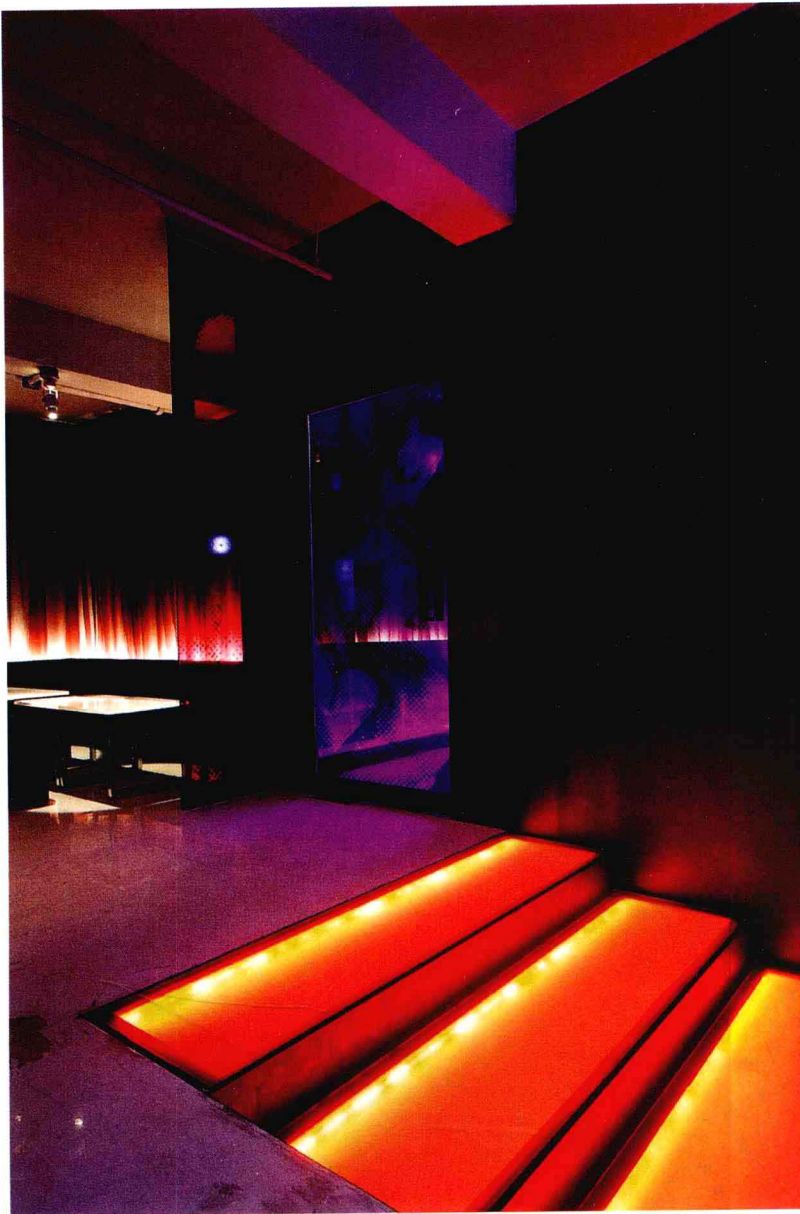

Itaewon, where diverse cultures are mixed, has an open and exotic atmosphere. Making the best of the character of the site, the project was created as a more extrovert club that allows various people gather and have fun together.

Under the keywords such as a 'lounge', 'club' and 'relaxing', a club is viewed from yet another perspective. The designer intended to create a comfortable modern space unlike the existing cold and closed spaces by avoiding complex and luxurious decoration and structure, using a level difference that gives a sense of rhythm. In this way, the space breaks away from the otherwise monotonous atmosphere, and each area harmonizes and communicates with one another through the invisible boundaries of the levels, thus dividing the space by function and at the same time providing an open and animated view. In addition, colorful lightings fill the entire space to emphasize the vital and dynamic image, the identity of the club.

Maintaining both the fancy ambience and the comfortableness, Superlounge LUV will raise a new wave in Itaewon with its trendy space that satisfies the senses of club users.

梨泰院是一个有着多元文化的地区，这里充满着开放的氛围和异国情调。为了突出项目所在的地区特点，设计师设计了一个可提供给不同人一起聚会玩乐的外向型俱乐部。

在休息、俱乐部、放松这几个关键词的引导下，设计师旨在创造和一般封闭、老套的俱乐部不同的现代舒适空间，同时设计师也避免运用复杂、豪华的装饰和复杂的结构，室内不同的地面高度使空间产生韵律感。在这样的情况下，这个俱乐部显得和其他单调的俱乐部不一样，空间和空间之间可以互相交流并且非常和谐。功能分区是由地面不同的高差来完成的，另外，彩色的灯光使空间看起来非常完整，同时强调了空间中的重点区域和俱乐部的特色。

同时拥有奇特氛围和舒适感的LUV俱乐部将会用它时尚的空间来引领梨泰院的俱乐部设计。

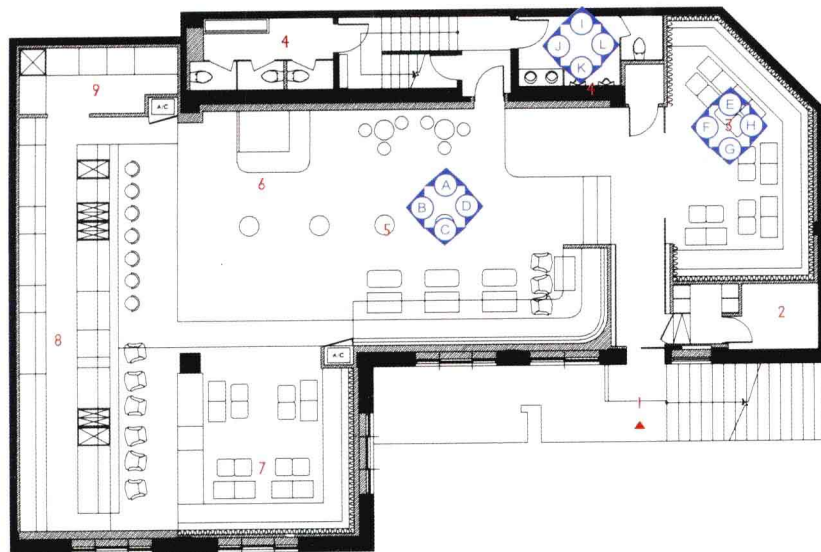
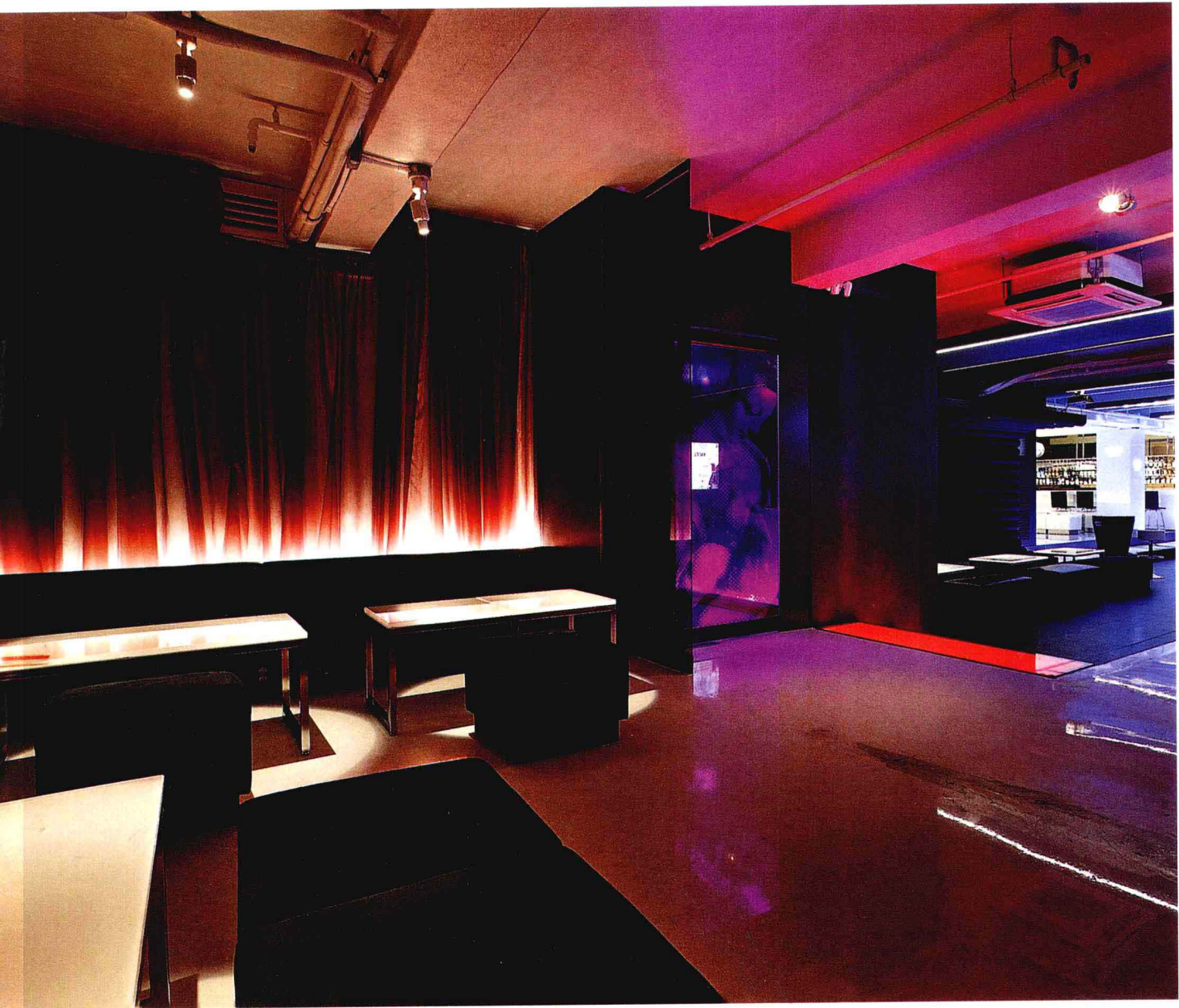

- |             |       |
|-------------|-------|
| 1. Entrance | 1.入口  |
| 2. Office   | 2.办公室 |
| 3. Room     | 3.包房  |
| 4. Toilet   | 4.洗手间 |
| 5. Hall     | 5.大厅  |
| 6. DJ Booth | 6.DJ台 |
| 7. Lounge   | 7.休息区 |
| 8. Bar      | 8.吧台  |
| 9. Kitchen  | 9.厨房  |



Floor plan 平面图



■ Hall & Bar 大厅及吧台

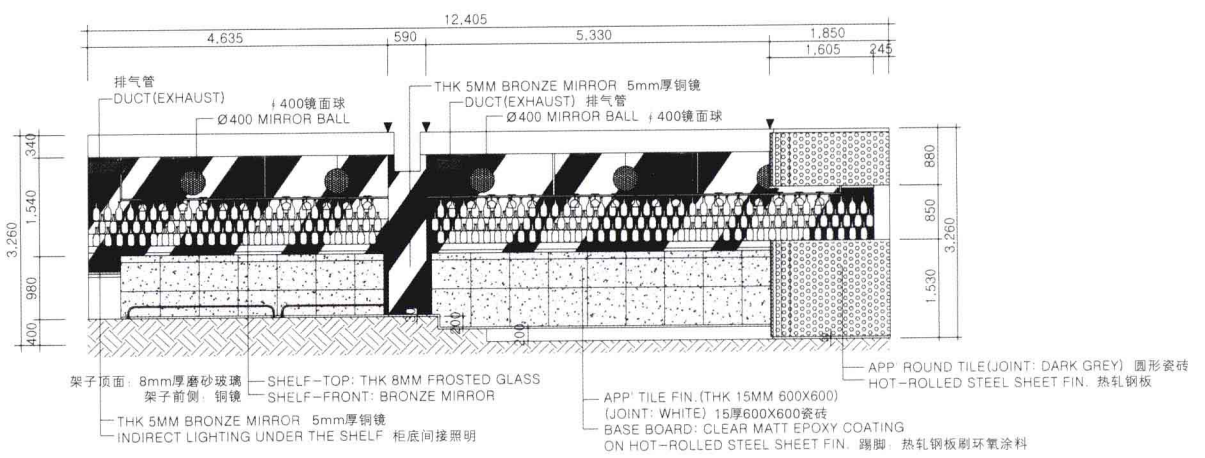
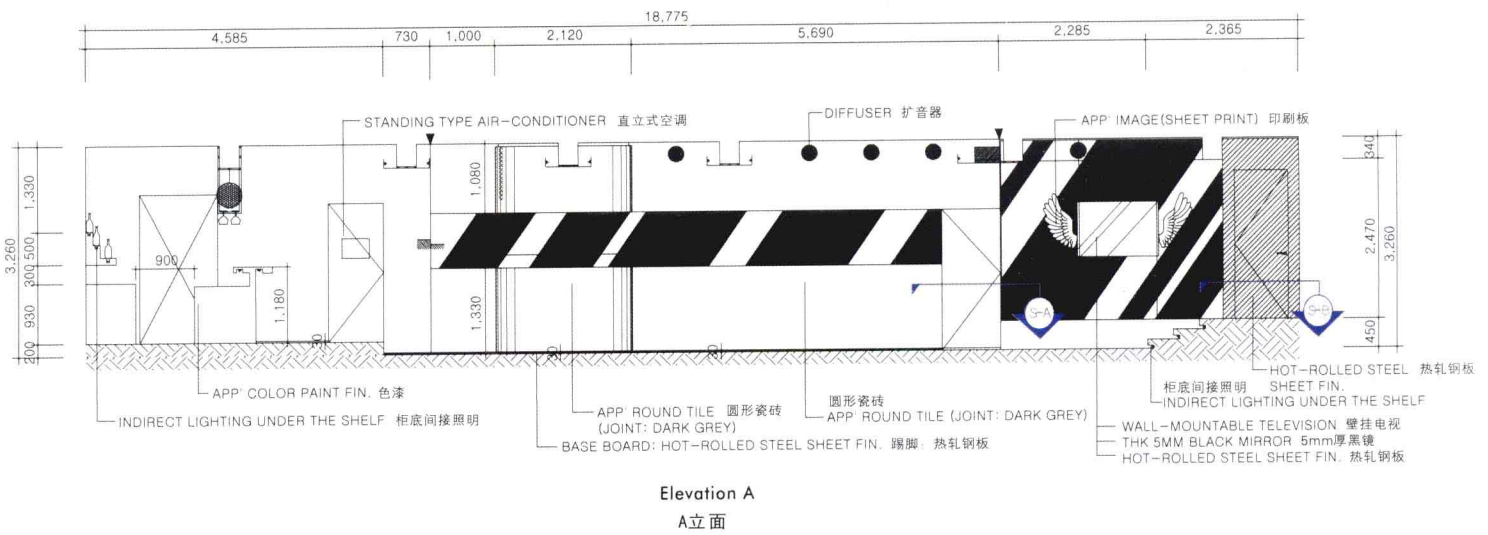

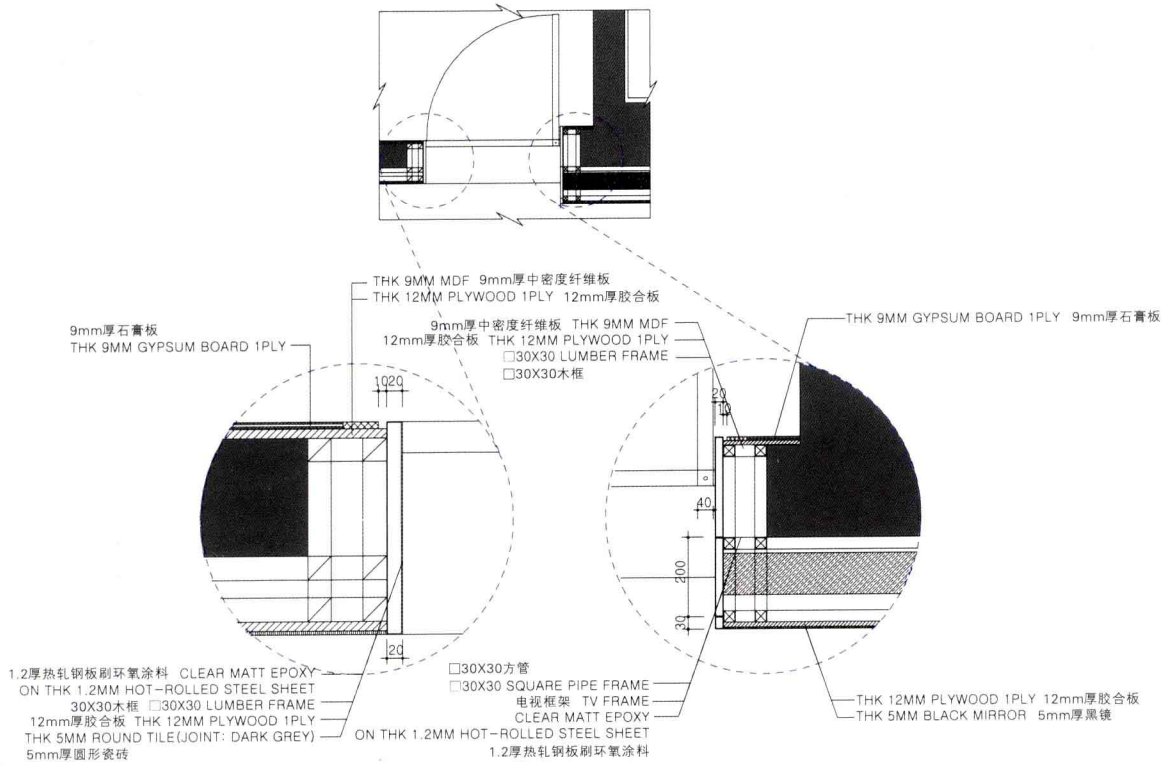

Section A  
A剖面

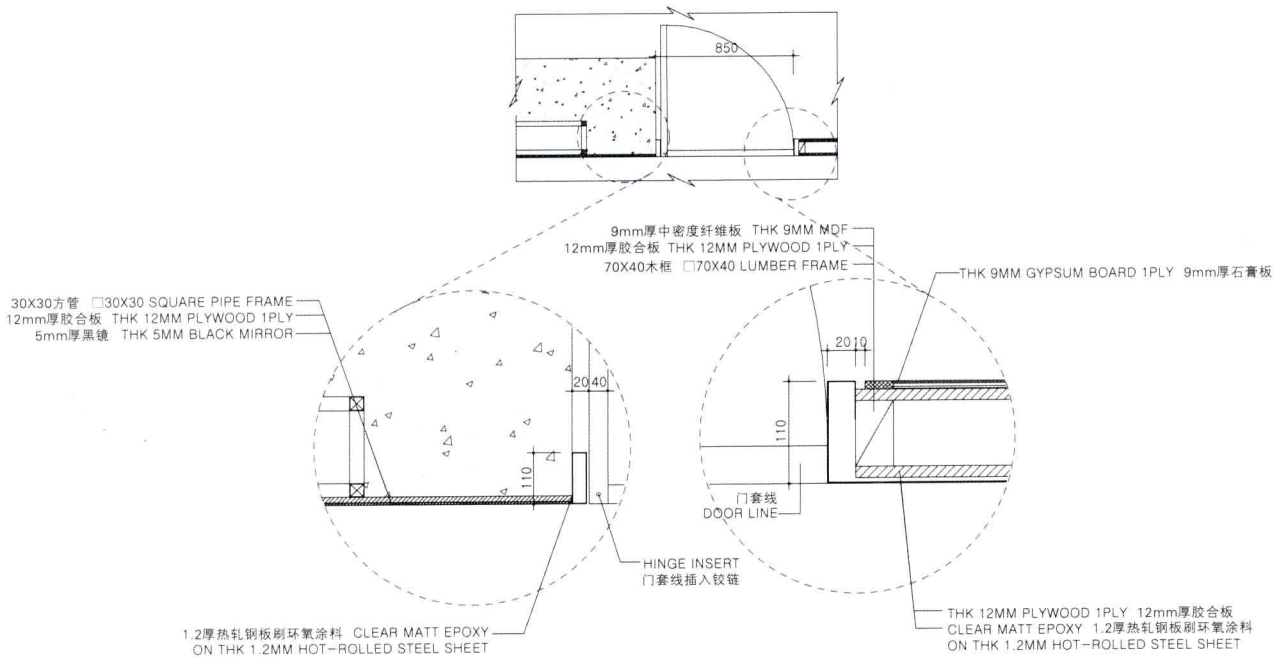

Section B  
B剖面

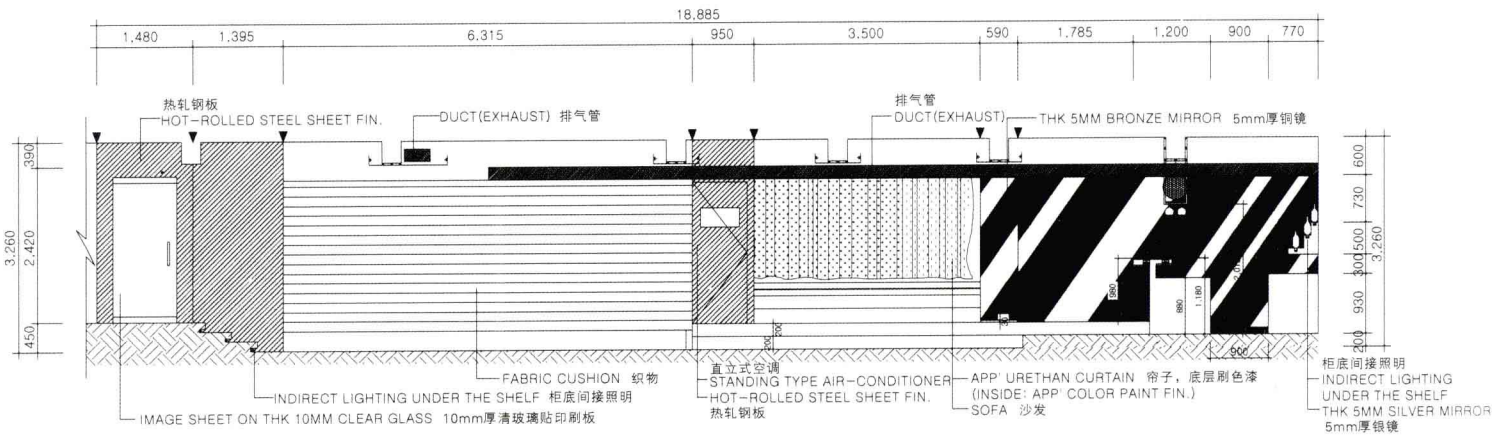

Elevation C  
C立面

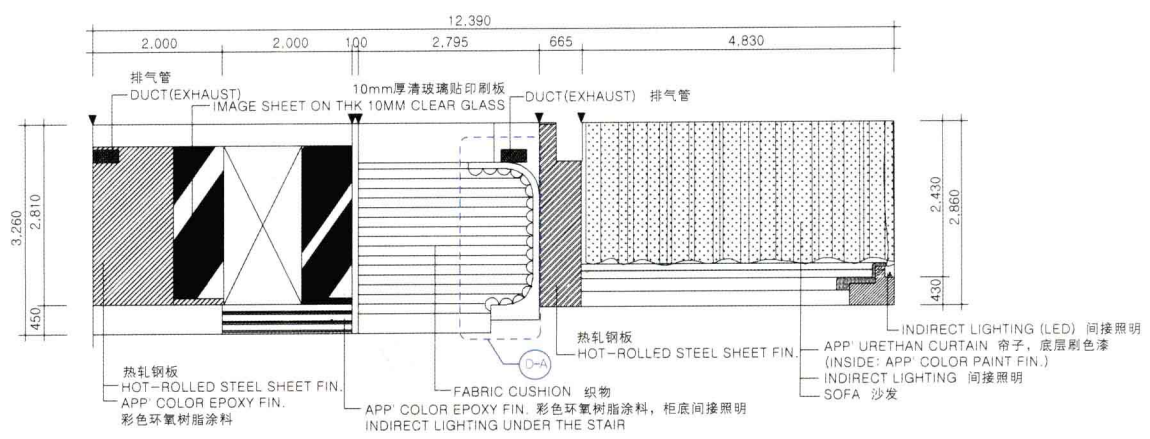

Elevation D  
D立面

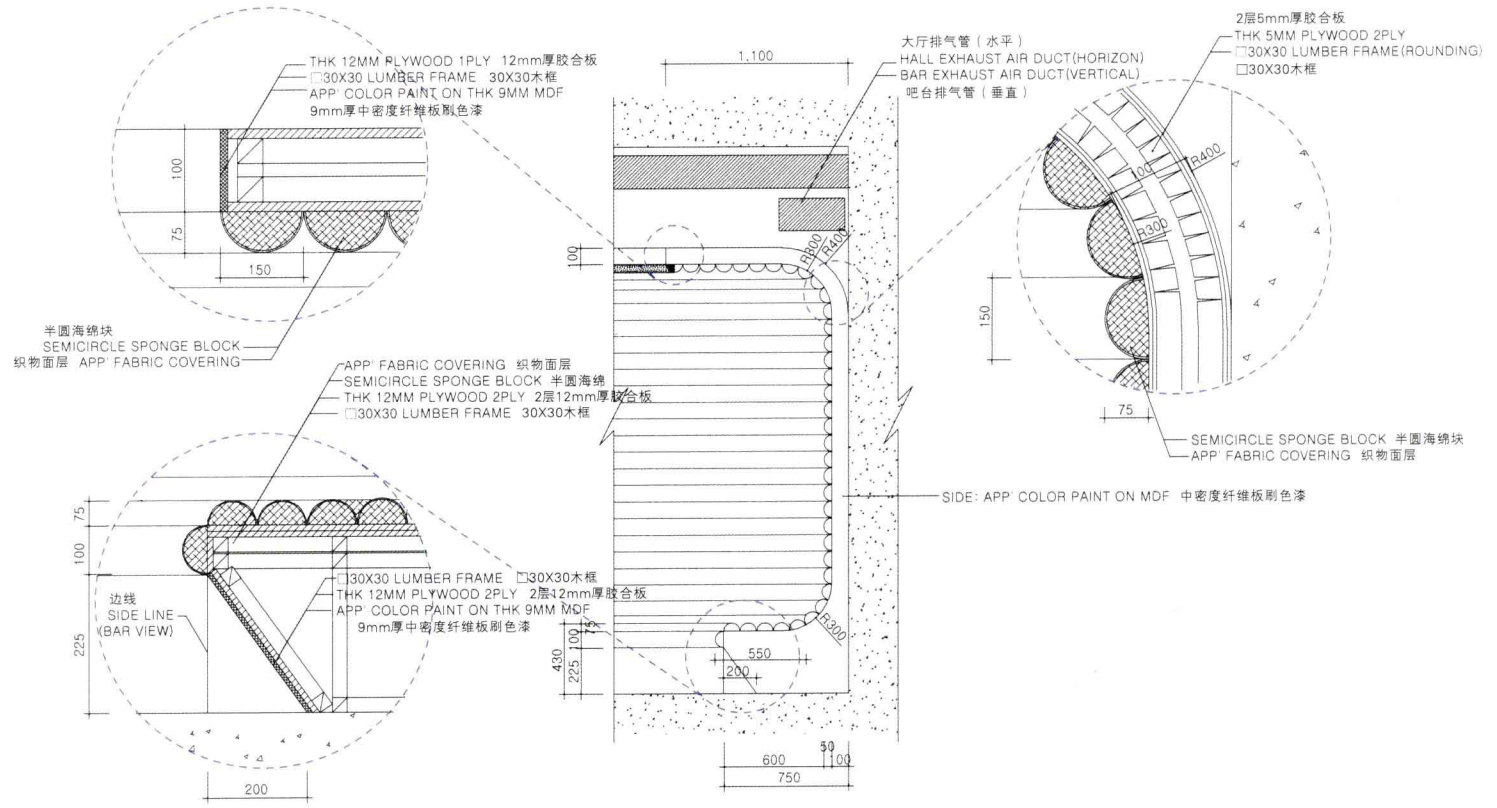

Detail A A大样

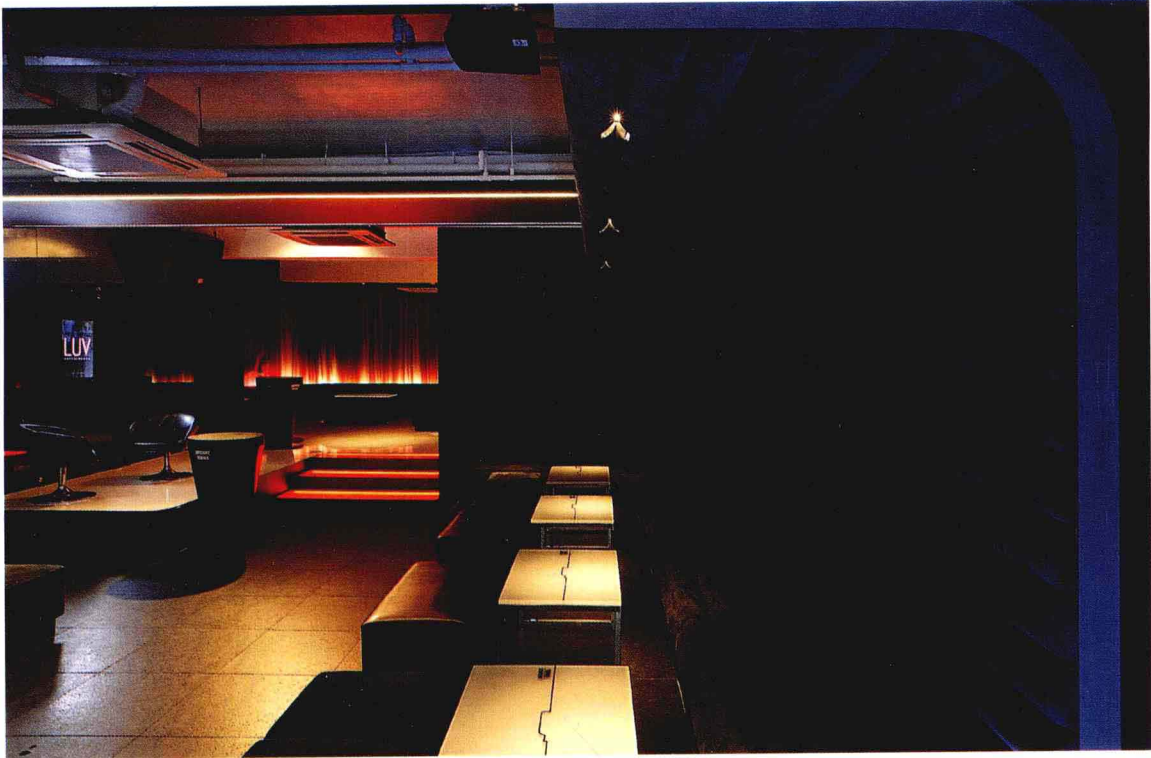



■ Room 包间

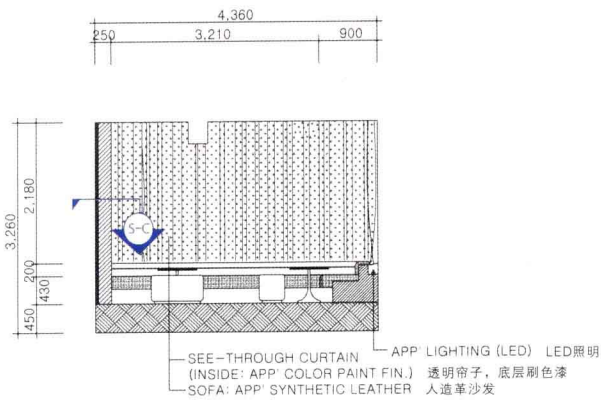

Elevation E  
E立面

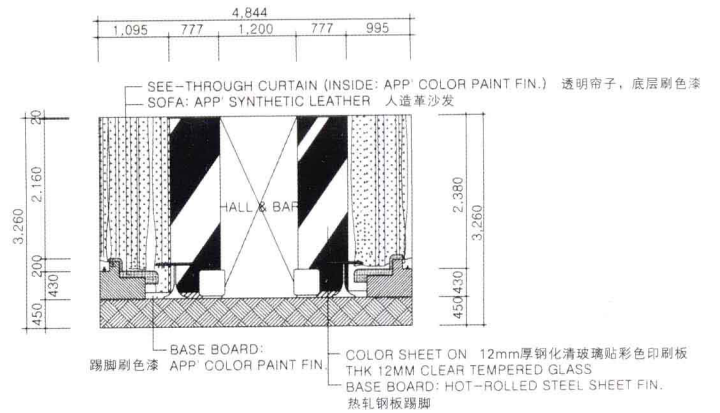

Elevation F  
F立面

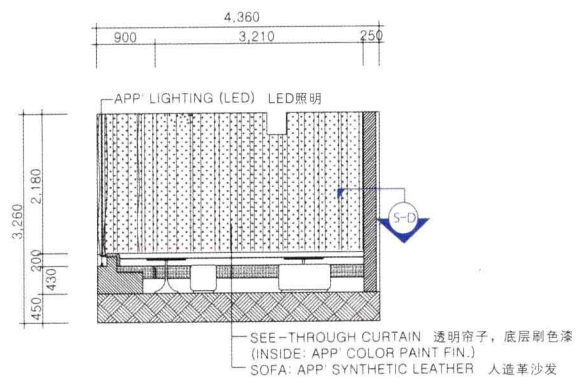

Elevation G  
G立面

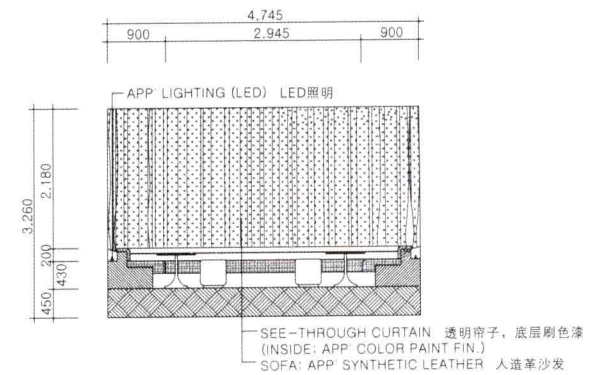

Elevation H  
H立面

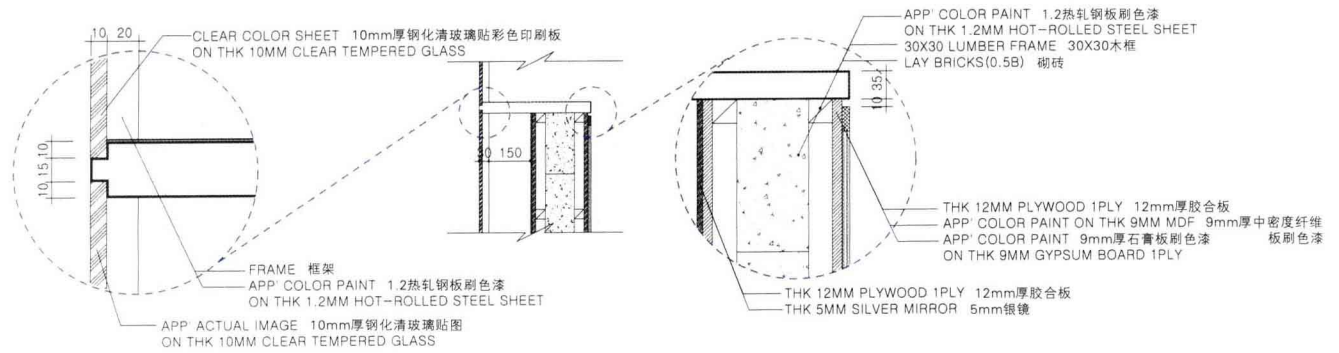
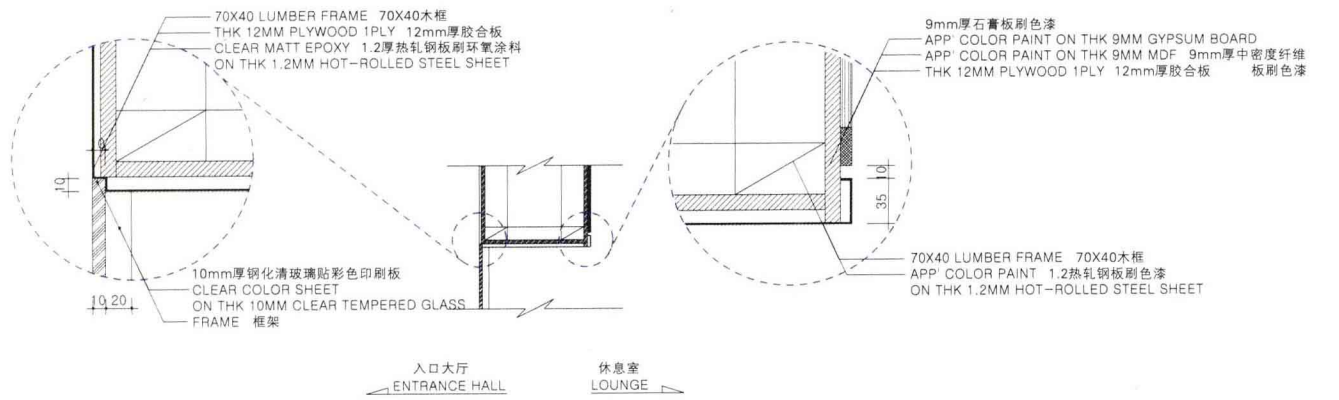

Section C  
C剖面

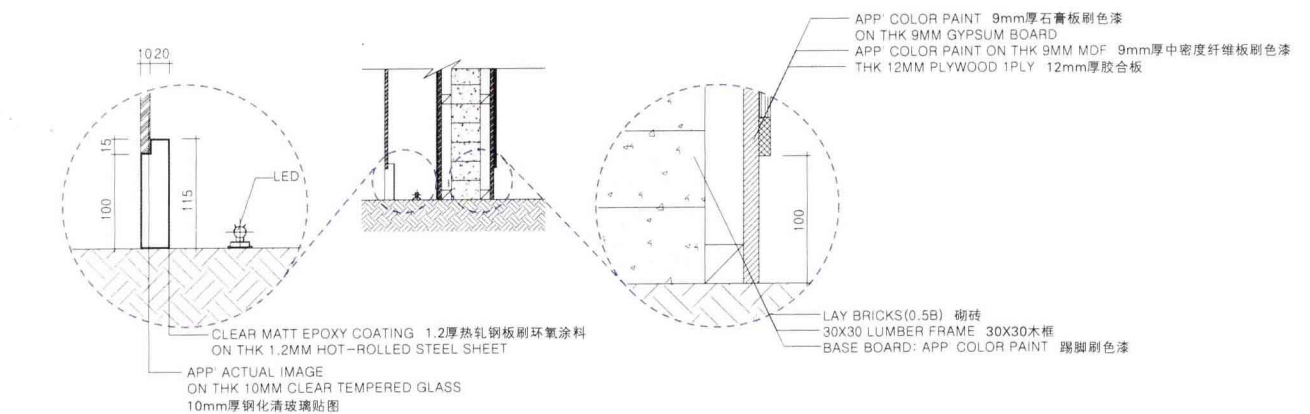
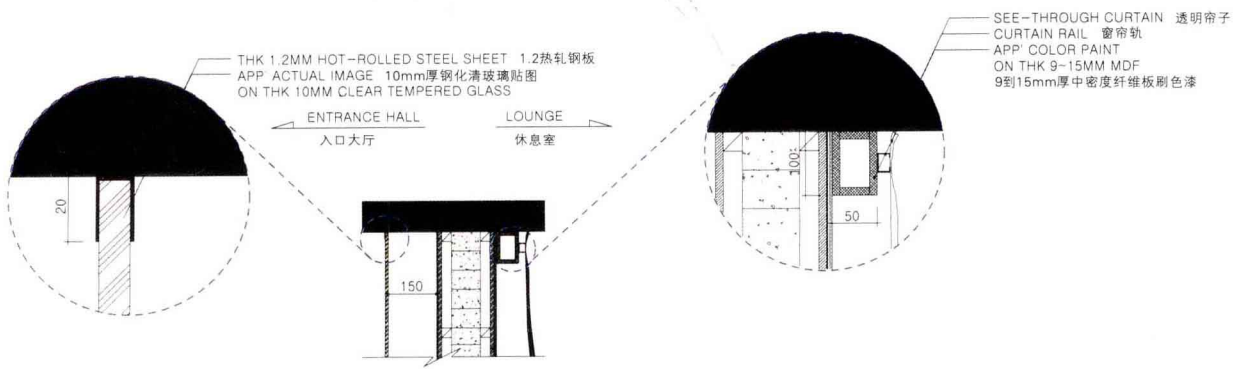

Section D  
D剖面





■ Bar ceiling 吧台天花

